



**FORETRAVEL**  
**MOTORCOACH**



**2019 ih-45**  
**PRODUCT GUIDE**

Since 1967, Foretravel Motorcoach has been committed to bringing you the finest luxury coach in the industry.

A coach of exquisite craftsmanship, luxury and choice, the 2019 ih-45 is set to be a powerhouse in the market. Through the combined expertise of Foretravel and Spartan, the TravelRide III chassis was exclusively designed, delivering an unrivaled drive and handling experience. The exterior seamlessly flows into the interior offering subtle individual details that make a bold statement.

Foretravel's dedicated design team will assist you in personalizing an ih-45 of your dreams, offering individuality and design statements no other customer has chosen.

Foretravel of Texas is committed to sharing our passion through an unforgettable experience. No other motorcoach company compares to our signature craftsmanship, superior ride and handling, and exceptional customer service.







# CUSTOM INTERIORS





# KITCHENS



 **FORETRAVEL**  
MOTORCOACH  
**BATHROOMS**





**SPECIALTY / LIVABILITY**





# FORETRAVEL ih-45 2019 Standard Features

MOTORCOACH

## CAPACITIES AND MEASUREMENTS

- Fresh Water 135 gal
- Holding Tank 145 gal
- Fuel 200 gal
- DEF 15 gal
- Height 13'2" – top of roof a/c's

## Travelride III Chassis Premium Features:

- "Premier Steer" Steering Assist System
- Suspended Adjustable Pedals
- SMART Steering Wheel with Wood Grain & Leather and Integrated Radio Controls
- Electronic Suspension Control System with Self-Leveling Feature
- Tag Axle with Independent Suspension
- Spartan AC4-20 drive suspension with outboard mounted air springs
- Cummins Connected Diagnostics™
- Spartan Digital Instrument Panel
- 20,000 lb Towing Capacity
- 3-Year / 50,000-Mile Warranty: No Deductible, 24/7 Roadside Assistance

Travelride III chassis is exclusively available on the Foretravel ih-45.



## Spartan Advanced Protection System:

- Collision Mitigation System with Adaptive Cruise Control
- Electronic Stability Control
- Automatic Traction Control
- Spartan Safe Haul™ (industry's only factory-chassis integrated air supply for tow vehicle brake systems)

## Specifications:

### Engine

Cummins X15  
 18.7 CFM Air Compressor  
 1500 Watt Block Heater  
 Peak HP: 605 hp @ 1800 RPM  
 Peak Torque: 1950 lb-ft @ 1200 RPM

### Transmission

Allison 4000MH 6-Speed  
 Push-Button Shift Pad  
 Allison Fuel Sense  
 Shift Inhibit

### Chassis Ratings

GVWR: 54,000 lb  
 Front GAWR: 20,000 lb  
 Rear GAWR: 20,000 lb  
 Tag GAWR: 14,000 lb  
 GCWR: 74,000 lb

### Suspension

Front: Reyco Granning IFS2000S3 with anti-sway bar  
 Rear: Spartan AC4-20  
 Tag: Ridewell RIA 207

### Bilstein Shocks

Front: 60mm  
 Rear: 46mm  
 Tag: 46mm

### Brakes

ABS: WABCO 6S/6M Brake  
 Front: Air Disc  
 Drive: Air Disc  
 Tag: Air Disc  
 Parking: Push/Pull Knob, Brake Interlock

Auxiliary: Engine compression brake with 4 position lever

### Steering

VIP Wood Grain & Leather Smart Wheel with Integrated Radio Controls  
 Column: Power Tilt and Telescoping

### Fuel System

Fuel Tank: 200 gallon with dual side fill  
 DEF Tank: 15 gallon, dual fill

### Electrical System

Custom Modular 12v Electrical System  
 Batteries: Two 950 CCA  
 Alternator: 350-amp Leece-Neville

### Cooling System

Side-Mounted Radiator:  
 Parallel Air Flow System with Low-Profile Radiator, Charge Air Cooler and Integrated A/C Condenser Utilizing a Modulated Engine-Driven Cooling Fan

### Frame

Trussed, Torque-Box Structured Frame Design for Frame Strength, Reduced Camber and Improved Storage Capacity  
 Front: 14.25" x 3.5" x .31"  
 Rear (Rail): 12.75" x 3.5" x .31"  
 Rear (Drop): 10" x 3.5" x .38"

### Tires

Front: Michelin XZA 365/70R22.5 LRL  
 Rear: Michelin X Line Energy Z 315/80R22.5 LRL  
 Tag: Michelin X Line Energy Z 315/80R22.5 LRL

### Wheels

(6) Alcoa Dura-Bright Aluminum Wheels with Dress Kit  
 (2) Aluminum Wheels on Inside Dual Wheels

### Wheelbase

318.5"

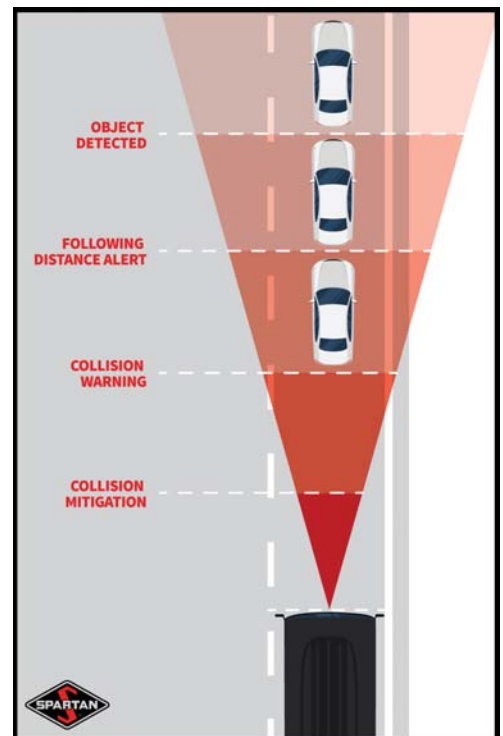



## EXTERIOR FEATURES

Awning-PS, roof-mounted, electric patio w/ lights (2)  
Awning-DS, roof mounted, shells w/lights (2)  
Topper Awnings on Slideouts-painted to match  
Auto motion sense storage bay lights  
Cargo tray, electric sliding (2)  
Freezer in bay on slide out tray  
Carpeted storage bays  
Consolidated components bay  
Docking lights, LED (4) with switch in dash & bedroom  
Dual-pane tinted & insulated windows

Easy view one-piece windshield  
Electric entry step (Executive)  
CosmoLite roof – One Piece, Stain and UV resistant  
FRP sub floor (one-piece)  
Fog lights, LED  
Duel Fuel / DEF fill locations  
Color changing ground accent lighting  
LED high beam headlamps  
Xenon low beam headlights  
Heated/remote chrome mirrors w/LED turn signals

Fresh water plumbing supply manifold  
Marker lights, LED  
Paint protection below windshield – Armor Coat  
Painted exterior, full body paint w/ clear coat finish  
Side hinge storage doors with remote electric door locks  
LED Porch light  
Roof AC drains  
Trailer wiring – 7 pin connector

### Utility Station:

50 amp. shoreline connection	Fresh water connection	Soap dispenser	Stainless steel lined utility bay
Network connection	Water fill switch	Water pump switch, Cable	Hot & cold water faucet
120v receptacle	TV & Portable satellite connection	Tank level indicator	Flush kit
Electric utility reels - water & power	Electric dump valve	Electric gray water bypass for holding tank	

## DASH & COCKPIT FEATURES

### Accent lighting under dash at pilot chair - dimmable

### Illuminated cup holders at pilot and copilot

### Magazine rack and assist handle include phone storage and charging port

### Padded dash top

12 volt accessory receptacle  
Dual 1 amp USB charge receptacle  
Battery boost switch / auto-charge  
Dedicated driver monitor for rear and side cameras, side & 360 view cameras  
CB at dash, hand held  
Co-pilot seat, Villa residential 6 way power w/footrest & headrest  
Dash AC fan controls for co-pilot

Generator auto start/stop  
Infotainment system with GPS, AM, FM, CD Sirius/XM, Bluetooth, USB, and iPod compatibility  
Passenger touch screen monitor with DVD and GPS  
Map lights, pilot & copilot  
Pedals, throttle & brake power adjust  
Pilot seat, Knoedler air ride  
Silverleaf 12" digital glass dash  
Steering wheel: Power tilt & telescoping Smart Wheel, w/Radio Controls  
Windshield / privacy shade & sunblock, electric

### Cameras: 9 Total

Total vision motorized back-up	Side mounted in mirrors integrated w/blinkers
4 parameter for Birds eye view	Forward facing and interior

## APPLIANCES • ELECTRONICS • LIGHTING • AUDIO-VIDEO

### Microwave, GE, Advantium Convection

### Refrigerator, GE, Café series w/built in

#### Keurig K cup

### Head hunter 120V water pump

HDMI & CAT6 shielded A/V cabling  
CAT6 network cabling  
Cook top, 2-burner Induction – recessed with covers  
5.1 surround sound system in LR

Stereo sound system in BR and Patio  
Single Blu-ray player  
Universal Remote Control (2)  
iPad with Crestron integration for AV as well as Silverleaf controls  
Stationary HD Satellite with HD DVR receiver and 2nd HD receiver  
Silverleaf Total Coach Control panel

Road-iQ camera system  
Tire Pressure Sensors displayed @ dash  
TV antenna – automatic domed Winegard Rayzar 4G LTE  
Washer/dryer connections  
Interior LED Lighting:  
Accent under counters & window trim  
Accent on Entry Door Panel  
Floor lights and reading lamps in bedroom  
Dimmable

## INTERIOR LIVABILITY FEATURES

### Large corner mounted TV's with storage behind

### Decorative wall in large floor to ceiling potty wall

### Kitchen utility drawer

Powered step-well cover with two switch locations  
Color-coordinated Foretravel Designed throw pillows (sofa & bed)  
Foretravel Designed window treatment w/ electric day/night shades

Electric exhaust fan in bath & toilet room w/auto rain sensor  
Filter, drinking water & ice maker water  
Floor Heat, electric (with approved flooring)  
120v outlet w/dual USB charge ports in LR and BR  
Kitchen pantry  
Lighting, multiplex system  
King Bed – Slumber Ease System

Slide-out rooms, flush w/ sidewalls when retracted and pneumatic sealed  
Natural Quartz countertops  
Stainless steel kitchen sink w/covers  
Kitchen pull-out top  
Body sprayer in shower  
Tile floor (kit, bath, D & P area)  
Built in vacuum with toe kick and hose connection  
Wood, handcrafted Walnut or African Mahogany cabinetry

## SAFETY FEATURES

### Spartan Advanced Protection System

### Safe behind large corner mounted TV

All coaches built to RVIA specifications  
Tyron® Bead-Lock Tire Blowout Protection (front tires)  
Fog-Maker Engine Fire Suppression System  
Vorad Blind Spot Monitor

Auto headlights and wipers  
Carbon monoxide detector  
Daytime running lights  
Fire extinguishers (2)  
GFI protected circuits  
Illuminated entry-door assist handle

Rear exit door  
Bird's Eye View 360 camera system  
Road IQ 5 camera system with integrated hard drive  
Electronic Safe  
Security system  
Smoke detector  
CSA Approved / Transport Canada Approved

## HEATING • COOLING • ELECTRICAL

12.5 kw diesel generator in quiet box  
12 volt battery disconnect  
2800 w inverter/charger (2) w/integrated AC/DC surge protectors  
50 amp shoreline connection

Air conditioning & heating with offset returns for superior quiet operation  
Air-conditioning, ducted with 4 roof airs  
15,000 BTU's with heat pumps  
Auto temp. start for generator

Low-battery generator auto-start  
50 amp automatic transfer switch with integrated surge suppression 2010  
Electrical surge-suppression system  
Aqua Hot Hydronic heating 600D

## OPTIONS

Cabinetry, Wood, Walnut or African Mahogany	Dish Drawer	Entry Door Awning	320w Solar Package
Cabinetry, Laminate	Wine Chiller	Electric Window Awnings	Fire Proof Safe
Outdoor Entertainment pkg in slide room	Trash Compactor	Patio Awnings on driver side	Outdoor grill on tray
In motion SD satellite dish	Ottoman	Paint graphics through patio awnings	Safe behind large corner mounted TV
Second Silverleaf Panel in Bedroom	Washer dryer, combination or stacked	Stainless Accent Package	
Hammered Kitchen Sink	Single bowl kitchen sink	Armor Coat above windshield	

**BOLD denotes New 2019 Features**

Foretravel, Inc. reserves the right to change or correct product specifications/pricing at any time without incurring obligations.



# OUTDOOR LIVING AND *Design Studio*



iPad integration for TV's, shades, lights and house functions.



# POPULAR CUSTOM DESIGNED ih-45 FLOORPLANS

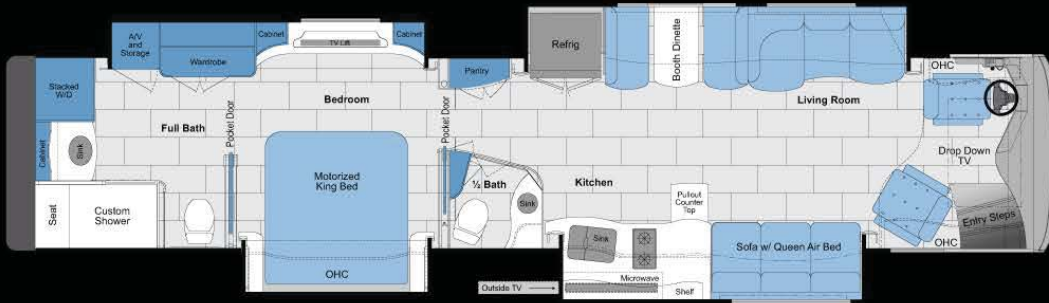



# ih-45



**FORETRAVEL**  
MOTORCOACH

1221 NW Stallings Drive | Nacogdoches, Texas 75964  
800.955.6226 | [www.foretravel.com](http://www.foretravel.com)



Foretravel, Inc. reserves the right to change or correct product specifications/pricing at any time without incurring obligations.