

# Table of Contents

- 1991 Foretravel Specifications** ..... 3
  - Brochures** ..... 3
  - Photos** ..... 7
- Specifications** ..... 10
  - 1991 Grand Villa U300** ..... 10
    - Models & Codes ..... 10
  - Features** ..... 11
    - WEIGHTS/RATINGS ..... 11
    - AUTOMOTIVE ..... 11
    - LIVABILITY ..... 12
    - ELECTRICAL ..... 13
    - SAFETY ..... 13
    - HEATING/COOLING ..... 14
    - CONVENIENCE ..... 14
  - 1991 Grand Villa U280** ..... 15
    - Models & Codes ..... 15
  - Features** ..... 15
    - WEIGHTS/RATINGS ..... 15
    - AUTOMOTIVE ..... 15
    - LIVABILITY ..... 16
    - ELECTRICAL ..... 17
    - SAFETY ..... 17
    - HEATING/COOLING ..... 18
    - CONVENIENCE ..... 18
  - 1991 Grand Villa U225** ..... 19
    - Models & Codes ..... 19
  - Features** ..... 19
    - WEIGHTS/RATINGS ..... 19
    - AUTOMOTIVE ..... 19
    - LIVABILITY ..... 20
    - ELECTRICAL ..... 21
    - SAFETY ..... 21
    - HEATING/COOLING ..... 22
    - CONVENIENCE ..... 22
  - 1991 OREG Grand Villa 3400, 3600** ..... 22
    - Models & Codes ..... 22
  - Features** ..... 23
    - WEIGHTS/RATINGS ..... 23
    - AUTOMOTIVE ..... 23
    - LIVABILITY ..... 24
    - ELECTRICAL ..... 25
    - SAFETY ..... 25
    - HEATING/COOLING ..... 25
    - CONVENIENCE ..... 26
    - OPTIONS ..... 26
  - 1991 ORED Grand Villa 3400, 3600** ..... 27
    - Models & Codes ..... 27
  - Features** ..... 28
    - WEIGHTS/RATINGS ..... 28
    - AUTOMOTIVE ..... 28

LIVABILITY .....	29
ELECTRICAL .....	30
SAFETY .....	30
HEATING/COOLING .....	30
CONVENIENCE .....	31
OPTIONS .....	31

# 1991 Foretravel Specifications

Specifications, Brochures, Floor Plans & Photos

- [1991 Grand Villa U300 Specifications](#)
- [1991 Grand Villa U280 Specifications](#)
- [1991 Grand Villa U225 Specifications](#)
- [1991 OREG Grand Villa 3400, 3600 Specifications](#)
- [1991 ORED Grand Villa 3400, 3600 Specifications](#)

## Brochures



- Plastic bumpers were used in the 1991 U300 (1/4" thick), unique to this year.
- Introduced the U225, a downsized Unihome with an innovative suspension called the Velvet-Ride Torsilastic Suspension System. The suspension was from BFGoodrich made especially for Foretravel.
- Was the last year of 8' wide Unihomes (U280, U300)

[1991 U300 Options Flyer](#)

[1991 U280 Options Flyer](#)

[1991 U225 Options Flyer](#)

[1991 ORED Options Flyer](#)

[1991 OREG Options Flyer](#)

**Foretravel, inc.**  
MICRO-CAMPS OF DISTINCTION

**3400 & 3600 SERIES GRAND VILLA**  
R15D Rear Engine Diesel

BASE: 21,000 P.L.A.S.  
40 = 6000 GAL. TWIN BURN  
80 = 8000 GAL. TWIN BURN  
80R = 8000 GAL. TWIN BURN DIESEL  
80R1 = 8000 GAL. TWIN BURN DIESEL (DINETTE)

**STANDARD EQUIPMENT**

**Automotive**  
100 gallon fuel tank  
(3) 300 Amp. four batteries  
2 engine starters (4000)  
WC (2) 12V battery (8000) (4000) (8000)  
Advance AT&T transmission  
Battery isolator  
Cruise control  
Diesel 8.25 V6 engine (210 hp)  
Dry air cleaner  
Dual electric wipers & washers  
Engine compartment light  
Fuel 100 VPI engine  
Full air conditioning  
Halogen headlights  
Heavy duty alternator  
Heavy duty radiator  
Over power alarm & disconnect switch  
Outboard 1-457 20,000 P.W.R. (4000)  
Partial automatic type tank with  
swing-up top for easy service  
Padded seat covers  
Power air brakes  
Power steering  
Rearview and wing mirrors  
Transmission oil cooler

**Safety**  
Back-up beeper  
Back-up lights  
Emergency exit side windows  
Emergency flares  
Emergency blanket  
Emergency first aid kit  
Fire extinguisher  
Flare gun  
Flare kit  
Flare storage  
Large outside mirrors with wide angle  
view, turn signals  
LP gas fuel (8000)  
Park lights  
Rearview side mirror  
Self-venting overhead night light  
Smoke detector  
Storage with aluminum roof (8000)  
Tandem safety glass  
Warning triangle reflective kit

**Liability**  
1-107 Motor Specimens & Inclusions  
No. 12 Tank (40)  
40 Inclusion (80) with generator heater  
(4) standard (80) tank

**Electrical**  
130 volt automatic emergency  
130 volt motor & generator motor  
30 Amp. circuit breaker  
10 A.C. generator  
70 Amp. automatic charger  
Master battery disconnect switch  
Trailer wiring

**Heating/Cooling**  
(2) Dometic furnace with automatic  
ignition (2400 & 3000 BTU)  
12,000 BTU warm AC  
(2) 12,000 BTU cool AC with heat strips  
heat strips

**Convenience**  
300 lb. LP gas tank  
40 and 60 gallon water tanks (3000)  
60 and 70 gallon waste tanks (3000)  
TV antenna height  
80 gallon motor capacity  
1 gallon pre-charged motor accumulator  
Antenna warning  
Battery house switch  
Completely bonded dump hose &  
valve  
Dual electric tongue brake  
Electric system monitor  
Electric 12V water  
Close box  
Large interior storage  
LP gas monitor  
LP gas sensor  
Map lights for pilot & copilot  
Pilot & copilot shared hot water  
Remote start/light  
Roof mounted rack and locker  
Telephone jack

MODEL	MSRP	WHEEL BASE	RETAIL
3400	284*		\$151,500.00
3600	228*		\$195,000.00

\* Model number denotes approx. length

Price, specifications, descriptions and illustrations in this document are subject to change without notice.  
©1991 Model Price List effective 12/29/90 3/1/91

1991 OREG Specifications

**Foretravel, inc.**  
MICRO-CAMPS OF DISTINCTION

**3400 & 3600 SERIES GRAND VILLA**  
Rear Engine Gas

BASE: 21,000 P.L.A.S.  
40 = 6000 GAL. TWIN BURN  
80 = 8000 GAL. TWIN BURN  
80R = 8000 GAL. TWIN BURN DIESEL  
80R1 = 8000 GAL. TWIN BURN DIESEL (DINETTE)

**STANDARD EQUIPMENT**

**Automotive**  
100 gallon fuel tank  
2 engine starters (4000)  
30 Amp. four battery (4000)  
WC (2) 12V battery (8000) (4000) (8000)  
Advance AT&T transmission  
Battery isolator  
Cruise control  
(3) 300 amp  
Dual electric wipers & washers  
Engine compartment light  
Fuel 100 VPI engine  
Fuel 100 VPI engine  
Full air conditioning  
Halogen headlights  
Heavy duty alternator  
Heavy duty radiator  
Over power alarm & disconnect switch  
Outboard 1-457 20,000 P.W.R. (4000)  
Partial automatic type tank with  
swing-up top for easy service  
Padded seat covers  
Power air brakes  
Power steering  
Rearview mirror  
Rearview and wing mirrors  
Transmission oil cooler

**Safety**  
Back-up beeper  
Back-up lights  
Emergency exit side windows  
Emergency flares  
Emergency blanket  
Emergency first aid kit  
Fire extinguisher  
Flare gun  
Flare kit  
Flare storage  
Large outside mirrors with wide angle  
view, turn signals  
LP gas fuel (8000)  
Park lights  
Rearview side mirror  
Self-venting overhead night light  
Smoke detector  
Storage with aluminum roof (8000)  
Tandem safety glass  
Warning triangle reflective kit

**Liability**  
1-107 Motor Specimens & Inclusions  
No. 12 Tank (40)  
40 Inclusion (80) with generator heater  
(4) standard (80) tank

**Electrical**  
130 volt automatic emergency  
130 volt motor & generator motor  
30 Amp. circuit breaker  
10 A.C. generator  
70 Amp. automatic charger  
Master battery disconnect switch  
Trailer wiring

**Heating/Cooling**  
(2) Dometic furnace with automatic  
ignition (2400 & 3000 BTU)  
12,000 BTU warm AC  
(2) 12,000 BTU cool AC with  
heat strips

**Convenience**  
300 lb. LP gas tank  
40 and 60 gallon water tanks (3000)  
60 and 70 gallon waste tanks (3000)  
TV antenna height  
80 gallon motor capacity  
1 gallon pre-charged motor accumulator  
40 LP motor watch  
Antenna warning  
Battery house switch  
Completely bonded dump hose &  
valve  
Dual electric tongue brake  
Electric system monitor  
Electric 12V water  
Close box  
Large interior storage  
LP gas monitor  
LP gas sensor  
Map lights for pilot & copilot  
Pilot & copilot shared hot water  
Remote start/light  
Roof mounted rack and locker  
Telephone jack

MODEL	MSRP	WHEEL BASE	RETAIL
3400	284*		\$143,000.00
3600	228*		\$148,500.00

\* Model number denotes approx. length

Price, specifications, descriptions and illustrations in this document are subject to change without notice.  
©1991 Model Price List effective 12/29/90 3/1/91

1991 OREG Specifications

**Foretravel, inc.**  
MICROHOMES OF DETECTION

### 3600 SERIES GRAND VILLA UNIHOME U225

BASIC FLOOR PLAN 36  
36 - SEW BATH, TWIN BEDS  
36L - SEW BATH, ISLAND BED  
36R - SEW BATH, ISLAND BED, BWHETTE

**STANDARD EQUIPMENT**

**Aerodynamics**  
17.000 amp. bow heater  
Vulco 50000 Fuel/air filter  
30 gallon fuel tank  
30 amp alternator  
30 amp battery isolator  
2 7 amp remote bank  
270000 22.5 F/GCA. 16.000 lb. tow  
Air brake  
Air line for tow service  
Allison MT 60 transmission  
Compu-COOL 220 HP  
Cruise control  
50 psi air shock  
Dual shock absorbers & stabilizer  
Taper suspension light  
Taper control brake - 100  
Power-assist steering 11.000 GVWR  
Full instrumentation  
Wipers headlights  
Heavy duty radiator/hood construction  
One piece ABS shock absorbers & discs  
Pneumatic suspension shock with  
spring top for easy service  
Pneumatic air vents  
Power steering  
Rear 16" fuel filter  
Radiator water recovery system  
Handbrake/brakes  
Transmission oil cooler

**Safety**  
Back-up light  
Traction light  
Emergency exit side window  
Emergency brakes  
Emergency hand rail  
Fire extinguisher  
Hanging fog light  
17 gal fuel detector  
Large remote mirror with  
side angle mirror, and rear mirror  
Fuel light  
Fuel gauge w/ fuel filter  
Self-extinguishing electrical/light  
Smoke detector  
Seat belt with shoulder and torso  
Tandem safety glass  
Warning triangle reflector kit

**Liability**  
1.17" thick Spynotch insulation  
Built in LP color TV over dash  
AM/FM stereo w/ AM, FM  
80W Turbohead, 100  
4 burner cooking w/ gas oven  
40 gallon LP tank  
Free electric stove w/ heat  
40 seat air-conditioned/air conditioner  
hall heating/cooling  
Automatic door light  
Built-in recessed display  
Carpeted overhead cabinets  
Color head-washers/shower  
Controlled environment in kitchen & bath  
Controlled water retention on DSEI  
Curtains and drapes  
Dishwash tank  
Electric range & pad  
Digital stereo/boom in bathroom  
Digital clock  
Domestic A/C w/ remote control  
Durable stainless steel sink  
Ergonomic AMP/PM speakers  
with rock & roll  
Exterior color TV hookup  
Eye level instrumentation/monitor area  
Fluorescent indicator  
Flame level night light  
Fluorescent lighting throughout  
Full service door  
Generator vents in bathroom & outside  
In motor  
Large built-in/over & tub combination  
Lighted vanity with mirror  
Minor oil water heater with  
electricity system  
One piece fiberglass roof and aluminum  
Panel & entry light with touch switch  
Power cooling vent in both area  
Rear wheel parking  
Rearview & mirror chair  
Roofing job & complete water  
Seal-over joints on all  
Seals  
Theoretically extended tank  
at service  
Truck computer pump on diesel model  
TV antenna with booster  
Wet sewage tank  
Washable draining system  
Wiper wipers in both & kitchen  
Wiper park

**Electrical**  
10 amp automatic charge-out  
100 voltmeter & polarity meter  
50 amp disconnect  
4.5 K.C. groundrod, 1' pad  
17 amp. converter-charger  
Master battery disconnect switch  
Trailer wiring  
Wiring/Cabling  
11.000 BTU heater/C  
30.000 BTU tank heater/C  
12.000 BTU roof AC w/ heat strip  
(1.000 BTU heater w/ electric  
ignition (1000 and 12.000 BTU))

**Convenience**  
30 gal. grey water capacity  
30 gal. black water capacity  
170 lb. LP tank  
37" interior length  
30 gallon water capacity  
2 gallon pre-charged water accumulator  
14.000 wattage  
Electronic system monitor  
Compassion heated dump hose & valve  
Door lock  
Door latching & air heater  
Electric 100 outlet  
Close box  
Large fuel type belly storage  
Large remote mirror  
Step-light for step & on-pipe  
Step-light controlled fan system  
Stove w/ night  
Seat mounted rock and ladder  
Seat  
Storage compartment light  
Trampoline park

MODEL NO*	WHEEL BASE	RETAIL
3600	225"	\$172,900.00

\* Model number does not appear. Any.

Prices, specifications, descriptions and illustrations in this literature are accurate as known at the time of publication but subject to change without notice.  
1991 Model Price List effective 3/1/91

1991 U225 Specifications

**Foretravel, inc.**  
MICROHOMES OF DETECTION

### 3600, 3800, 4000 SERIES GRAND VILLA UNIHOME U280

BASIC FLOOR PLAN 36  
36 - SEW BATH, TWIN BEDS  
36L - SEW BATH, ISLAND BED  
36R - SEW BATH, ISLAND BED  
36S - SEW BATH, ISLAND BED, BWHETTE

**STANDARD EQUIPMENT**

**Aerodynamics**  
17.000 amp. bow heater  
Vulco 50000 Fuel/air filter  
30 gallon fuel tank  
30 amp alternator  
30 amp battery isolator  
2 7 amp remote bank  
270000 22.5 F/GCA. 16.000 lb. tow  
Air brake  
Air line for tow service  
Allison MT 60 transmission  
Compu-COOL 220 HP  
Cruise control  
50 psi air shock  
Dual shock absorbers & stabilizer  
Taper suspension light  
Taper control brake - 100  
Power-assist steering 11.000 GVWR  
Full instrumentation  
Wipers headlights  
Heavy duty radiator/hood construction  
One piece ABS shock absorbers & discs  
Pneumatic suspension shock with  
spring top for easy service  
Pneumatic air vents  
Power steering  
Rear 16" fuel filter  
Radiator water recovery system  
Handbrake/brakes  
Transmission oil cooler

**Safety**  
Back-up light  
Traction light  
Emergency exit side window  
Emergency brakes  
Emergency hand rail  
Fire extinguisher  
Hanging fog light  
17 gal fuel detector  
Large remote mirror with  
side angle mirror, and rear mirror  
Fuel light  
Fuel gauge w/ fuel filter  
Self-extinguishing electrical/light  
Smoke detector  
Seat belt with shoulder and torso  
Tandem safety glass  
Warning triangle reflector kit

**Liability**  
1.17" thick Spynotch insulation  
Built in LP color TV over dash  
AM/FM stereo w/ AM, FM  
80W Turbohead, 100  
4 burner cooking w/ gas oven  
40 gallon LP tank  
Free electric stove w/ heat  
40 seat air-conditioned/air conditioner  
hall heating/cooling  
Automatic door light  
Built-in recessed display  
Carpeted overhead cabinets  
Color head-washers/shower  
Controlled environment in kitchen & bath  
Controlled water retention on DSEI  
Curtains and drapes  
Dishwash tank  
Electric range & pad  
Digital stereo/boom in bathroom  
Digital clock  
Domestic A/C w/ remote control  
Durable stainless steel sink  
Ergonomic AMP/PM speakers  
with rock & roll  
Exterior color TV hookup  
Eye level instrumentation/monitor area  
Fluorescent indicator  
Flame level night light  
Fluorescent lighting throughout  
Full service door  
Generator vents in bathroom & outside  
In motor  
Large built-in/over & tub combination  
Lighted vanity with mirror  
Minor oil water heater with  
electricity system  
One piece fiberglass roof and aluminum  
Panel & entry light with touch switch  
Power cooling vent in both area  
Rear wheel parking  
Rearview & mirror chair  
Roofing job & complete water  
Seal-over joints on all  
Seals  
Theoretically extended tank  
at service  
Truck computer pump on diesel model  
TV antenna with booster  
Wet sewage tank  
Washable draining system  
Wiper wipers in both & kitchen  
Wiper park

**Electrical**  
10 amp automatic charge-out  
100 voltmeter & polarity meter  
50 amp disconnect  
4.5 K.C. groundrod, 1' pad  
17 amp. converter-charger  
Master battery disconnect switch  
Trailer wiring  
Wiring/Cabling  
11.000 BTU heater/C  
30.000 BTU tank heater/C  
12.000 BTU roof AC w/ heat strip  
(1.000 BTU heater w/ electric  
ignition (1000 and 12.000 BTU))

**Convenience**  
30 gal. grey water capacity  
30 gal. black water capacity  
170 lb. LP tank  
37" interior length  
30 gallon water capacity  
2 gallon pre-charged water accumulator  
14.000 wattage  
Electronic system monitor  
Compassion heated dump hose & valve  
Door lock  
Door latching & air heater  
Electric 100 outlet  
Close box  
Large fuel type belly storage  
Large remote mirror  
Step-light for step & on-pipe  
Step-light controlled fan system  
Stove w/ night  
Seat mounted rock and ladder  
Seat  
Storage compartment light  
Trampoline park

MODEL NO*	WHEEL BASE	RETAIL
3600	225"	\$235,500.00
3800	225"	\$264,000.00
4000	276"	\$278,500.00

\* Model number does not appear. Any.

Prices, specifications, descriptions and illustrations in this literature are accurate as known at the time of publication but subject to change without notice.  
1991 Model Price List effective 3/1/91

1991 U280 Specifications



**3600 Grand Villa**  
OSHROSH REAR ENGINE GAS



3600 GVF OREG SBI



3600 GVF OREG SB

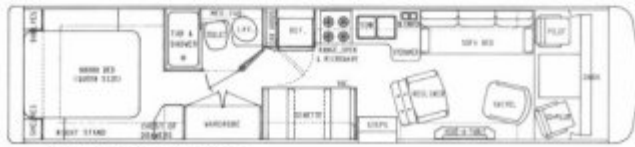

3600 GVF OREG SBI DINETTE

[1991 OREG Floor Plans](#)

**2900 Grand Villa**  
FRONT ENGINE GAS

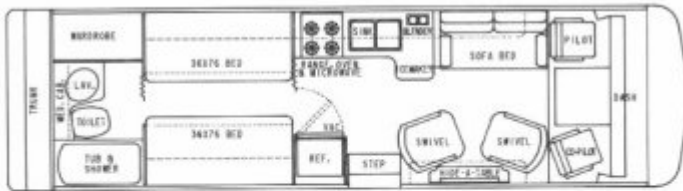

2900 GVF RB



2900 GVF SBI

[1991 2900 Floor Plans](#)

**Photos**

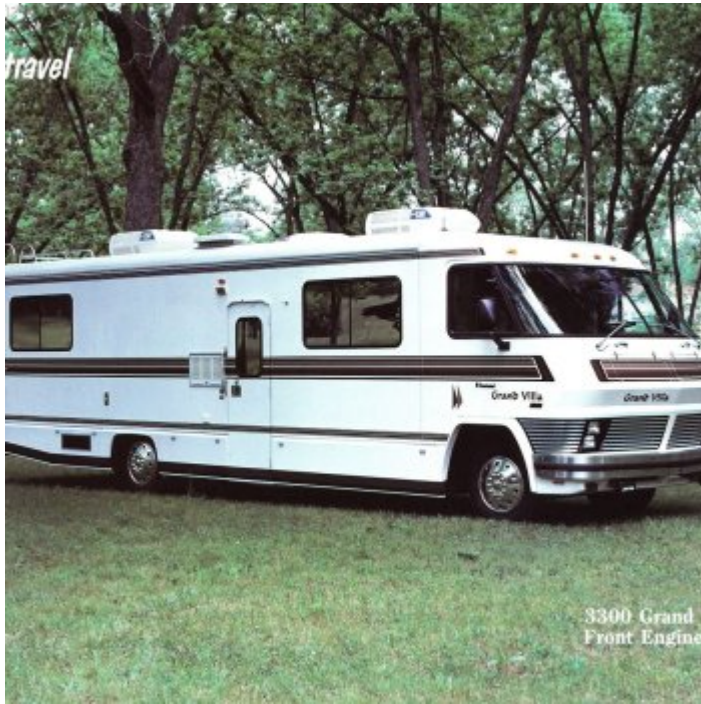

1991 33' Front Gas Poster



1991 4000 Oshkosh Poster





1991 U280



1991 U240



1991 Grand Villa



1991 U300

## Specifications

### 1991 Grand Villa U300

#### Models & Codes

MODEL NO	WHEEL BASE	RETAIL
Foretravel Grand Villa 3600	228"	\$295,000
Foretravel Grand Villa 3800	252"	\$302,500
Foretravel Grand Villa 4000	276"	\$310,500
Model number denotes approx. length		
CODE	DESCRIPTION	
SB	SIDE BATH, TWIN BEDS	
SBI	SIDE BATH, ISLAND BED	
SAI	SIDE AISLE, ISLAND BED	
SBID	SIDE BATH, ISLAND BED, DINETTE	

## Features

### WEIGHTS/RATINGS

### WEIGHTS/RATINGS

- Fresh water capacity: 88 gal.
- Gray water capacity: 44 gal.
- Waste water capacity: 44 gal.
- Fuel tank capacity: 150 gal.
- LP tank capacity: 300 lb.
- Interior Height: 77"
- Wheelbase: 228"/36', 252"/38', 276"/40'
- Available Lengths: 36', 38', 40'
- GVWR: 25,800 lb.

### AUTOMOTIVE

### AUTOMOTIVE

- (3)-200 amp. hour batteries
- 148 gallon fuel tank
- 160 amp alternator
- 160 amp battery isolator
- 2" square receiver hitch
- 275/80R 225 PXZA Michelin tires
- 8 bag 100% air-ride suspension
- Air disk brakes
- Air hose for tire service
- Allison MTB 648 transmission ATEC
- Cruise control
- DDA Silver 6V92TA DDEC
- Dry air cleaner
- Dual electric wipers & washers
- Engine compartment light
- Engine coolant heater 110V

- Foretravel chassis 30,000 GVWR
- Full instrumentation
- Halogen headlights
- Heavy duty radiator, boiled construction
- Heavy steel bumpers with decorative fascia
- One piece Alcoa aluminum wheels
- Padded automotive-type dash with swing-up top for easy service
- Padded sun visors
- Power steering
- Racor fuel filter
- Radiator water recovery system
- Transmission oil cooler
- Transmission retarder brake

## LIVABILITY

## LIVABILITY

- 1 1/2" block Styrofoam insulation
- 20" Stereo TV in living area
- 36x76 Twin beds - SB
- 60x80 queen-size bed - SBI
- 4 burner cooktop with gas Oven
- 40 channel CB radio
- 6-way electric driver seat base
- All wood drawers on full extension ball bearing glides
- AM/FM/cassette stereo in bedroom
- Automatic closet lights
- Built-in 13" color TV & VCR in bedroom
- Built-in vacuum cleaner
- Carpeted overhead cabinets
- Cedar lined wardrobe closet
- Corian countertops in kitchen & bath Corian table w/chairs on 4000 SAI & SBID
- Corian lavatory bowl
- Curtains and sheers
- Deadbolt lock
- Deluxe carpet & pad
- Digital alarm clock in bedroom
- Digital clock
- Dometic AES ref/freezer (except SAI)
- Dometic AES ref/freezer w/built-in ice maker (SAI only)
- Double stainless steel sink
- Electronic AM/FM/cassette w/seek & scan
- Exterior cable TV hookup
- Eye level microwave/convection oven
- Fiberglass underskin
- Floor level night lights
- Florescent lighting throughout
- Full screen door
- Generator switch in bedroom & cockpit
- Ice maker (except SAI models)

- Large bath/shower & tub combination
- laundry bag on SAI model
- lavatory drawer
- Lighted vanity with mirror
- Motor-aid water heater / electronic ignition
- One piece fiberglass roof and sidewalls
- Porch & entry lights with touch switch
- Power ceiling vent in bath area
- Real wood paneling
- Recliner & swivel chair
- Reclining pilot & co-pilot seats
- Slide-out pantry on SBI
- Slide-out console table
- Sofa bed
- Thermostatically controlled fresh air ventilator
- Three point compartment door latches
- Trash compactor (except on 3600 & 3800 dinette models)
- TV antenna with booster
- Wall mounted clock
- Wardrobe dressing mirrors
- Washer/dryer connections on 4000 Series
- Water pump switch in bath & kitchen
- Water purifier

## **ELECTRICAL**

## **ELECTRICAL**

- 110 volt automatic changeover
- 110 voltmeter & polarity meter
- 1500 watt inverter
- 50 Amp. shoreline
- 15 K.W. generator/diesel fueled
- 75 Amp. converter-charger
- Master battery disconnect switch
- Trailer wiring

## **SAFETY**

## **SAFETY**

- Back-up lights
- Back-up monitor
- Docking lights
- Emergency exit side windows
- Emergency flashers
- Entry door hand rail
- Fire extinguisher
- Halogen fog lights

- Large outside remote mirrors with wide angle vision, heated
- LP gas leak detector
- Park lights
- Retractable seat belts
- Self-canceling directional signal lights
- Smoke detector
- Steel cage with aluminum roof frame
- Tinted safety glass
- Warning triangle reflector kit

## **HEATING/COOLING**

## **HEATING/COOLING**

- 17,250 BTU auto/AC
- 35,000 BTU auto heat/def.
- (2)-35.000 BTU ducted furnaces with electronic ignition
- (35,000 + 16.000 on 3600 series)
- (2)-13.500 BTU roof AC with heat strips

## **CONVENIENCE**

## **CONVENIENCE**

- 110 gal. gray water capacity
- 54 gal. black water capacity
- 102 gallon water capacity
- 2 gallon pre-charged water accumulator
- 77" interior height
- 110v air compressor
- 270 lb. LPG tank
- Air leveling system
- Antenna warning
- Automatic air step
- Computer screen systems monitor
- Conveniently located dump hose & valves
- Doorbell
- Dual Hadley air horns
- Exterior 110 v outlet
- Glove box
- Large bus type belly storage
- large interior storage
- Map lights for pilot & co-pilot
- Pilot & co-pilot ducted fan system
- Remote searchlight
- Roof mounted rack and ladder
- Safe
- Storage compartment lights
- Telephone jack

# 1991 Grand Villa U280

## Models & Codes

MODEL NO	WHEEL BASE	RETAIL
Foretravel Grand Villa 3600	228"	\$255,500
Foretravel Grand Villa 3800	252"	\$264,500
Foretravel Grand Villa 4000	276"	\$278,500
CODE	DESCRIPTION	
SB	SIDE BATH, TWIN BEDS	
SBI	SIDE BATH, ISLAND BED	
SAI	SIDE AISLE, ISLAND BED	
SBID	SIDE BATH, ISLAND BED, DINETTE	

## Features

### WEIGHTS/RATINGS

### WEIGHTS/RATINGS

- Fresh water capacity: 88 gal.
- Gray water capacity: 44 gal.
- Waste water capacity: 44 gal.
- Fuel tank capacity: 150 gal.
- LP tank capacity: 300 lb.
- Interior Height: 77"
- Wheelbase: 228"/36', 252"/38', 276"/40'
- Available Lengths: 36', 38', 40'
- GVWR: 25,800 lb.

### AUTOMOTIVE

### AUTOMOTIVE

- (2)-200 amp. hour batteries
- 8 bag 100% air-ride suspension
- 148 gallon fuel tank
- 160 amp alternator
- 160 amp battery isolator
- 2" square receiver hitch
- 275/80R 223 PXZA Michelin tires
- Air disk brakes
- Air hose for tire service
- Allison MT643 transmission
- Caterpillar 3208T 250 H.P.
- Cruise control
- Dry air cleaner

- Dual electric wipers & washers
- Engine compartment light
- Engine coolant heater - 110v
- Foretravel chassis 28,000 GVWR
- Full instrumentation
- Halogen headlights
- Heavy duty radiator, bolted construction
- Heavy duty bumpers with decorative fascia
- One piece Alcoa\* aluminum wheels
- Padded automotive-type dash with swing-up top for easy service
- Padded sun visors
- Power steering
- Racor fuel filter
- Radiator water recovery system
- Transmission oil cooler

## LIVABILITY

## LIVABILITY

- 1 1/2" block Styrofoam insulation
- 20" Stereo TV in living area
- 36x76 Twin beds - SB
- 4 burner cooktop with gas oven
- 40 channel CB radio
- 6-way electric driver seat base
- 60x80 queen-size bed - SBI
- All wood drawers on full extension ball bearing glides
- AM/FM/cassette stereo in bedroom
- Automatic closet lights
- Built-in 13' color TV & VCR in bedroom
- Built-in vacuum cleaner
- Carpeted overhead cabinets
- Cedar lined wardrobe closet
- Corian countertops in kitchen & bath
- Corian table w/chairs on 4000 SAI & SBID
- Corian lavatory bowl
- Curtains and sheers
- Deadbolt lock
- Deluxe carpet & pad
- Digital alarm clock in bedroom
- Digital clock
- Dometic AES ref/freezer (except SAI)
- Dometic AES ref/freezer w/built-in icemaker (SAI only)
- Double stainless steel sink
- Electronic AM/FM/cassette with seek & scan
- Exterior cable TV hookup
- Eye level microwave/convection oven
- Fiberglass underskin
- Floor level night lights
- Fluorescent lighting throughout



- Full screen door
- Generator switch in bedroom & cockpit
- Ice maker (except SAI models)
- Large bath/shower & tub combination
- Laundry bag on SAI model
- Lavatory drawer
- Lighted vanity with mirror
- Motor-aid water heater with electronic ignition
- One piece fiberglass roof and sidewalls
- Porch & entry lights with touch switch
- Power ceiling vent in bath area
- Real wood paneling
- Recliner & swivel chair
- Reclining pilot & co-pilot seats
- Slide-out pantry on SBI
- Slide-out console table
- Sofa bed
- Thermostatically controlled fresh air ventilator
- Three-point compartment door latches
- Trash compactor except on 3600 series dinette models
- TV antenna with booster
- Wall mount clock
- Wardrobe dressing mirrors
- Washer/dryer connections on 4000 series
- Water pump switch in bath & kitchen
- Water purifier

## **ELECTRICAL**

## **ELECTRICAL**

- 110 volt automatic changeover
- 110 voltmeter & polarity meter
- 50 Amp. shoreline
- 6.3 K.W. generator/LP. fuel
- 75 Amp. converter-charger
- Master battery disconnect switch
- Trailer wiring

## **SAFETY**

## **SAFETY**

- Back-up lights
- Back-up monitor
- Docking lights
- Emergency exit side windows
- Emergency flashers
- Entry door hand rail

- Fire extinguisher
- Halogen fog lights
- Large outside remote mirrors with wide angle vision, heated
- LP gas leak detector
- Park lights
- Retractable seat belts
- Self-canceling directional signal lights
- Smoke detector
- Steel cage with aluminum roof frame
- Tinted safety glass
- Warning triangle reflector kit

## HEATING/COOLING

## HEATING/COOLING

- 17,250 BTU auto/AC
- 35,000 BTU auto heat/def.
- (2)-13,500 BTU roof AC with heat strips
- (2)-35,000 BTU ducted furnaces with electronic ignition (16,000 + 35,000 on 3600 series)

## CONVENIENCE

## CONVENIENCE

- 110 gal. gray water capacity
- 54 gal. black water capacity
- 102 gallon water capacity
- 2 gallon pre-charged water accumulator
- 77" interior height
- 110 v air compressor
- 2701b. LPG tank
- Air leveling system
- Antenna warning
- Automatic air step
- Computer screen systems monitor
- Conveniently located dump hose & valves
- Doorbell
- Dual Hadley air horns
- Exterior 110v outlet
- Glove box
- Large bus type belly storage
- Large interior storage
- Map lights for pilot & co-pilot
- Pilot & co-pilot ducted fan system
- Remote searchlight
- Roof mounted rack and ladder
- Safe
- Storage compartment lights

- Telephone jack

## 1991 Grand Villa U225

### Models & Codes

MODEL NO	WHEEL BASE	RETAIL
Grand Villa 3600	228"	\$172,500
Model number denotes approx- length		
CODE	DESCRIPTION	
SB	SIDE BATH, TWIN BEDS	
SBI	SIDE BATH, ISLAND BED	
SBID	SIDE BATH, ISLAND BED, DINETTE	

## Features

### WEIGHTS/RATINGS

### WEIGHTS/RATINGS

- Fresh water capacity: 88 gal.
- Gray water capacity: 44 gal.
- Waste water capacity: 44 gal.
- Fuel tank capacity: 150 gal.
- LP tank capacity: 300 lb.
- Interior Height: 77"
- Wheelbase: 228"/36', 252"/38', 276"/40'
- Available Lengths: 36', 38', 40'
- GVWR: 25,800 lb.

### AUTOMOTIVE

### AUTOMOTIVE

- (2)-200 amp. hour batteries
- Velvet Ride Torsilastic Suspension
- 100 gallon fuel tank
- 160 amp alternator
- 160 amp battery isolator
- 2" square receiver hitch
- 235/80 R 22.5 TXZU4 Michelin tires
- Air brakes
- Air hose for tire service
- Allison MT 643 transmission
- Cummins 6BTA5.9 230 H.P.
- Cruise control

- Dry air cleaner
- Dual electric wipers & washers
- Engine compartment light
- Engine coolant heater - 110v
- Foretravel chassis 22,500 GVWR
- Full instrumentation
- Halogen headlights
- Heavy duty radiator; bolted construction
- One piece Alcoa aluminum wheels
- Padded automotive-type dash with swing-up top for easy service
- Padded sun visors
- Power steering
- Racor fuel filler
- Radiator water recovery system
- Stainless steel bumpers
- Transmission oil cooler

## LIVABILITY

## LIVABILITY

- 1 1/2" block Styrofoam insulation
- Built in 13" color TV over dash
- 60x80 queen-size bed - SBI
- 36x76 Twinbeds-SB
- 4 burner cooktop with gas oven
- 40 channel CB radio
- 6-way electric driver seat base
- All wood drawers on full extension ball bearing glides
- Automatic closet lights
- Built-in vacuum cleaner
- Carpeted overhead cabinets
- Cedar lined wardrobe closet
- Corian countertops in kitchen & bath
- Cori3nS table w/chairs on SBID
- Curtains and sheers
- Deadbolt lock
- Deluxe carpet & pad
- Digital alarm clock in bedroom
- Digital clock
- Dometic AES ref/freezer
- Double stainless steel sink
- Electronic AM/FM/cassette with seek & scan
- Exterior cable TV hookup
- Eye level microwave/convection oven
- Fiberglass underskin
- Floor level night lights
- Fluorescent lighting throughout
- Full screen door
- Generator switch in bedroom & cockpit
- Ice maker

- Large bath/shower & tub combination
- Lighted vanity with mirror
- Motor-aid water heater with electronic ignition
- One piece fiberglass roof and sidewalls
- Porch & entry lights with touch switch
- Power ceiling vent in bath area
- Real wood paneling
- Recliner & swivel chair
- Reclining pilot & co-pilot seats
- Slide-out pantry on SBI
- Sofa bed
- Thermostatically controlled fresh air ventilator
- Trash compactor except on dinette model
- TV antenna with booster
- Wall mount clock
- Wardrobe dressing mirrors
- Water pump switch in bath & kitchen
- Water purifier

## **ELECTRICAL**

## **ELECTRICAL**

- 110 volt automatic changeover
- 110 voltmeter A polarity meter
- 50 Amp. shoreline
- 6.5 K.W. generator/L-P. fuel
- 75 Amp. converter-charger
- Master battery disconnect switch
- Trailer wiring

## **SAFETY**

## **SAFETY**

- Back-up lights
- Docking lights
- Emergency exit side windows
- Emergency flashers
- Entry door hand rail
- Fire extinguisher
- Halogen fog lights
- LP gas leak detector
- Large outside mirrors with angle vision, and turn signals
- Park lights
- Retractable seat belts
- Self-canceling directional signal lights
- Smoke detector
- Steel cage with aluminum roof frame

- Tinted safety glass
- Warning triangle reflector kit

## HEATING/COOLING

## HEATING/COOLING

- 17,250 BTU auto/AC
- 35,000 BTU auto heat/def.
- (2)-13^00 BTU roof AC with heat strips
- (2)-Ducted furnaces with electronic ignition (16,000 and 35.000 BTU)

## CONVENIENCE

## CONVENIENCE

- 85 gal. gray water capacity
- 40 gal. black water capacity
- 1741b. LPG tank
- 77" interior height
- 88 gallon water capacity
- 2 gallon pre-charged water accumulator
- HWH leveling system
- Electronic system monitor
- Conveniently located dump hose & valves
- Doorbell
- Dual Hadley air horns
- Exterior 110 v outlet
- Glove box
- Large bus type belly storage
- Large interior storage
- Map lights for pilot & co-pilot
- Pilot & co-pilot ducted fan .-system
- Remote searchlight
- Roof mounted rack and ladder
- Safe
- Storage compartment lights
- Telephone jack

## 1991 OREG Grand Villa 3400, 3600

### Models & Codes

MODEL NO	WHEEL BASE	RETAIL
Grand Villa 3400	204"	\$145,000
Grand Villa 3800	228"	\$148,500
OSHKOSH Rear Engine Gas		

MODEL NO	WHEEL BASE	RETAIL
Model number denotes approx length		
CODE	DESCRIPTION	
SB	SIDE BATH, TWIN BEDS	
SBI	SIDE BATH, ISLAND BED	
SBID	SIDE BATH, ISLAND BED, DINETTE	

## Features

### WEIGHTS/RATINGS

### WEIGHTS/RATINGS

- Fresh water capacity: 88 gal.
- Gray water capacity: 44 gal.
- Waste water capacity: 44 gal.
- Fuel tank capacity: 150 gal.
- LP tank capacity: 300 lb.
- Interior Height: 77"
- Wheelbase: 228"/36', 252"/38', 276"/40'
- Available Lengths: 36', 38', 40'
- GVWR: 25,800 lb.

### AUTOMOTIVE

### AUTOMOTIVE

- 100 gallon fuel tank
- 2" square receiver hitch
- 200 Amp. hour battery - coach
- 9R 22.5 Michelin tires (lubeless)
- Battery isolator
- Cruise control
- Dry air cleaner
- Dual electric wipers & washers
- Engine compartment light
- Ford 460 V8 engine
- Ford C-6 automatic transmission
- Full instrumentation
- Halogen headlights
- Heavy duty alternator
- Heavy duty radiator
- One piece Alcoa aluminum wheels
- Oshkosh V-814 18,000 GVWR chassis
- Padded automotive-type dash with swing-up top for easy service
- Padded sun visors
- Power disc brakes
- Power steering

- Radiator water recovery system
- Stainless steel bumpers
- Transmission oil cooler

## LIVABILITY

## LIVABILITY

- 1 1/2" block Styrofoam insulation
- 36x76 Twin beds-SB
- 4-burner cooktop with gas oven below
- 40 channel CB radio
- 60x80 queen-size bed - SBI
- All wood drawers on full extension ball bearing glides
- Automatic closet lights
- Built-in 13" color TV over dash
- Built-in breakfast bar with bench 3600 series except SBID
- Built-in vacuum cleaner
- Carpeted overhead cabinets
- Cedar lined double wardrobe closet
- Corian countertops in kitchen & bath
- Corian table w/chairs on SBID
- Curtains and sheers
- Deadbolt lock
- Deluxe carpet & pad
- Digital alarm clock in bedroom
- Digital clock
- Dometic AES ref/freezer
- Double stainless steel sink
- Electronic AM/FM/cassette w/seek & scan
- Exterior cable TV hookup
- Eye level microwave/convection oven
- Fiberglass underskin
- Floor level night lights
- Fluorescent lighting throughout
- Pull screen door
- Generator switch in bedroom & cockpit
- Ice maker
- Large bath/shower & tub combination
- Lavatory drawer - SB, SBI
- Lighted vanity with mirror
- Motor-aid water heater with electronic ignition
- One piece fiberglass roof & sidewalk
- Porch & entry lights w/touch switch
- Power ceiling vent in bath area
- Real wood paneling
- Recliner & swivel chair
- Reclining pilot & co-pilot seats
- Slide-out pantry
- Slide-out console table & drawer
- Sofa bed



- Thermostatically controlled fresh air ventilator
- Trash compactor - 3600 series except SBID
- TV antenna with 2 jacks
- Wall mounted clock
- Wardrobe dressing mirrors
- Water pump switch in bath & kitchen
- Water purifier

## **ELECTRICAL**

## **ELECTRICAL**

- 110 volt automatic changeover
- 110 voltmeter & polarity meter
- 50 Amp. shoreline
- 7.0 K.W. generator
- 75 Amp. converter-charger
- Master battery disconnect switch
- Trailer wiring

## **SAFETY**

## **SAFETY**

- Back-up beeper
- Back-up lights
- Emergency exit side windows
- Emergency flashers
- Entry door hand rail
- Fire extinguisher
- Halogen fog lights
- Impact switch for emergency fuel pump shut down
- large outside mirrors with wide angle vision, turn signals
- LP gas leak detector
- Park lights
- Retractable seat bells
- Self-canceling directional signal lights
- Smoke detector
- Steel cage with aluminum roof frame
- Steel chassis
- Tinted safety glass
- Warning triangle reflector kit

## **HEATING/COOLING**

## **HEATING/COOLING**

- 17,250 BTU auto AC

- 35.000 BTU auto heat/def.
- (2)-13,500 BTU roof AC with heat strips
- (2) Ducted furnaces with electronic ignition (16.000 & 35.000 BTU)

**CONVENIENCE**

**CONVENIENCE**

- 100 lb. LPG tank
- 38 and 44 gallon waste tanks (3400)
- 60 and 75 gallon waste tanks (3600)
- 77" interior height
- 88 gallon water capacity
- 2 gallon pre-charged water accumulator
- 90 3/8" interior width
- Antenna warning
- Battery boost switch
- Conveniently located dump hose & valves
- Dual electric trumpet horns
- Electronic systems monitor
- Exterior 110v outlet
- Glove box
- Large exterior storage
- Large interior storage
- LPG access door
- Map lights for pilot & co-pilot
- Pilot & co-pilot ducted fan system
- Remote searchlight
- Roof mounted rack and ladder
- Telephone jack

**OPTIONS**

**OPTIONS**

<b>Advanced Electronics Package</b>	<b>\$5221</b>
Computer screen systems monitor	\$925
Closed circuit back-up camera	\$1675
1500 watt inverter system	\$2600
Audit 1150 Climatic Screen	\$475
Note: Computer screen required if rear camera is ordered	
<b>Awning Package I</b>	<b>\$1665</b>
Window awnings covering four windows	\$824
Patio awning	\$876
Two matching chairs	\$110
<b>Awning Package II</b>	<b>\$1854</b>
Window awnings covering five windows	\$1030
Patio awning	\$876

<b>Awning Package II</b>	<b>\$1854</b>
Two matching chairs	\$110
<b>Awning Package III</b>	<b>\$2044</b>
Window awnings covering six windows	\$1236
Patio awning	\$876
Two matching chairs	\$110
<b>Sound Option</b>	<b>\$975</b>
Sony Compact Disc Player/Changer	\$975
<b>Convenience Package</b>	<b>\$3852</b>
Roof pod	\$410
Hadley air horns	\$390
LP connections for Bar-B-Que	\$94
Docking lights (2 Sets)	\$275
Solar battery charger	\$550
Fire resistant safe	\$383
TV/VCR (bedroom)	\$1575
AM/FM/Cassette (bedroom)	\$510
<b>Deluxe Kitchen Package</b>	<b>\$478</b>
High rise faucet	\$120
Instant hot water dispenser	\$175
Blender	\$225
<b>Luxury Package</b>	<b>\$1092</b>
Parquet Flooring (kitchen only)	\$1032
Sealand china toilet	\$120
Personalized entrance door lighted assist handle	\$35
<b>Power Package</b>	<b>\$4327</b>
HWH automatic jacks	\$3693
Power remote and heated mirrors	\$275
Power D&P seats	\$660
Cellular antenna	\$75
<b>Winterizing Package</b>	<b>\$630</b>
Heat Tape water lines	\$510
Heat blanket under each tank (110v)	\$175

## 1991 ORED Grand Villa 3400, 3600

### Models & Codes

MODEL NO	WHEEL BASE	RETAIL
Grand Villa 3400	204"	\$153,500
Grand Villa 3800	228"	\$159,500
OSHKOSH Rear Engine Diesel		
Model number denotes approx length		
CODE	DESCRIPTION	
SB	SIDE BATH, TWIN BEDS	
SBI	SIDE BATH, ISLAND BED	

CODE	DESCRIPTION
SBID	SIDE BATH, ISLAND BED, DINETTE

## Features

### WEIGHTS/RATINGS

### WEIGHTS/RATINGS

- Fresh water capacity: 88 gal.
- Gray water capacity: 44 gal.
- Waste water capacity: 44 gal.
- Fuel tank capacity: 150 gal.
- LP tank capacity: 300 lb.
- Interior Height: 77"
- Wheelbase: 228"/36', 252"/38', 276"/40'
- Available Lengths: 36', 38', 40'
- GVWR: 25,800 lb.

### AUTOMOTIVE

### AUTOMOTIVE

- 100 gallon fuel tank
- (2)- 200 Amp. hour batteries
- 2" square receiver hitch
- 9R225 Michelin tires (tubeless)
- Allison AT545 transmission
- Battery isolator
- Cruise control
- Detroit 8.2T V8 engine (210 h.p.)
- Dry air cleaner
- Dual electric wipers A washers
- Engine compartment light
- Full instrumentation
- Halogen headlights
- Heavy duty alternator
- Heavy duty radiator
- One piece Alcoa aluminum wheels
- Oshkosh V-815 20,500 GVWR chassis
- Padded automotive-type dash with swing-up top for easy service
- Padded sun visors
- Power disc brakes
- Power steering
- Stainless steel bumpers
- Transmission oil cooler

## LIVABILITY

## LIVABILITY

- 1 1/2" block Styrofoam insulation
- 36x76 Twin beds-SB
- 4-burner cooktop with gas oven below
- 40 channel CB radio
- 60x80 queen-size bed -SBI
- All wood drawers on full extension ball bearing glides
- Automatic closet lights
- Built-in 13" color TV over dash
- Built-in breakfast bar with bench 3600 series except SBID
- Built-in vacuum cleaner
- Carpeted overhead cabinets
- Cedar lined double wardrobe closet
- Corian countertops in kitchen & bath
- Corian table w/chairs on SBID
- Curtains and sheers
- Deadbolt lock
- Deluxe carpet & pad
- Digital alarm clock in bedroom
- Digital clock
- Dometic AES ref/freezer
- Double stainless steel sink
- Electronic AM/FM/cassette with seek & scan
- Exterior cable TV hookup
- Eye level microwave/convection oven
- Fiberglass underskin
- Floor level night lights
- Fluorescent lighting throughout
- Full screen door
- Generator switch in bedroom & cockpit
- Ice maker
- large bath/shower & tub combination
- Lavatory drawer - SB, SBI
- Lighted vanity with mirror
- Motor-aid water heater with electronic ignition
- One piece fiberglass roof & sidewalls
- Porch & entry lights with touch switch
- Power ceiling vent in bath area
- Real wood paneling
- Recliner & swivel chair
- Reclining pilot & co-pilot seats
- Slide out pantry
- Slide out console table & drawer
- Sofa bed
- Thermostatically controlled fresh air ventilator
- Trash compactor - 3600 series except SBID
- TV antenna with 2 jacks
- Wall mounted clock

- Wardrobe dressing mirrors
- Water pump switch in bath, kitchen
- Water purifier

## **ELECTRICAL**

## **ELECTRICAL**

- 110 volt automatic changeover
- 110 volt meter & polarity meter
- 50 Amp. shoreline
- 6.5 K.W. generator/LP fuel
- 75 Amp. convertor-charger
- Master battery disconnect switch
- Trailer wiring

## **SAFETY**

## **SAFETY**

- Back-up beeper
- Back-up lights
- Emergency exit side windows
- Emergency flashers
- Entry door hand rail
- Fire extinguisher
- Halogen Tog lights
- large outside mirrors with wide angle vision, turn signals
- LP gas leak detector
- Park lights
- Retractable seat belts
- Self-canceling directional signal lights
- Smoke detector
- Steel cage with aluminum roof frame
- Steel chassis
- Tinted safety glass
- Warning triangle reflector kit

## **HEATING/COOLING**

## **HEATING/COOLING**

- (2) Ducted furnaces with electronic ignition (16,000 & 35,000 BTU)
- 17,250 BTU auto AC
- 35,000 BTU auto heat/def.
- (2)-13,500 BTU roof AC with heat strips

**CONVENIENCE****CONVENIENCE**

- 194 lb. LPG tank
- 38 and 44 gallon waste tanks (3400)
- 60 and 75 gallon waste tanks (3600)
- 77" interior height
- 88 gallon water capacity
- 2 gallon pre-charged water accumulator
- Antenna warning
- Battery boost switch
- Conveniently located dump hose & valves
- Dual electric trumpet horns
- Electronic systems monitor
- Exterior 110v outlet
- Glove box
- Large exterior storage
- Large interior storage
- LPG access door
- Map lights for pilot & co-pilot
- Pilot & co-pilot ducted fan system
- Remote searchlight
- Roof mounted rack and ladder
- Telephone jack

**OPTIONS****OPTIONS**

<b>Advanced Electronics Package</b>	<b>\$5221</b>
Computer screen systems monitor	\$925
Closed circuit back-up camera	\$1675
1500 watt inverter system	\$2600
Audit 1150 Climatic Screen	\$475
Note: Computer screen required if rear camera is ordered	
<b>Awning Package I</b>	<b>\$1665</b>
Window awnings covering four windows	\$824
Patio awning	\$876
Two matching chairs	\$110
<b>Awning Package II</b>	<b>\$1854</b>
Window awnings covering five windows	\$1030
Patio awning	\$876
Two matching chairs	\$110
<b>Awning Package III</b>	<b>\$2044</b>
Window awnings covering six windows	\$1236
Patio awning	\$876
Two matching chairs	\$110

<b>Sound Option</b>	<b>\$975</b>
Sony Compact Disc Player/Changer	\$975
<b>Convenience Package</b>	<b>\$3852</b>
Roof pod	\$410
Hadley air horns	\$390
LP connections for Bar-B-Que	\$94
Docking lights (2 Sets)	\$275
Solar battery charger	\$550
Fire resistant safe	\$383
TV/VCR (bedroom)	\$1575
AM/FM/Cassette (bedroom)	\$510
<b>Deluxe Kitchen Package</b>	<b>\$478</b>
High rise faucet	\$120
Instant hot water dispenser	\$175
Blender	\$225
<b>Luxury Package</b>	<b>\$1092</b>
Parquet Flooring (kitchen only)	\$1032
Sealand china toilet	\$120
Personalized entrance door lighted assist handle	\$35
<b>Power Package</b>	<b>\$4327</b>
HWH automatic jacks	\$3693
Power remote and heated mirrors	\$275
Power D&P seats	\$660
Cellular antenna	\$75
<b>Winterizing Package</b>	<b>\$630</b>
Heat Tape water lines	\$510
Heat blanket under each tank (110v)	\$175

From:  
<https://wiki.foreforums.com/> - Foretravel Wiki

Permanent link:  
[https://wiki.foreforums.com/through\\_the\\_years:specs:1991](https://wiki.foreforums.com/through_the_years:specs:1991)

Last update: **2024/07/27 19:16**

