

# Table of Contents

- 1999 Foretravel** ..... 3
  - Specifications U320 / U295 / U270** ..... 3
  - Brochures** ..... 3
  - Floor Plans** ..... 3
  - Photos** ..... 5
- Specifications** ..... 6
  - 1999 U320** ..... 6
    - Models / Codes ..... 6
    - WEIGHTS/RATINGS ..... 7
    - CHASSIS ..... 7
    - COCKPIT FEATURES ..... 8
    - LIVABILITY ..... 8
    - ELECTRICAL ..... 9
    - SAFETY ..... 10
    - EXTERIOR FEATURES ..... 10
    - HEATING/COOLING ..... 11
  - 1999 U295** ..... 11
    - Models & Codes ..... 11
    - WEIGHTS/RATINGS ..... 11
    - CHASSIS ..... 12
    - COCKPIT FEATURES ..... 12
    - LIVABILITY ..... 13
    - HEATING/COOLING/ELECTRICAL ..... 14
    - SAFETY ..... 14
    - EXTERIOR FEATURES ..... 15
  - 1999 U270** ..... 15
    - Models & Codes ..... 15
    - WEIGHTS/RATINGS ..... 16
    - CHASSIS ..... 16
    - COCKPIT FEATURES ..... 17
    - LIVABILITY ..... 17
    - HEATING/COOLING/ELECTRICAL ..... 18
    - SAFETY ..... 18
    - EXTERIOR FEATURES ..... 19



# 1999 Foretravel

Specifications Brochures & Photos for model year 1999



- Added Ducted Air Conditioning w/(2) 13,500 BTU Roof A/C's w/Heat Pumps instead of Heat strips
- End of year 1999's introduced a slide out.

## Specifications U320 / U295 / U270

- [1999 U320 Specifications](#)
- [1999 U295 Specifications](#)
- [1999 U270 Specifications](#)

## Brochures

- [1999 U320 Options Flyer](#)
- [1999 U295 Options Flyer](#)
- [1999 U270 Options Flyer](#)

## Floor Plans

- [U320 Floor Plans](#)
- [U295 Floor Plans](#)
- [U270 Floor Plans](#)



1999 U270 Floor Plans

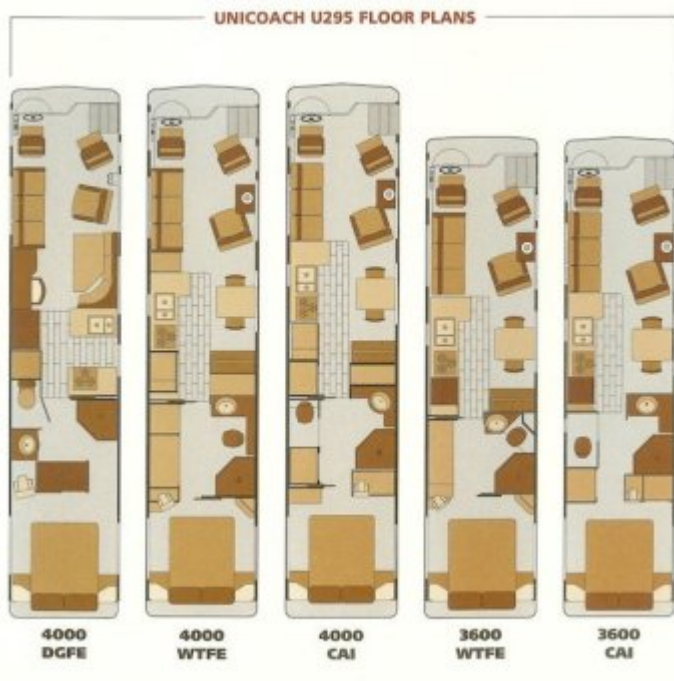

1999 U295 Floor Plans

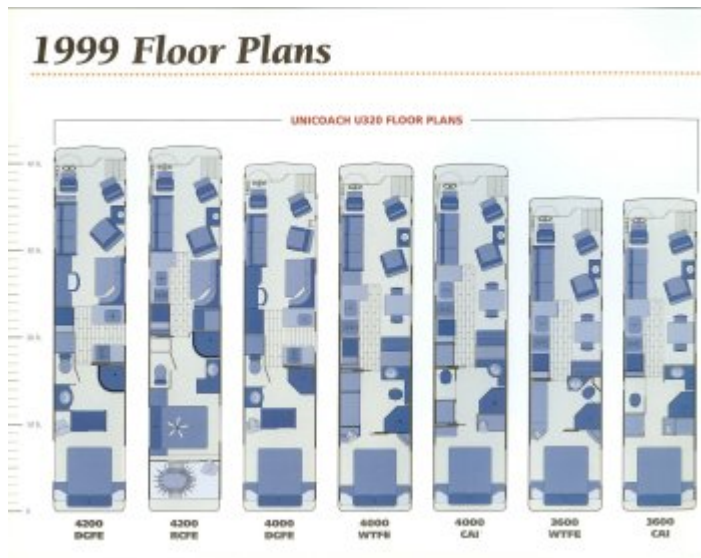

1999 U320 Floor Plans

## Photos



1999 U270



1999 U320



1999 U295

## Specifications

### 1999 U320

#### Models / Codes

MODEL NO	WHEEL BASE	LENGTH	HEIGHT	WIDTH	INT HEIGHT	RETAIL
4200 U320		42'	11'4"	102"	80"	\$459,000
4000 U320	276"	40'	11'4"	102"	80"	\$405,000
3600 U320	228"	36'	11'4"	102"	80"	\$374,500

CODE	DESCRIPTION
CAI	CENTER AISLE, ISLAND BED
WTFE	WALK THROUGH BATH, FRONT ENTRY
DGFE	DOUBLE GALLEY, FRONT ENTRY

## WEIGHTS/RATINGS

## WEIGHTS/RATINGS

- GVWR: 34,880 lbs.
- GCWR: 44,880 lbs.
- Fresh water capacity: 102 gal.
- Gray water capacity: 110 gal.
- Black water capacity: 54 gal.
- LP Tank: 17 gal.
- Fuel capacity: 194 gal.

## CHASSIS

## CHASSIS

- Foretravel Monocoque Chassis & Superstructure
- Cummins M11 Celect+ 450 hp Electronic Diesel Engine
- Allison HD 4060R 6 Speed Transmission w/ Retarder
- Alcoa Aluminum Wheels (6)
- All-wheel Air Disc Brakes
- Anti-lock Braking System
- Computerized Air-leveling System w/ Auxiliary 12v. Air Compressor
- Dual Halogen Headlamps Electronic Cruise Control
- Engine Batteries: Gel Type (3)
- Engine Block Heater
- Koni Shock Absorbers (8)
- Power Steering
- Racor Integrated Fuel System with Air & Water Purge
- Radiator Coolant Recovery System
- Rear Axle Ratio 3.91:1
- Suspension Firestone Air Springs, 8 Bag, 100% Air Ride, Outboard Mounted
- Texaco Extended Life 300,000 mile Coolant
- Tilt & Telescoping Steering Wheel
- Tires Michelin 275/80R22.5 XZA2
- Transmission Oil Cooler
- 160 amp Alternator
- 190 amp Battery Isolator
- 10,000 lb. Rated Receiver Hitch

## COCKPIT FEATURES

## COCKPIT FEATURES

- Antenna Warning Alarm
- Audit 8T8 Systems Monitor w/Backup Camera, Electronic Outdoor Thermometer & Compass
- Battery Boost Switch
- Cell Phone Antenna & Connection
- Drink Holders on Dash & next to Co-pilot Seat
- Electronic Cruise Control
- Generator Start Switch
- Illuminated Dash Panel & Shifter Panel
- LCD Odometer, Trip Meter & Engine Hour Meter
- Map Lights for Pilot & Co-pilot
- Smart Wheel Steering Wheel
- w/Headlamp Flash, Marker lamp Flash, Cruise Control & Wiper Washer Controls
- Sony AM/FM/Cassette Radio
- Synchronized Windshield Wipers
- Tilt & Telescoping Steering Wheel
- VDO Analog Gauges
- Wrap-around Dash w/Fold-up Snack Tray
- 40 Channel Hand-held CB Radio w/ Weather Band
- 6 Way Power Pilot & Co-pilot Seats

## LIVABILITY

## LIVABILITY

- Aqua-Hot Hydronic Heating & Hot Water
- Air Operated Step-well Cover w/Dual Controls
- Bedroom Alarm Clock
- Bedroom TV
- Bose Lifestyle 25 Home Theater System w/CD Changer
- Built-in Desk (DGFE plan only)
- Built-in Safe
- Cedar-lined Wardrobe
- Chandelier at Dining Table
- China Cabinet in Kitchen
- Concealed Cabinet Door Hinges
- Closet lights w/Automatic Switch
- Designer Accent Pillows, Sofa & Bed Designer Window Treatment w/Day/Night Shades in Living Room
- Dometic 12 cu.ft. Side-by-side Refrigerator/Freezer w/Compressor Ice Maker or 10 cu. ft. Model w/Separate Ice Maker (see floor plans)
- Drinking Water Filter
- Ducted Air Conditioning
- Extra Wide Co-pilot Seat w/Electric Footrest
- Fantastic Fan in Bath
- Floor level Accent lights
- Full 60" X 80" Queen Bed
- Fully Lined Drapes w/Sheer Shades in Bedroom



- Generator Switch in Bedroom
- Gourmet Kitchen Faucet w/Spray
- Halogen Accent Lighting
- Hand-crafted Walnut Cabinetry
- Home Theater Speakers in Bedroom
- Kool-o-Matic Exhaust Fan in Kitchen
- Leather Villa Dinette (some models)
- leather Villa Pilot & Co-pilot Seats
- leather Villa Recliner or loveseat
- leather Villa Sofa bed
- Magazine Rack
- Manibloc Plumbing System
- Microphor Porcelain Toilet
- Plank Floor in Kitchen Sink Area
- Recessed Gaggenau 2-burner Cooktop
- Recessed Fluorescent lighting
- Sealand Porcelain Toilet (3600 only)
- Sharp Microwave/Convection Oven
- Shower Head Slider
- Slide Out Shelf under Kitchen Sink
- Solid Surface Countertops in Kitchen & Bath
- Solid Surface Desk Top (some models)
- Solid Surface Dining Table
- Solid Surface 2 Compartment Kitchen Sink
- Solid Surface lavatory Sink Swing-arm Reading lamps in Bedroom
- Telephone Jack in Living Area & Bedroom
- Tip-out Storage below Kitchen Sink
- TV Antenna w/Signal Booster
- VCR in Front Overhead Cabinet
- VCR Control Eye in Bedroom
- Wainscoted Walls w/vinyl Wall Covering
- Wardrobe Dressing Mirror
- Washer/Dryer Connections
- Water Pump Switch in Kitchen, Bath & Utility Compartment
- Window Accent Lighting
- 20" TV in Front Overhead Cabinet

## **ELECTRICAL**

## **ELECTRICAL**

- Coach Batteries: 8d Gel Type w/Heat Probes (3)
- Freedom 2S Heart Interface Inverter/Charger
- Generator Low-battery Auto-start
- Link 2000 Battery Monitor
- Master Battery Disconnect Switch
- Polarity Meter in Utility Compartment
- 10.0 kw Power Tech. Diesel Generator
- 50 amp Shoreline Connection
- 110 AC Voltmeter

## SAFETY

## SAFETY

- Allison Transmission Retarder w/Dual Actuators (hand lever & brake pedal)
- Awning Safety Locks
- Back-up Lights
- Battery Quick Disconnect Switch at Entry Door
- Carbon Monoxide Detector
- Chrome Ramco Remote Controlled & Heated Mirrors w/ Wide-angle Field of Vision
- Emergency Flasher Lights
- Extended Entry Door Assist Handle
- Exterior Security Lights (docking lights) (4)
- Fire Extinguisher
- Halogen Headlamps & Fog Lamps
- Heat Probes on Coach Batteries
- Lighted Entry Door Assist Handle
- LP leak Detector
- Non-Skid Surface on Roof near ladder
- Polarity Meter In Utility Compartment
- Rosen Sun Visors Smoke Detector
- Step Well Cover, Air Operated
- 8' Tint at Top of Windshield
- 110 AC Voltmeter

## EXTERIOR FEATURES

## EXTERIOR FEATURES

- Air Hose for Tire Service
- Air Operated Entry Step
- Carpeted Storage Bays
- Door Bell
- Fluorescent Storage Bay lights
- Fuel Fill Two Sides
- Hadley Air Horns (2)
- Insulated Windows
- Keyless Remote Locks on Entry Door & Storage Bays
- Large Pass-through Storage Bays
- Lighted Entry Door Assist Handle
- MaxGuard 29 Gelcoat Exterior Finish w/Long Life UV Protection
- Modular Storage Drawers
- Mud Flaps
- One Piece Crowned Fiberglass Roof
- Parallel Storage Bay Doors (bus-style)
- Porch Light w/Touch Switch
- PTL Entry Door
- Roof Rack & Ladder
- Screen Door w/Kick Guard
- Shelf in Fresh Water Bay

- Shelf In LP Compartment
- Slide-out Cargo Tray
- Trailer Wiring
- TV Outlet & 12 v. Outlet In Storage Bay
- Utility Station:  
Fresh Water Hook-up, 50 amp Shoreline Connection, Hot & Cold Water Faucet, Soap Dispenser, Cable Television & Phone Connections, Paper Towel Holder, Easy Access Dump Valves, 110 v. Receptacle, Polarity Meter, Water Pump Switch
- Zip Dee Patio & Window Awnings w/Safety locks

## HEATING/COOLING/ELECTRICAL

### HEATING/COOLING

- Aqua-Hot Hydronic Heating
- Comfort Control Center for AC & Aqua-Hot
- Ducted Air Conditioning w/(2) 13,500 BTU Roof A/C with Heat Pumps
- Zip Dee Patio & Window Awnings w/Safety locks
- 22,000 BTU Automotive Air conditioner
- 42,000 BTU Automotive Heater/Defroster

## 1999 U295

### Models & Codes

MODEL NO	WHEEL BASE	RETAIL
3600	228"	\$332,500
4000	276"	\$363,000

CODE	DESCRIPTION
CAI	CENTER AISLE, ISLAND BED
WTFE	WALK THROUGH BATH, FRONT ENTRY
DGFE	DOUBLE GALLEY, FRONT ENTRY

### WEIGHTS/RATINGS

### WEIGHTS/RATINGS

- GVWR: 33,000 lbs.
- GCWR: 43,000 lbs.
- GCWR (4200): 48,000 lbs.
- Fresh water capacity: 102 gal.
- Gray water capacity: 110 gal.
- Black water capacity: 54 gal.
- LP Tank: 42 gal.
- Fuel capacity: 148 gal.

## CHASSIS

### CHASSIS

- Foretravel Monocoque Chassis & Superstructure
- Cummins ISC 8.3 350 hp Electronic Diesel Engine
- Allison MD-3066R 6 Speed Transmission w/Retarder
- Alcoa Aluminum Wheels (6)
- All-wheel Air Disc Brakes
- Anti-lock Braking System
- Bilstein Shock Absorbers (8)
- Computerized Air-leveling System w/Auxiliary 12 v. Air Compressor
- Dual Halogen Headlamps
- Electronic Cruise Control
- Engine Batteries: Gel Type (2)
- Engine Block Heater
- Power Steering
- Racor Fuel Filter/Water Separator
- Radiator Coolant Recovery System
- Rear Axle Ratio: 4.63:1
- Suspension: Firestone Air Springs, 8 Bag, 100% Air Ride, Outboard Mounted
- Texaco Extended Life 300,000 mi. Coolant
- Tilt 8 Telescoping Steering Wheel
- Tires: Michelin 275/80R22.5 XZA2
- Transmission Oil Cooler
- 160 amp Alternator
- 190 amp Battery Isolator
- 10,000 lb. Rated Receiver Hitch

### COCKPIT FEATURES

### COCKPIT FEATURES

- Antenna Warning Alarm
- Audit 8T8 Systems Monitor w/Back-up Camera, Electronic Outdoor Thermometer & Compass
- Battery Boost Switch
- Cell Phone Antenna & Connection
- Drink Holders on Dash & next to Co-pilot Seat
- Electronic Cruise Control
- Flexsteel Pilot & Co-pilot Seats
- Generator Start Switch
- Illuminated Dash Panel & Shifter Panel
- LCD Odometer, Trip Meter & Engine Hour Meter
- Map Lights for Pilot & Co-pilot
- Smart Wheel Steering Wheel w/Headlamp Flash, Marker Lamp Flash, Cruise Control & Wiper Washer Controls
- Sony AM/FM/Cassette Radio
- Synchronized Windshield Wipers
- Tilt & Telescoping Steering Wheel
- VDO Analog Gauges
- Wrap-around Dash w/Fold-up Snack Tray

- 40 Channel Hand-held CB Radio w/Weather Band
- 6 Way Power Pilot & Co-pilot Seats

## LIVABILITY

## LIVABILITY

- Air Operated Step-well Cover w/Dual Controls
- Bedroom Alarm Clock
- Bedroom TV
- Bose Companion Surround Sound System
- Built-in Desk (DGFE plan only)
- Built-in Safe
- Cedar-lined Wardrobe
- Chandelier at Dining Table
- China Cabinet in Kitchen
- Concealed Cabinet Door Hinges
- Closet Lights w/Automatic Switch
- Designer Accent Pillows, Sofa & Bed
- Designer Window Treatment w/Day/Night Shades in Living Room
- Dometic 12 cu.ft. Side-by-side Refrigerator/Freezer w/Compressor Ice Maker or 10 cu.ft. Model w/Separate Ice Maker (see floor plans)
- Drinking Water Filter
- Ducted Air Conditioning
- Extra Wide Co-pilot Seat
- Fantastic Fan in Bath
- Flexsteel Recliner
- Flexsteel Sofa Bed
- Flexsteel Pilot & Co-pilot Seats
- Floor Level Accent Lights
- Full 60" X 80" Queen Bed
- Fully Lined Drapes w/Sheer Shades in Bedroom
- Generator Switch in Bedroom
- Gourmet Kitchen Faucet w/Spray
- Halogen Accent Lighting
- Hand-crafted Walnut Cabinetry
- Kool-o-Matic Exhaust Fan in Kitchen
- Magazine Rack
- Manibloc Plumbing System
- Plank Floor in Kitchen Sink Area
- Recessed 3-Burner Cooktop
- Recessed Fluorescent Lighting
- Sealand Porcelain Toilet
- Sharp Microwave/Convection Oven
- Shower Head Slider
- Slide Out Shelf under Kitchen Sink
- Solid Surface Countertops in Kitchen & Bath
- Solid Surface Desk Top (some models)
- Solid Surface Dining Table
- Solid Surface 2 Compartment Kitchen Sink
- Solid Surface Lavatory Sink

- Sony AM/FM/Cassette Radio in Bedroom
- Swing-arm Reading Lamps in Bedroom
- Telephone Jack in Living Area & Bedroom
- Tip-out Storage below Kitchen Sink
- TV Antenna w/Signal Booster
- VCR in Front Overhead Cabinet
- VCR Control Eye in Bedroom
- Wainscoted Walls w/Vinyl Wall Covering
- Wardrobe Dressing Mirror
- Washer/Dryer Connections
- Water Pump Switch in Kitchen, Bath & Utility Compartment
- 10 gal. 3-way Water Heater
- 20" TV in Front Overhead Cabinet

## **HEATING/COOLING/ELECTRICAL**

## **HEATING/COOLING/ELECTRICAL**

- Coach Batteries: 8d Gel Type w/Heat Probes (3)
- Comfort Control Center\* for A/C & Furnace
- Ducted Air Conditioning w/(2) 13,500 BTU Roof A/C w/Heat Pumps
- Dual Ducted Furnaces (35,000 BTU & 16,000 BTU)
- Freedom 25 Heart Interface Inverter/Charger
- Generator Low-battery Auto-start
- Link 2000 Battery Monitor
- Master Battery Disconnect Switch
- Polarity Meter in Utility Compartment
- 10.0 kw Power Tech Diesel Generator
- 50 amp Shoreline Connection
- 110 AC Voltmeter
- 22,000 BTU Automotive Air Conditioner
- 42,000 BTU Automotive Heater/Defroster

## **SAFETY**

## **SAFETY**

- Allison Transmission Retarder w/Dual Actuators (hand lever S brake pedal)
- Awning Safety Lock
- Back-up Lights
- Battery Quick-Disconnect Switch at Entry Door
- Carbon Monoxide Detector
- Chrome Ramco Remote Controlled & Heated Mirrors w/Wide-angle Field of Vision
- Emergency Flasher Lights
- Extended Entry Door Assist Handle U295
- Exterior Security Lights (docking lights) (4)
- Fire Extinguisher
- Halogen Headlamps & Fog Lamps
- Heat Probes on Coach Batteries

- Lighted Entry Door Assist Handle
- LP Leak Detector
- Non-Skid Surface on Roof near Ladder
- Polarity Meter in Utility Compartment
- Rosen Sun Visors
- Smoke Detector
- Step Well Cover, Air Operated
- 8" Tint at Top of Windshield
- 110 AC Voltmeter

## **EXTERIOR FEATURES**

## **EXTERIOR FEATURES**

- Air Hose for Tire Service
- Air Operated Entry Step
- Carpeted Storage Bays
- Door Bell
- Fluorescent Storage Bay Lights
- Fuel Fill Two Sides
- Hadley Air Horns (2)
- Insulated Windows
- Keyless Remote Locks on Entry Door & Storage Bays
- Large Pass-through Storage Bays
- Lighted Entry Door Assist Handle
- MaxGuard 29 Gelcoat Exterior Finish w/Long Life UV Protection
- Mud Flaps
- One Piece Crowned Fiberglass Roof
- Parallel Storage Bay Doors (bus-style)
- Porch Light w/Touch Switch
- PTL Entry Door
- Roof Rack & Ladder
- Screen Door w/Kick Guard
- Shelf in Fresh Water Bay
- Shelf in LP Compartment
- Slide-out Cargo Tray
- Trailer Wiring
- TV Outlet & 12v. Outlet in Storage Bay
- Utility Station:  
Fresh Water Hook-up, 50 amp Shoreline Connection, Hot & Cold Water Faucet. Soap Dispenser,  
Cable Television & Phone Connections, Paper Towel Holder, Easy Access Dump Valves, 110 v. Receptacle,  
Polarity Meter, Water Pump Switch
- Zip Dee1 Patio Awning w/Safety Lock

## **1999 U270**

## **Models & Codes**

MODEL NO	WHEEL BASE	LENGTH	HEIGHT	WIDTH	INT HEIGHT	RETAIL
3400 U270		34'	11'4"	102"	80"	\$269,500
3600 U270	228"	36'	11'4"	102"	80"	\$275,000
4000 U270	276"	40'	11'4"	102"	80"	\$305,500

CODE	DESCRIPTION
CAI	CENTER AISLE, ISLAND BED
WTFE	WALK THROUGH BATH, FRONT ENTRY
DGFE	DOUBLE GALLEY, FRONT ENTRY

**WEIGHTS/RATINGS**

**WEIGHTS/RATINGS**

- GVWR: 31,000 lbs.
- GCWR: 41,000 lbs.
- Fresh water capacity: 102 gal.
- Gray water capacity: 110 gal.
- Black water capacity: 54 gal.
- LP Tank: 42 gal.
- Fuel capacity: 148 gal.

**CHASSIS**

**CHASSIS**

- Foretravel Monocoque Chassis & Superstructure
- Cummins ISC 8.3 350 hp Electronic Diesel Engine
- Allison MD-3066R 6 Speed Transmission w/Retarder
- Alcoa Aluminum Wheels (4)
- All-wheel Air Disc Brakes
- Anti-lock Braking System
- Bilstein Shock Absorbers (8)
- Computerized Air-leveling System w/Auxiliary 12v. Air Compressor
- Dual Halogen Headlamps
- Electronic Cruise Control
- Engine Batteries: Gel Type (2)
- Engine Block Heater
- Power Steering
- Racor Fuel Filter/Water Separator
- Radiator Coolant Recovery System
- Rear Axle Ratio: 4.63:1
- Suspension: Firestone' Air Springs. 8 Bag. 100% Air Ride, Outboard Mounted
- Texaco' Extended Life 300,000 mi. Coolant
- Tilt & Telescoping Steering Wheel
- Tires: Michelin" 275/80R22.5 XZA2
- Transmission Oil Cooler
- 130 amp Alternator
- 190 amp Battery Isolator
- 10,000 lb. Rated Receiver Hitch



## **COCKPIT FEATURES**

### **COCKPIT FEATURES**

- Antenna Warning Alarm
- Audit 9T6 Systems Monitor w/Back-up Camera
- Battery Boost Switch
- Drink Holders on Dash & next to Pilot & Co-pilot
- Electronic Cruise Control
- Flexsteel Pilot & Co-pilot Seats
- Generator Start Switch
- Illuminated Dash Panel
- LCD Odometer, Trip Meter & Engine Hour Meter
- Map Lights for Pilot & Co-pilot
- Smart Wheel Steering Wheel w/Headlamp Flash, Marker Lamp Flash, Cruise Control & Wiper/Washer Controls
- Sony AM/FM/Cassette Radio
- Synchronized Windshield Wipers
- Tilt & Telescoping Steering Wheel
- VDO Analog Gauges
- Wrap-around Dash w/Fold-up Snack Tray
- 40 Channel Hand-held CB Radio w/Weather Band
- 6 Way Power Pilot & Co-pilot Seats

## **LIVABILITY**

### **LIVABILITY**

- Air Operated Step-well Cover w/Dual Controls
- Bedroom TV
- Cedar-lined Wardrobe Panels
- China Cabinet in Kitchen
- Closet Lights
- Designer Accent Pillows, Sofa & Bed
- Designer Window Treatment w/Day/Night Shades in Living Room
- Dometic Royale 8 cu.ft. Refrigerator/Freezer w/Wood Panel Door
- Drinking Water Filter
- Ducted Air Conditioning
- Fantastic Fan in Bath
- Flexsteel Recliner
- Flexsteel Sofa Bed
- Flexsteel Pilot & Co-pilot Seats
- Floor Level Accent Lights
- Full 60" X 80" Queen Bed
- Fully Lined Drapes w/Sheer Shades in Bedroom
- Halogen Accent Lighting
- Hand-crafted Oak Cabinetry
- Icemaker
- Kool-o-Matic Exhaust Fan in Kitchen
- Magazine Rack
- Manibloc Plumbing System

- Plank Floor in Kitchen Sink Area
- Porcelain Lavatory Sink
- Recessed 3-Burner Cooktop
- Recessed Fluorescent Lighting
- Sealand Porcelain Toilet
- Sharp Microwave/Convection Oven
- Shower Head Slider
- Solid Surface Countertops in Kitchen & Bath
- Solid Surface Desk Top (4000 Series)
- Solid Surface Dining Table w/Leaf
- Stainless Steel Kitchen Sink
- Swing-arm Reading Lamps in Bedroom
- Telephone Jack in Living Area
- TV Antenna w/Signal Booster
- VCR in Front Overhead Cabinet
- Wainscoted Walls w/Vinyl Wall Covering
- Wardrobe Dressing Mirror
- Washer/Dryer Connections
- Water Pump Switch in Kitchen
- 10 gal. 3-way Water Heater
- 20" TV in Front Overhead Cabinet

## **HEATING/COOLING/ELECTRICAL**

## **HEATING/COOLING/ELECTRICAL**

- Coach Batteries: 8d Gel Type w/Heat Probes (2)
- Comfort Control Center for A/C & Furnace
- Ducted Air Conditioning w/(2) 13,500 BTU Roof A/C w/Electric Heat Strips
- Freedom 20 Heart Interface Inverter/Charger
- Generator Low-battery Auto-start
- Master Battery Disconnect Switch
- Polarity Meter in Utility Compartment
- 8.0 kw Power Tech Diesel Generator
- 50 amp Shoreline Connection
- 110 AC Voltmeter
- 17,250 BTU Automotive Air Conditioner
- 35,000 BTU Automotive Heater/Defroster
- 35,000 BTU Ducted Furnace w/Electronic Ignition

## **SAFETY**

## **SAFETY**

- Allison Transmission Retarder w/Dual Actuators (hand lever & brake pedal)
- Awning Safety Lock
- Back-up Lights
- Battery Quick-Disconnect Switch at Entry Door
- Carbon Monoxide Detector

- Emergency Flasher Lights
- Extended Entry Door Assist Handle
- Exterior Security Lights (docking lights) (4)
- Fire Extinguisher
- Halogen Headlamps & Fog Lamps
- Heat Probes on Coach Batteries
- Lighted Entry Door Assist Handle
- LP Leak Detector
- Non-Skid Surface on Roof near Ladder
- Polarity Meter in Utility Compartment
- Ramco Remote Controlled & Heated Mirrors w/Wide-angle Field of Vision
- Rosen Sun Visors
- Smoke Detector
- Step Well Cover, Air Operated
- 8" Tint at Top of Windshield
- 110 AC Voltmeter

## EXTERIOR FEATURES

## EXTERIOR FEATURES

- Air Operated Entry Step
- Carpeted Floors in Storage Bays
- Fluorescent Storage Bay Lights
- Fuel Fill Two Sides
- Hadley AirHorns (2)
- Insulated Windows
- Large Pass-through Storage Bays
- MaxGuard 29 Gelcoat Exterior Finish w/Long Life UV Protection
- Mud Flaps
- One Piece Crowned Fiberglass Roof
- Porch Light
- PTL Entry Door
- Roof Rack & Ladder
- Screen Door w/Kick Guard
- Trailer Wiring
- TV Outlet & 12 v. Outlet in Storage Bay
- Utility Station:  
Fresh Water Hook-up, 50 amp Shoreline Connection, Hot & Cold Water Faucet, Soap Dispenser,  
Cable Television & Phone Connections. Paper Towel Holder, Easy Access Dump Valves, 110 v. Receptacle,  
Polarity Meter
- Zip Dee Patio Awning w/Safety Lock

From:  
<https://wiki.foreforums.com/> - **Foretravel Wiki**

Permanent link:  
[https://wiki.foreforums.com/through\\_the\\_years:specs:1999](https://wiki.foreforums.com/through_the_years:specs:1999)

Last update: **2025/02/13 11:35**



