

## Table of Contents

<b>2005 Foretravel</b> .....	3
<b>Specifications U320 / U295 / U270</b> .....	3
<b>Brochures</b> .....	3
<b>Floor Plans &amp; Exteriors</b> .....	4
<b>Photos</b> .....	7
<b>Specifications</b> .....	9
<b>2005 U270 / U295 / U320</b> .....	9
Models & Codes .....	9
WEIGHTS/RATINGS .....	9
CHASSIS .....	11
EXTERIOR FEATURES .....	11
COCKPIT FEATURES .....	12
APPLIANCES/ELECTRONICS/LIGHTING/AUDIO-VIDEO .....	13
LIVABILITY .....	13
HEATING/COOLING/ELECTRICAL .....	14





# Floor Plans & Exteriors

## 2005 U270 Floor Plans

U270 34' WTLN



U270 36' WTLN



U270 36' PBLW

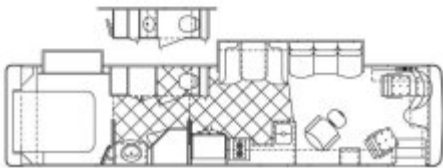

## 2005 U270 Floor Plans

### 2005 U295 Floor Plans

U295 40' PBQS



U295 36' PBGC



U295 36' PBLC



U295 38' PBGB



## 2005 U295 Floor Plans

# 2005 U320 Floor Plans

U320 40' PBQS



U320 42' PBQS



## 2005 U320 Floor Plans

# 2005 U320 Floor Plans

U320 42' PBGB



U320 42' PBLB



U320 42' PBTS



## 2005 U320 Floor Plans

## 2005 U320 Floor Plans

U320 40' DGLC



U320 40' PBGB



U320 40' PBGC



## [2005 U320 Floor Plans](#)

## 2005 Unicoach U270 Exterior Designs

051 Tuscany



052 Steele



## [2005 U270 Exteriors](#)



### 2005 U295 Exteriors



### 2005 U320 Exteriors

## Photos



2005 U270



2005 U295





2005 U320

## Specifications

### 2005 U270 / U295 / U320

#### Models & Codes

CODE	DESCRIPTION	Starting At:
DGLC	DOUBLE GALLEY, LEFT SLIDE CLOSET / LIVING	\$582,568
PBGB	PRIVATE BATH, LEFT SLIDE GALLEY / BED	\$585,813
PBGC	PRIVATE BATH, LEFT SLIDE GALLEY / CLOSET	\$582,568
PBLB	PRIVATE BATH, LEFT SLIDE BED	\$585,813
PBTS	PRIVATE BATH, TRIPLE SLIDE	\$618,979
PBLC	PRIVATE BATH, LEFT SLIDE CLOSET	\$582,568
PBQS	PRIVATE BATH, QUAD SLIDE	\$670,652

#### WEIGHTS/RATINGS

#### WEIGHTS/RATINGS

#### U320

- Fresh water capacity: 112 gal / 95 gal. in triple slide
- Gray water capacity: 115 gal / 100 gal. in triple slide
- Waste water capacity: 56 gal / 50 gal. in triple slide
- LP capacity: 17 gal
- Fuel tank capacity: 180 gal, 150 gal. in triple slide

- Overall Height: 11' 6.5" (to top of AC)
- Interior Height: x'
- Exterior Width 102"
- Wheelbase: xxx"
- Available Lengths: 38,40,42'
- GVWR: 42,000 lbs.
- Front GAWR: xxxlb.
- Rear GAWR: xxxlb.
- Tag GAWR: 9,000 lbs.
- GCWR: 52,000 lbs.

## U295

- Fresh water capacity: 95 gal.
- Gray water capacity 115 gal.
- Waste water capacity 56 gal.
- Fuel tank capacity: 150 gal.
- LP tank capacity: 42 gal / 17 gallons with Hydro-Hot
- Overall Height: 11' 6.5" (to top of AC)
- Interior Height: x'
- Exterior Width 102"
- Wheelbase: xxx"
- Available Lengths: 36,38,40
- GVWR: 35,320 lbs.
- Front GAWR: xxxlb.
- Rear GAWR: xxxlb.
- Tag GAWR: xxxlb.
- GCWR: 45,320 lbs.

## U270

- Fresh water capacity: 95 gal.
- Gray water capacity 115 gal.
- Waste water capacity 56 gal.
- Fuel tank capacity: 150 gal.
- LP tank capacity: 42 gal
- Overall Height: 11' 6.5" (to top of AC)
- Interior Height: x'
- Exterior Width 102"
- Wheelbase: xxx"
- Available Lengths: 34,36
- GVWR: 35,320 lbs.
- Front GAWR: xxxlb.
- Rear GAWR: xxxlb.
- Tag GAWR: xxxlb.
- GCWR: 45,320 lbs.

## CHASSIS

**CHASSIS**

<b>U320</b>	<b>U295</b>	<b>U270</b>	<b>CHASSIS FEATURES</b>
X	X	X	Foretravel chassis and superstructure
X			Cummins ISM02 500 h.p. electronic diesel engine
	X	X	Cummins ISL02 400 h.p. electronic diesel engine
X			Allison 4000MH 6 speed transmission
	X	X	Allison 3000MH 6 speed transmission
X	X	X	Allison transmission retarder, dual actuated
X	X	X	Air disc brakes, all wheels
X	X		Air hose for tire service
X	X	X	Anti-lock braking system
X	X	X	Automatic Traction Control (ATC)
X	X	X	Auxiliary 12 volt air compressor
X	X	X	Computerized air-leveling system
X	X	X	Electronic cruise control w/indicator light
X	X	X	Engine batteries: 3 Gel cell
X	X	X	Engine block heater
X			Koni shock absorbers
	X	X	Bilstein shock absorbers
X			Lifting tag axle, 9,000 lb. GAWR
X	X	X	Power steering
X			Racor integrated fuel system with air & water purge
X			Rear axle ratio 4.30:1
	X	X	Rear axle ratio 4.78:1
X			Remote battery jumper terminals
X	X	X	Suspension: air springs, 8-bag, 10-bag (U320),100% air ride, outboard mounted
X	X	X	Tires: 295/80R22.5
X	X	X	Transmission oil cooler
X			200 amp alternator
X	X	X	200 amp battery isolator
X	X	X	18,000 lb. rated receiver hitch

**EXTERIOR FEATURES****EXTERIOR FEATURES**

<b>U320</b>	<b>U295</b>	<b>U270</b>	<b>EXTERIOR FEATURES</b>
X	X	X	Air-operated entry step
X	X	X	Clear shield paint protection below windshield
			Convenient utility station:
X			Fresh water hose reel, 50 amp shoreline reel
X	X	X	Hot & cold water faucet, soap dispenser, cable TV & phone connection, paper towel holder, 110v receptacle, water pump switch
X	X	X	Docking lights (4)
X			Drawer in LP compartment
X	X	X	Dual halogen head lamps with turn signals
X	X	X	Fiberglass roof, one piece

<b>U320</b>	<b>U295</b>	<b>U270</b>	<b>EXTERIOR FEATURES</b>
X	X	X	Fuel fill either side of coach
X	X		Girard automatic patio awning (w/end caps U320 only)
		X	ZipDee patio awning
X	X	X	Hidden air horns
X	X	X	Insulated windows
X	X		Joey Bed
X	X	X	Keyless remote locks on entry door & storage bays
X			Stainless steel ladder
X	X	X	Lighted entry door assist handle
X	X		LP quick connect
X	X	X	Manibloc plumbing system
X	X	X	Painted exterior graphics with full body paint and double clear coat finish
X	X	X	Parallel storage bay doors (except under slide rooms)
X	X	X	PTL entry door w/screen
X			Ramco triple-head chrome mirrors, remote/heated
	X	X	Ramco double-head chrome mirrors, remote/heated
X	X	X	TV outlet and 12v outlet in storage bay
X	X	X	ZipDee window awnings
X			Black & gray tank flush kits

## COCKPIT FEATURES

## COCKPIT FEATURES

<b>U320</b>	<b>U295</b>	<b>U270</b>	<b>DASH AND COCKPIT FEATURES:</b>
X	X	X	AM/FM/Cassette radio with CD
X	X	X	Antenna warning alarm
X	X	X	Flip-up color back-up monitor with systems monitor, compass and outdoor thermometer
X	X	X	Back-lit analogue dash gauges
X	X	X	Battery boost switch
X	X	X	Cell phone connection and dual band antenna
X	X	X	Driver Information Center in dash
X	X	X	Electric windshield privacy shade
X	X	X	Hand held CB radio with weather band
X	X	X	Illuminated dash panel and shifter panel
X	X	X	Map lights, pilot and co-pilot
X	X	X	Slide-out drink holder and snack tray
X	X	X	Smart Wheel steering wheel, lighted
X	X	X	Leather 6 way power pilot seat
X	X	X	Leather 6 way power co-pilot seat with electric footrest
X			Heat & Massage controls - Driver & Passenger Chairs

## APPLIANCES/ELECTRONICS/LIGHTING/AUDIO-VIDEO

**APPLIANCES/ELECTRONICS/LIGHTING/AUDIO-VIDEO**

U320	U295	U270	APPLIANCES ELECTRONICS LIGHTING
			Living room audio/video
X			37" LCD TV monitor built into front overhead
	X		27" LCD TV monitor built into front overhead
		X	24" Sony Wega flat screen TV
X			Jamo Audio/Video receiver w/built-in CD/DVD player
	X	X	Sony Hi-Fi am/fm/av receiver (living room U295/U270, bedroom U295)
X	X	X	Jamo 5 cube speaker system w/powered sub woofer
X			Home theater universal remote
			Bedroom audio/video:
	X	X	20" (U295), 15" (U270) LCD TV
X			22" LCD TV
X			Jamo audio/video receiver with built-in CD/DVD player
X	X		Sony Hi-Fi VCR
X	X		Jamo in-wall 2 speaker system
X			Accent lighting under counters and behind valances
X	X		Dometic NDR-1402-BSIMHF 14 cu.ft. refrigerator/freezer w/ icemaker
X	X	X	Electric TV antenna with signal booster
X			G.E. Advantium oven, black
X	X		Halogen accent lighting
X	X	X	Halogen adjustable reading lamps in bedroom
X	X	X	Inverter/Power monitor panel
X	X		Multiplex lighting control system
	X	X	Seaward 2-burner cook top
X			Gaggenau 2-burner cook top
	X	X	Sharp black microwave/convection oven
X	X	X	Washer/dryer connections

**LIVABILITY****LIVABILITY**

U320	U295	U270	INTERIOR LIVABILITY FEATURES
X			Aqua-Hot hydronic heating and hot water system
X	X		Bedroom alarm clock
X	X		Built-in safe w/electronic push-button lock
X	X		Ceramic tile floor, entry
X	X	X	Ceramic tile floor, kitchen, bath
X	X	X	Color-coordinated throw pillows, sofa and bed
X	X	X	Concealed cabinet door hinges
X	X		Designer kitchen faucet with spray
X	X	X	Designer window treatment with day/night shades
X	X	X	Drinking water filter
X	X	X	Ekornes chair and ottoman, leather
X	X	X	Fantastic Fan in bath, automatic open/ close

U320	U295	U270	INTERIOR LIVABILITY FEATURES
X	X		Generator start/stop switch in bedroom
X	X	X	Handcrafted walnut, cherry or maple cabinetry
X	X	X	Pantry in kitchen
X	X	X	Porcelain toilet
X	X	X	Satin nickel and brass cabinet hardware
X	X		Slide-out shelf under kitchen sink
X	X		Slide-out drawer under refrigerator
X	X	X	Solid surface counter tops, kitchen and bath
X	X	X	Solid surface entry steps w/storage below
X	X		Solid surface 2-compartment kitchen sink
X	X		Solid surface lavatory sink
X	X	X	Storage under entry step
X	X		Tip out storage below kitchen sink
X			Water fill switch with automatic shut-off
X	X		Water pump switch in kitchen, bath, and utility station
X	X	X	60"x 80" queen bed
X	X	X	Step well cover, air operated

## HEATING/COOLING/ELECTRICAL

## HEATING/COOLING/ELECTRICAL

U320	U295	U270	HEATING COOLING ELECTRICAL
X			Aqua-Hot hydronic heating and hot water
	X	X	LP furnaces
X	X		Coach batteries: (3) 8d gel type with heat probe, (2) 8d gel type - U270
X	X	X	Comfort Control Center for A/C and Aqua-Hot
X	X	X	Ducted air conditioning: (2) Dometic 15,000 BTU roof a/c with heat pumps (3 units on 4200), (2) Dometic 13,500 BTU roof a/c with heat strips (U270)
X	X	X	Electrical surge suppression system
X	X	X	Low-battery generator auto-start
X	X	X	Master battery disconnect switch
X	X		ProSine 2500 watt inverter/charger, 2000 watt inverter/charger - U270
X	X	X	10.0 kw Power Tech® diesel generator in quiet box (12.0 kw on 4200 series)
X	X	X	50 amp shoreline connection
X	X	X	28,000 BTU Automotive air conditioner

From:

<https://wiki.foreforums.com/> - **Foretravel Wiki**

Permanent link:

[https://wiki.foreforums.com/through\\_the\\_years:specs:2005](https://wiki.foreforums.com/through_the_years:specs:2005)

Last update: **2025/02/13 15:52**

