

Table of Contents

2009 Foretravel Specifications	3
<i>Brochures</i>	3
<i>Photos</i>	5
Specifications	6
2009 Phenix / Nimbus	6
WEIGHTS/RATINGS	6
CHASSIS	6
DASH & COCKPIT	8
EXTERIOR FEATURES	8
APPLIANCES/ELECTRONICS/LIGHTING/AUDIO VIDEO	10
LIVABILITY	10
SAFETY	11
HEATING/COOLING/ELECTRICAL	12

2009 Foretravel Specifications

Specifications, Brochures, Floor Plans & Photos: Phenix, Nimbus

- [Phenix](#)
- [Nimbus](#)

Brochures



- Air entry steps were replaced with electric power steps.
- IFS is standard, although a solid front axle was offered as an option, none are known to have been ordered.

[2009 Product Guide](#)

[2009 Specifications](#)

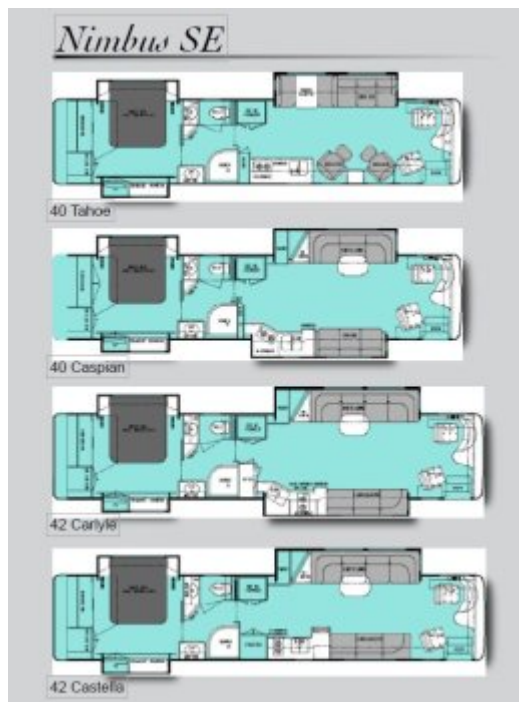

[2009 Nimbus SE Floor Plans](#)

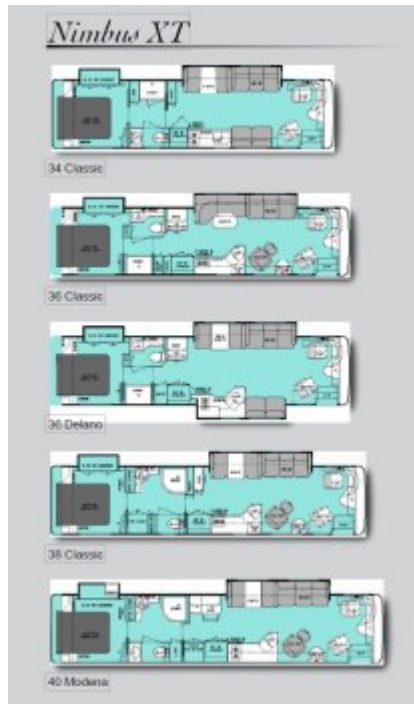

2009 Nimbus XT Floor Plans



2009 Phenix Floor Plans



2009 Phenix Floor Plans

Photos



2009 Nimbus



2009 Nimbus "CE"

Specifications

2009 Phenix / Nimbus

WEIGHTS/RATINGS

WEIGHTS/RATINGS

Phenix

- Fresh water capacity: 135 gal.
- Holding tank capacity: 145 gal.
- Fuel tank capacity: 200 gal.
- Overall Height: 12' 3" (to top of AC)
- Interior Height: x'
- Exterior Width 102"
- Wheelbase: xxx"
- Available Lengths: 40,42,45'
- GVWR: xxxlb.
- Front GAWR: 18,000 lb.
- Rear GAWR: xxxlb.
- Tag GAWR: xxxlb.
- GCWR: xxxlbs.

Nimbus

- Fresh water capacity: 95 gal. (36-38) / 135 gal. (40 & 42)
- Holding tank capacity: 145 gal.
- Fuel tank capacity: 120 gal. (36-38) / 150 gal. (40 & 42)
- LP tank capacity: 17 gal.
- Overall Height: 12' 3" (to top of AC)
- Interior Height: x'
- Exterior Width 102"
- Wheelbase: xxx"
- Available Lengths: 34,36,38,40 wo/tag, 40,42,45' w/tag
- GVWR: xxxlb.
- Front GAWR: xxxlb.
- Rear GAWR: xxxlb.
- Tag GAWR: xxxlb.
- GCWR: xxxlbs.

CHASSIS

CHASSIS

Nimbus XT 34*,36,38,40 (34 spc order)	Nimbus SE 40,42 -	Nimbus CE 38,40,42 -	Phenix 40,42,45 -	
S	S	S	S	ABS anti-lock braking system with automatic slack adjusters
S	S	S	S	Air disc brakes on all wheels
S	S	S	S	Air hose for tire service
S	S	S	S	Air quick connect in storage bay
S	S	S	S	Alcoa aluminum wheels with Dura-Bright protection
S		S(38)		Allison 6 speed transmission MH 3000R
	S(40&42)	S(40&42)	S	Allison 6 speed transmission MH 4000R
S	S	S	S	Allison transmission retarder
S		S(38)		Alternator - 160-amp
	S(40&42)	S(40&42)		Alternator - 200-amp
			S	Alternator - 320-amp
S	S	S	S	Automatic traction control (ATC)
S	S	S	S	Auxiliary 12v air compressor
S	S	S	S	Chassis - TravelRide by Foretravel all air ride with
S	S	S	S	4 outboard-mounted air springs (drive axle),
S	S	S	S	4 outboard-mounted air springs (straight front axle)
opt	opt	opt	S	2 air springs (IFS front axle)
	S(40&42)	S(40&42)	S	2 air springs (lifting tag axle)
S		S(38)		Engine - Cummins ISL 425 HP
	S(40&42)	S(40&42)		Engine - Cummins ISM 500 HP
			S	Engine - Cummins ISX 600 HP
S	S	S	S	Fuel filter/water separator
	S (40&42)	S (40&42)	S	Fuel system w/air & water purge
S	S	S		Front axle - straight beam
		opt	S	Front axle - IFS (independent front suspension)
S	S	S	S	Front tow retrieval points
S	S	S	S	House batteries - 210 amp AGM each
S	S	S	S	HWH computerized air leveling system
opt	opt	opt	opt	HWH Active Air System
S	S	S	S	Power steering
S	S	S	S	Radiator coolant recovery system
	S	S(40&42)	S	Rear axle ratio: 4.30:1
S		S(38)		Rear axle ratio: 4.78:1
S	S	S	S	Receiver hitch - 18,000 lb. rated
	S	S(40&42)	S	Remote battery jumper terminals
S	S	S	S	Suspension: Firestone air springs,
	S	S(40-42)	S	Tag axle, lifting
S	S	S		Michelin Tires: 295/80R22.5
			S	Michelin Tires: 315/80R22.5
S	S	S	S	Transmission oil cooler

DASH / COCKPIT

DASH & COCKPIT

Nimbus XT	Nimbus SE	Nimbus CE	Phenix	
S	S	S	S	12 volt accessory receptacle
S	S	S	S	Battery boost switch
S	S	S	S	Camera, motorized back-up with control at dash
S	S	S	S	Cameras, mirror mount with color back-up monitor
S	S	S	S	CB at dash, hand held
S	S	S	S	Compass and outdoor temperature
S				Co-pilot seat, Villa leather 6 way power with footrest
opt	S	S	S	Co-pilot seat, Villa residential 6 way power w/footrest & headrest
S	S	S	S	Cruise control with dash indicator light
S	S	S	S	Dash AC controls for co-pilot
S	S	S	S	Driver and passenger drink holder
S	S	S	S	Entry flooring, hard surface
S	S	S	S	Gauges, backlit analogue
S	S	S	S	Generator auto start/stop
S	S	S	S	GPS/AM/FM/CD in dash (w/ xm sat. radio)
S	S	S	S	Illuminated dash panel
opt	opt	opt	S	Monitor, passenger satellite/GPS
S	S	S	S	Map lights, pilot & copilot
S	S	S	S	MP3 input at dash
S	S	S	S	Pedals, throttle & brake adjustable
S	S	S		Pilot seat, Villa leather 6-way power
			S	Pilot seat, Villa leather 6-way power with air ride
	opt	opt	opt	Silverleaf digital glass dash
opt	opt	opt	S	Silverleaf VMS 440 (eng./trans. monitor)
S	S	S	S	Steering wheel, tilt and telescoping
S	S	S	S	Steering wheel, wood look Smart wheel
S	S	S	S	Transmission gear selector, touch-pad
S	S	S	S	Windshield / privacy shade, electric
S	S	S	S	Windshield wipers, synchronized
S	S	S	S	Windshield, shade band at top

EXTERIOR FEATURES**EXTERIOR FEATURES**

Nimbus-XT	Nimbus-SE	Nimbus-CE	Phenix	
S	S	S	S	Auxiliary rear brake lights and turn signals
opt	opt	opt	opt	Awning, Girard electric entry door
1	1	1	2	Awning, Girard roof-mounted electric patio,
opt (1-38/40)	S(3-40/42)	S(1-38, 3-40/42)	S	Awning, Girard shells
opt	opt	opt	opt	Awnings, Girard electric window
opt	opt	opt	opt	Awnings, Zip Dee manual window
1	1	1	1	Cargo tray, sliding
opt	opt	opt	opt	Cargo tray, sliding, electric

Nimbus-XT	Nimbus-SE	Nimbus-CE	Phenix	
S	S	S	S	Carpeted storage bays
opt	opt	S	S	Chairs, folding patio (2)
opt	opt	opt	S	Paint protection below windshield
S	S	S	S	Consolidated components bay
S	S	S		Docking lights, (4) with switch in dash
			S	Docking lights, (4) with switch in dash & bedroom
S	S	S	S	Dual halogen headlamps
S	S	S	S	Dual-pane tinted & insulated windows
S	S	S	S	Easy view one-piece windshield
S	S	S	S	Electric dump valves
S	S	S		Electric entry box step
			S	Electric entry step (Executive)
S	S	S	S	Electric utility reels
S	S	S	S	Fiberglass roof & sub floor (one-piece)
S	S	S	S	Flush kit
S	S	S	S	Fog lights
opt	opt	opt	opt	Freezer, 100lb in storage bay
S	S	S	S	Fuel fill - on both sides of coach
S	S	S	S	Gray water bypass for holding tank
S	S	S	S	Heated/remote triple head chrome mirrors w/LED turn signals
S	S	S	S	Hidden air horns
S	S	S	S	Lighted entry door with assist handle, keypad, & doorbell
S	S	S	opt	LP connection
S	S	S	S	Fresh water plumbing supply manifold
	S	S	S	Marker lights, LED
S	S	S	S	Mud flaps
S	S	S	S	Painted exterior, full body paint with clear coat finish
S	S	S	S	Parallel storage doors, (new style)
S	S	S	S	Porch light
S	S	S	S	PTL entry door with screen and kick guard
S	S	S	S	Remote storage door locks
S	S	S	S	Roof AC drains
		S	S	Stainless steel lined utility bay
S	S	S	S	Storage bay lights
S	S	S	S	Trailer wiring
S	S	S	S	TV antenna - electric with booster
S	S	S	S	TV outlet and 12v outlet in storage bay
S	S	S	S	Utility station: Fresh water connection, 50 amp shoreline connection, hot and cold water faucet, soap dispenser, cable TV, phone connection, paper towel holder, water pump switch, water fill switch, 120v receptacle
	opt	S	S	Xenon low beam headlights

APPLIANCES/ELECTRONICS/LIGHTING/AUDIO VIDEO

APPLIANCES/ELECTRONICS/LIGHTING/AUDIO VIDEO

Nimbus XT	Nimbus SE	Nimbus CE	Phenix	
S	S	S	S	Alarm Clock, built in
opt	opt	opt	opt	Battery charger, solar
opt	opt	opt	opt	Cellular antenna, digital
S	S	S	S	Component audio and digital video cables
opt	opt	opt	S	Cook top, 2-burner electric
S	S	S	opt	Cook top, 2-burner LP w/electronic ignition, recessed
S	S	S	S	Home theater system in LR w/ Anthony Gallo Speakers
			S	Blu-ray High Def. DVD
S	S	S		DVD Player
S	S	S	S	Inverter/power monitor panel in living room area
opt	S	S	S (+ valances)	Lighting, accent under counters
S	S	S	S	Lighting, floor lights
S	S	S	S	Lighting, in cabinet below kitchen sink
S	S	S	S	Lighting, Halogen reading lamps in bedroom
S	S	S	S	Microwave, GE Advantium (black)
2	2	2		MX900 Universal remote
	opt	opt	2	MX950/980 Universal remote
	opt	opt	S	Refrigerator, 120v electric w/ice & water in door
S	S	S	opt (14 cu ft)	Refrigerator, Dometic side-by-side 12 cu. ft
S	S	S	S	Satellite radio, XM (Phenix includes 18month subscription)
S	S	S		Satellite system, in motion w/HD receiver
opt	opt	opt	S	Satellite system, in motion w/HD DVR receiver
opt	opt	opt	S	Satellite system, 2nd HD receiver
			S	Siverleaf Total Coach monitor
S	S	S	S	Tire Pressure Sensors, Remote
S	S	S		TV 23" LCD w/DVD in bedroom
			S	TV 32" LCD w/DVD in bedroom
S	S	S		TV 37" LCD in living room
	opt(FD)	opt(FD)	S	TV 42" LCD in living room
S	S	S	S	TV antenna - electric with booster
S	S	S	S	Washer/dryer connections

LIVABILITY**LIVABILITY**

Nimbus XT	Nimbus SE	Nimbus CE	Phenix	
S	S	S	S	Powered step-well cover with two switch locations
S	S	S	S	Brushed nickel cabinet hardware
opt	opt	opt	opt	Calap-Z-Table
S	S	S	S	China toilet

Nimbus XT	Nimbus SE	Nimbus CE	Phenix	
S	S	S	S	Color-coordinated throw pillows (sofa & bed)
S	S	S	S	Concealed door hinges
S	S	S	S	Designer kitchen faucet with pullout sprayer
S	S	S		Designer window treatment with day/night shades
	opt	opt	S	Designer window treatment with electric shades
panel-frame	raised panel	RP (40-42) panel frame 38	raised panel	Doors, interior
S	S	S	S	Electric Fantastic fan in bath & toilet room w/auto rain sensor
S	S	S	S	Filter, drinking water & ice maker water
S	S	S	S	Floor-to-ceiling wallpaper and chair rail
	opt	opt (40-42)	S	Floor Heat, electric (with approved flooring)
S	S	S	S	Kitchen pantry
				Lighting, Intellitec multiplex system
S	S	S	S	Lighting, Intellitec multiplex system with dimmers
S	S	S	S	Magazine rack and drink holder at co-pilot seat
S	S	S	S	Queen bed (60" x 77") (66" x 77" floorplan dependent)
S(FD)	S(FD)	S(FD)	S(FD)	Recliner
opt	opt	opt	opt	Shower foot rest
S	S	S	S	Showerhead slider
			S	Sink, vessel lavatory sink
S	S	S	S	Skylight above shower
S	S	S	S	Slide-out rooms, flush with sidewalls when retracted
S	S	S	S	Slide-out rooms, pneumatic sealed
S	S	S	S (Silestone)	Solid surface countertops (kitchen and bath)
S	S	S	S (Silestone)	Solid surface desktop (floorplan dependent)
S	S	S	S (Silestone)	Solid surface dinette table
	S	S	S (Silestone)	Solid surface nightstand tops
?				Solid wood bedroom countertops
S	S	S	S	Stainless steel kitchen sink w/covers
S	S	S	S	Storage under entry step
S	S	S	S	Telephone jack in living area and bedroom
	S (40-42)	S (40-42)	S	Tile floor (kit, bath, living room, D & P area)
S		S (38)		Resilient ceramic tile (vinyl) (bath, D & P area)
S	S	S	S	Vacuum, built in
opt	opt	opt	opt	Washer dryer combination
	opt (FD)	opt (FD)	opt (FD)	Washer dryer, stacked
S	S	S	S	Wood, handcrafted cherry, walnut or maple cabinetry
			opt	Wood, Bubinga
		opt	opt	Wood, African Mahogany

SAFETY**SAFETY**

Nimbus XT	Nimbus SE	Nimbus CE	Phenix	
S	S	S	S	All coaches built to RVIA specifications

Nimbus XT	Nimbus SE	Nimbus CE	Phenix	
S	S	S	S	Carbon monoxide detector
S	S	S	S	Daytime running lights
S	S	S	S	Drive and passenger 3-point seat belts & shoulder harnesses
S	S	S	S	Emergency flasher lights
S	S	S	S	Fire extinguishers (2)
S	S	S	S	GFI protected circuits
S	S	S	S	High-mounted additional brake lights
S	S	S	S	Interior exit-assist handle
S	S	S	S	Lighted entry-door assist handle
S	S	S	w/LP opt.	LP leak detector
S	S	S	S	Polarity meter/monitor - 120v
S	S	S	S	Electronic Safe
S	S	S	S	Security system
S	S	S	S	Smoke detector

HEATING/COOLING/ELECTRICAL

HEATING/COOLING/ELECTRICAL

Nimbus XT	Nimbus SE	Nimbus CE	Phenix	
S(36-38)		S(36-38)		10kw diesel generator in quiet box
S(40)	S	S(40-42)	S	12.5kw diesel generator in quiet box
S	S	S	S	12 volt battery disconnect
S		S(36-38)		2000 w inverter/charger
	S	S (40/42)	S	2800 w inverter/charger
S	S	S	S	50 amp shoreline connection
S	S	S	S	Air conditioning and heating with hidden returns
S(36-38)		S(36-38)		Air conditioning, ducted with 2 roof airs
S(40)	S(40-42)	S(40-42)	S(40-42)	Air conditioning, ducted with 3 roof airs
			S(45)	Air-conditioning, ducted with 4 roof airs
S	S	S	S	Auto temp. start for generator
S	S	S	S	Electrical surge-suppression system
S	S	S	S	Heat pumps on roof AC's
S				Hydronic heating with galvanized steel housing
	S	S	S	Hydronic heating with stainless steel housing
S	S	S	S	Low-battery generator auto-start

From: <https://wiki.foreforums.com/> - Foretravel Wiki

Permanent link: https://wiki.foreforums.com/through_the_years:specs:2009

Last update: 2024/08/04 15:30

