

# Media

## Photos



## Brochures

**Foretravel** MOTORHOME**SPECIFICATIONS**

The **Foretravel** motorhome is available in many lengths. Here we show the most typical, and, we think, the best, interior arrangement for maximum usage and livability. However, one of the many advantages we offer is the ability to provide flexible interior design to meet special needs. This fact will also prove attractive to companies and corporations who may have need of a traveling laboratory, a sales showcase to drive from market to market, or a mobile hospitality center set up for conventions and sales meeting. The limit is almost with your imagination. Whatever the need . . . go advanced, go **Foretravel** : what a way to go!



FORETRAVEL 26LR



FORETRAVEL 31RBV



FORETRAVEL 31RB



FORETRAVEL 33SB

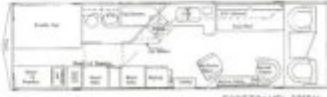

FORETRAVEL 33SBV

# Specifications

## 1975 Foretravel

### Models

MODEL NO.	WHEEL BASE	RETAIL
Foretravel 26LR Super Luxura	178"	\$29,995
Foretravel 31RB Super Luxura	206"	\$35,995
Foretravel 31RBV Super Luxura	206"	\$35,995
Foretravel 33SB Super Luxura	206"	\$38,995
Foretravel 33SBI Super Luxura	206"	\$38,995
Foretravel 33SB Diesel Super Luxura	206"	\$52,995
Foretravel 33SBI Diesel Super Luxura	206"	\$52,995
Foretravel 31RB FTX	206"	\$38,995
Super Luxura FTX	206"	\$38,995
Foretravel 33SB FTX	206"	\$41,995
Foretravel 33SBI FTX	206"	\$41,995

CODE	DESCRIPTION
LR	
RB	REAR BATH
RBV	REAR BATH VANITY
SB	SIDE BATH, TWIN BEDS
SBI	SIDE BATH, ISLAND BED



All base prices are based on Dodge with 450 cu. in. engine and 100 gal. gasoline tank. Built on Chevrolet or Dodge Chassis, also certain types custom work priced on request

## Features

### **AUTOMOTIVE**

- 440 cubic inch Engine (plus Diesel and others)
- Heavy Duty Transmission
- Heavy duty radiator
- 200 amp. hour battery (Coach)
- 100 amp. hour battery (Engine)
- 200 amp. hour battery (Engine) on Diesel
- Battery isolator
- 100 gal. fuel tank
- Power brakes
- Power Steering
- Dual wipers & washers
- Tinted glass
- Bus type Windows
- Wheel Covers
- Cruise control
- Chrome bumpers
- Heavy Duty hitch

### **LIVABILITY**

- Real Wood Paneling
- Deluxe Carpet
- 10 Cubic ft Refrigerator/Freezer
- 4 Burner Range
- Eye Level Oven
- Electric Clock
- Tub & Shower
- Flexsteel Recliner & Swivel Chair
- Flexsteel Sofa
- Swing Down Double Bunk
- Am/FM Stereo Radio & Tape Deck
- Ice Maker
- Food Blender
- Built in Bar
- TV Antenna with 2 jacks, 1 jack on 26LR
- Built in Vacuum Cleaner

### **SAFETY**

- Steel chassis
- Steel cage
- 1 1/2" Block Insulation
- Seat belts
- Emergency flashers

- Tinted safety glass
- Fire extinguisher
- Flare kit
- Back-up lights

## **ELECTRICAL**

- 110 volt/ 12 volt automatic changeover
- 40 Amp. converter
- 6.5 K.W.Auxiliary Power on 31' and 33' models
- 4 K.W.Auxiliary Power on 26 LR

## **HEATING/COOLING**

- 40,000 BTU Auto heat/ def.
- 35,500 BTU Ducted furnace
- 13,500 Roof A/C - 2 ea. on 31' and 33' models
- 1 on 26' Model
- 16,000 BTU Auto A/C

## **CONVENIENCE**

- 70 gal. water capacity 31' and 33' models
- 46 gal. water capacity on 26' Model
- 30 & 63 gal. dual waste tanks on 31' and 33' Models
- 2 - 30 gal. dual Waste Holding Tanks on 26' Model
- 88 lb. LPG tank
- System Monitor
- Weather Station
- Large exterior storage
- Large interior storage

## **Special Standard Features on FTX Models**

- Fiberglass Sidewalls
- Microwave Oven
- Electric Step
- CB Radio
- Sink and Stove Covers
- Motor Aid Hot water Heater
- Laundry Chute
- Heat Strips in Roof A/C's
- Steering Stabilizer

## **OPTIONS**

OPTION	RETAIL
Combo Bunks - Rear	\$213

OPTION	RETAIL
Water Purifier	\$99
Pedestal Table Rear	\$60
Tint Shades	\$80
Thermasan BL	\$699
Recirculating Toilet	\$157
Steering Stabilizer	\$163
Custom Factory Pickup	\$150
Microwave Oven	\$375
Color TV	\$350
Bar (Exchange for Swivel Chair)	\$500
Fiberglass Side Walls	\$800

From:

<https://wiki.foreforums.com/> - **ForeForums Foretravel Motorcoach Wiki**

Permanent link:

[https://wiki.foreforums.com/doku.php?id=through\\_the\\_years:1975](https://wiki.foreforums.com/doku.php?id=through_the_years:1975)

Last update: **2021/03/10 12:31**

