

Media

Photos





Brochures

	GRAND VILLA OSHKOSH REAR ENGINE DIESEL (R15D)
OPTIONS	
Advanced Electronics Package	\$5221
Computer screen system monitor *	\$975
Cloud screen back-up camera	\$1575
1300 watt inverter system	\$2600
Audio 1150 Cassette System	\$475
* Note: Computer screen required if rear camera is ordered	
Awning Package I	\$1665
Window awnings covering four windows	\$514
Fabric awning	\$475
Two matching chairs	\$133
Awning Package II	\$1854
Window awnings covering five windows	\$1330
Fabric awning	\$475
Two matching chairs	\$133
Awning Package III	\$2044
Window awnings covering six windows	\$1236
Fabric awning	\$475
Two matching chairs	\$133
Convenience Package	\$3852
Roof rack	\$400
Hockey air horns	\$990
LP connections for 10" 6-1/2" burner	\$50
Docking lights (2 Sets)	\$215
Solar lightery charges	\$250
Fire resistant safe	\$363
TV/CVCR (hardwired)	\$1115
AM/FM Cassette (hardwired)	\$530
Deluxe Kitchen Package	\$478
High rise faucet	\$130
Island hot water dispenser	\$115
Mixer	\$233
Luxury Package	\$1092
Carpet Flooring (Kitchen only)	\$302
Sealed shoe locker	\$120
Perforated entrance door lighted main handle	\$35
Power Package	\$4327
110V automatic pads	\$2685
Power generator and heated mirrors	\$275
Power D&P seats	\$600
Cellular antenna	\$55
Sound Option	\$975
Sony Compact Disc Player/Charger	\$975
Winterizing Package	\$630
Hot tap water lines	\$510
Heat blower under each tank (110V)	\$120

[illegible]

Foretravel, inc.

MOBIPHONES OF DISTINCTION

GRAND VILLA

OSHKOSH REAR ENGINE GAS

OPTIONS

Advanced Electronics Package	\$5221	
Computer system (includes monitor)		\$955
Computer control hook-up system		\$200
1500 watt inverter system		\$2000
Audio 1150 Clinical system		\$475
* Note: Computer system required if rear camera is desired		
Awning Package I	\$1665	
Window awnings covering four windows		\$824
Patio awning		\$876
Two matching chairs		\$118
Awning Package II	\$1854	
Window awnings covering five windows		\$1090
Patio awning		\$876
Two matching chairs		\$118
Awning Package III	\$2044	
Window awnings covering six windows		\$1236
Patio awning		\$876
Two matching chairs		\$118
Convenience Package	\$3852	
Roof rack		\$418
Radio or hi-fi stereo		\$190
27 connections for 16-1/2" D.C.		\$74
Docking lights (2-540)		\$72
Solar battery charger		\$154
Five passport safe		\$303
T.V. & K. (bedroom)		\$175
A44PM4 cassette (bedroom)		\$119
Deluxe Kitchen Package	\$478	
High rise faucet		\$331
Instant hot water dispenser		\$115
Blender		\$32
Luxury Package	\$1092	
Parquet flooring (kitchen only)		\$1852
Scuffed china table		\$130
Removable entrance door lighted exit handle		\$10
Power Package	\$4327	
110V automatic lock		\$505
Power windows and heated mirrors		\$275
Power CDP seats		\$150
Cellular antenna		\$75
Sound Option	\$975	
Sony Compact Disc Player/Changer		\$975
Winterizing Package	\$630	
Heat tape water lines		\$150
Heat blanket under each tank (1100)		\$135

[illegible]

[illegible][illegible]

3600 Grand Villa
OSHKOSH REAR ENGINE DIESEL

3600 GVF OREG SBI

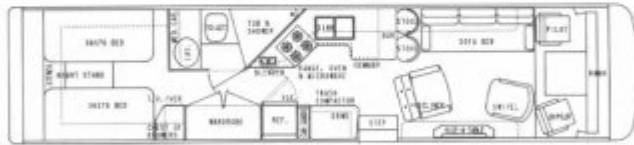

3600 GVF OREG SB

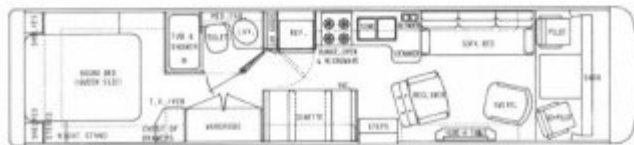

3600 GVF OREG SBI DINETTE

3600 Grand Villa
OSHKOSH REAR ENGINE GAS

3600 GVF OREG SBI



3600 GVF OREG SB

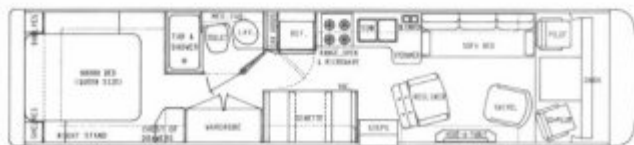

3600 GVF OREG SBI DINETTE



Specifications

1991 Grand Villa U300

Models

MODEL NO	WHEEL BASE	RETAIL
Foretravel Grand Villa 3600	228"	\$295,000
Foretravel Grand Villa 3800	252"	\$302,500
Foretravel Grand Villa 4000	276"	\$310,500
Model number denotes approx. length		
CODE	DESCRIPTION	
SB	SIDE BATH, TWIN BEDS	
SBI	SIDE BATH, ISLAND BED	
SAI	SIDE AISLE, ISLAND BED	
SBID	SIDE BATH, ISLAND BED, DINETTE	

Features

AUTOMOTIVE

- (3)-200 amp. hour batteries
- 148 gallon fuel tank
- 160 amp alternator
- 160 amp battery isolator
- 2" square receiver hitch
- 275/80R 225 PXZA Michelin tires
- 8 bag 100% air-ride suspension

- Air disk brakes
- Air hose for tire service
- Allison MTB 648 transmission ATEC
- Cruise control
- DDA Silver 6V92TA DDEC
- Dry air cleaner
- Dual electric wipers & washers
- Engine compartment light
- Engine coolant heater 110V
- Foretravel chassis 30,000 GVWR
- Full instrumentation
- Halogen headlights
- Heavy duty radiator, boiled construction
- Heavy steel bumpers with decorative fascia
- One piece Alcoa aluminum wheels
- Padded automotive-type dash with swing-up top for easy service
- Padded sun visors
- Power steering
- Racor® fuel filter
- Radiator water recovery system
- Transmission oil cooler
- Transmission retarder brake

LIVABILITY

- 1 1/2" block Styrofoam ® insulation
- 20" Stereo TV in living area
- 36×76 Twin beds - SB
- 60×80 queen-size bed - SBI
- 4 burner cooktop with gas Oven
- 40 channel CB radio
- 6-way electric driver seat base
- All wood drawers on full extension ball bearing glides
- AM/FM/cassette stereo in bedroom
- Automatic closet lights
- Built-in 13" color TV & VCR in bedroom
- Built-in vacuum cleaner
- Carpeted overhead cabinets
- Cedar lined wardrobe closet
- Corian® countertops in kitchen & bath Corian® table w/chairs on 4000 SAI & SBID
- Corian lavatory bowl
- Curtains and sheers
- Deadbolt lock
- Deluxe carpet & pad
- Digital alarm clock in bedroom
- Digital clock
- Dometic® AES ref/freezer (except SAI)
- Dometic® AES ref/freezer w/built-in ice maker (SAI only)

- Double stainless steel sink
- Electronic AM/FM/cassette w/seek & scan
- Exterior cable TV hookup
- Eye level microwave/convection oven
- Fiberglass underskin
- Floor level night lights
- Florescent lighting throughout
- Full screen door
- Generator switch in bedroom & cockpit
- Ice maker (except SAI models)
- Large bath/shower & tub combination
- laundry bag on SAI model
- lavatory drawer
- Lighted vanity with mirror
- Motor-aid water heater / electronic ignition
- One piece fiberglass roof and sidewalls
- Porch & entry lights with touch switch
- Power ceiling vent in bath area
- Real wood paneling
- Recliner & swivel chair
- Reclining pilot & co-pilot seats
- Slide-out pantry on SBI
- Slide-out console table
- Sofa bed
- Thermostatically controlled fresh air ventilator
- Three point compartment door latches
- Trash compactor (except on 3600 & 3800 dinette models)
- TV antenna with booster
- Wall mounted clock
- Wardrobe dressing mirrors
- Washer/dryer connections on 4000 Series
- Water pump switch in bath & kitchen
- Water purifier

ELECTRICAL

- 110 volt automatic changeover
- 110 voltmeter & polarity meter
- 1500 watt inverter
- 50 Amp. shoreline
- 15 K.W. generator/diesel fueled
- 75 Amp. converter-charger
- Master battery disconnect switch
- Trailer wiring

SAFETY

- Back-up lights

- Back-up monitor
- Docking lights
- Emergency exit side windows
- Emergency flashers
- Entry door hand rail
- Fire extinguisher
- Halogen fog lights
- Large outside remote mirrors with wide angle vision, heated
- LP gas leak detector
- Park lights
- Retractable seat belts
- Self-canceling directional signal lights
- Smoke detector
- Steel cage with aluminum roof frame
- Tinted safety glass
- Warning triangle reflector kit

HEATING/COOLING

- 17,250 BTU auto/AC
- 35,000 BTU auto heat/def.
- (2)-35.000 BTU ducted furnaces with electronic ignition
- (35,000 + 16.000 on 3600 series)
- (2)-13.500 BTU roof AC with heat strips

CONVENIENCE

- 110 gal. gray water capacity
- 54 gal. black water capacity
- 102 gallon water capacity
- 2 gallon pre-charged water accumulator
- 77" interior height
- 110v air compressor
- 270 lb. LPG tank
- Air leveling system
- Antenna warning
- Automatic air step
- Computer screen systems monitor
- Conveniently located dump hose & valves
- Doorbell
- Dual Hadley air horns
- Exterior 110 v outlet
- Glove box
- Large bus type belly storage
- large interior storage
- Map lights for pilot & co-pilot
- Pilot & co-pilot ducted fan system
- Remote searchlight

- Roof mounted rack and ladder
- Safe
- Storage compartment lights
- Telephone jack

1991 Grand Villa U280

Models

MODEL NO		WHEEL BASE	RETAIL
Foretravel Grand Villa 3600		228"	\$255,500
Foretravel Grand Villa 3800		252"	\$264,500
Foretravel Grand Villa 4000		276"	\$278,500
CODE	DESCRIPTION		
SB	SIDE BATH, TWIN BEDS		
SBI	SIDE BATH, ISLAND BED		
SAI	SIDE AISLE, ISLAND BED		
SBID	SIDE BATH, ISLAND BED, DINETTE		

Features

AUTOMOTIVE

- (2)-200 amp. hour batteries
- 8 bag 100% air-ride suspension
- 148 gallon fuel tank
- 160 amp alternator
- 160 amp battery isolator
- 2" square receiver hitch
- 275/80R 223 PXZA Michelin tires
- Air disk brakes
- Air hose for tire service
- Allison MT643 transmission
- Caterpillar 3208T 250 H.P.
- Cruise control
- Dry air cleaner
- Dual electric wipers & washers
- Engine compartment light
- Engine coolant heater - 110v
- Foretravel chassis 28,000 GVWR
- Full instrumentation
- Halogen headlights
- Heavy duty radiator, bolted construction
- Heavy duty bumpers with decorative fascia

- One piece Alcoa* aluminum wheels
- Padded automotive-type dash with swing-up top for easy service
- Padded sun visors
- Power steering
- Racor® fuel filter
- Radiator water recovery system
- Transmission oil cooler

LIVABILITY

- 1 1/2" block Styrofoam ® insulation
- 20" Stereo TV in living area
- 36×76 Twin beds - SB
- 4 burner cooktop with gas oven
- 40 channel CB radio
- 6-way electric driver seat base
- 60×80 queen-size bed - SBI
- All wood drawers on full extension ball bearing glides
- AM/FM/cassette stereo in bedroom
- Automatic closet lights
- Built-in 13' color TV & VCR in bedroom
- Built-in vacuum cleaner
- Carpeted overhead cabinets
- Cedar lined wardrobe closet
- Corian ® countertops in kitchen & bath
- Corian ® table w/chairs on 4000 SAI & SBID
- Corian ® lavatory bowl
- Curtains and sheers
- Deadbolt lock
- Deluxe carpet & pad
- Digital alarm clock in bedroom
- Digital clock
- Dometic® AES ref/freezer (except SAI)
- Dometic® AES ref/freezer w/built-in icemaker (SAI only)
- Double stainless steel sink
- Electronic AM/FM/cassette with seek & scan
- Exterior cable TV hookup
- Eye level microwave/convection oven
- Fiberglass underskin
- Floor level night lights
- Fluorescent lighting throughout
- Full screen door
- Generator switch in bedroom & cockpit
- Ice maker (except SAI models)
- Large bath/shower & tub combination
- Laundry bag on SAI model
- Lavatory drawer
- Lighted vanity with mirror

- Motor-aid water heater with electronic ignition
- One piece fiberglass roof and sidewalls
- Porch & entry lights with touch switch
- Power ceiling vent in bath area
- Real wood paneling
- Recliner & swivel chair
- Reclining pilot & co-pilot seats
- Slide-out pantry on SBI
- Slide-out console table
- Sofa bed
- Thermostatically controlled fresh air ventilator
- Three-point compartment door latches
- Trash compactor except on 3600 series dinette models
- TV antenna with booster
- Wall mount clock
- Wardrobe dressing mirrors
- Washer/dryer connections on 4000 series
- Water pump switch in bath & kitchen
- Water purifier

ELECTRICAL

- 110 volt automatic changeover
- 110 voltmeter & polarity meter
- 50 Amp. shoreline
- 6.3 K.W. generator/LP. fuel
- 75 Amp. converter-charger
- Master battery disconnect switch
- Trailer wiring

SAFETY

- Back-up lights
- Back-up monitor
- Docking lights
- Emergency exit side windows
- Emergency flashers
- Entry door hand rail
- Fire extinguisher
- Halogen fog lights
- Large outside remote mirrors with wide angle vision, heated
- LP gas leak detector
- Park lights
- Retractable seat belts
- Self-canceling directional signal lights
- Smoke detector
- Steel cage with aluminum roof frame
- Tinted safety glass

- Warning triangle reflector kit

HEATING/COOLING

- 17,250 BTU auto/AC
- 35,000 BTU auto heat/def.
- (2)-13,500 BTU roof AC with heat strips
- (2)-35,000 BTU ducted furnaces with electronic ignition (16,000 + 35,000 on 3600 series)

CONVENIENCE

- 110 gal. gray water capacity
- 54 gal. black water capacity
- 102 gallon water capacity
- 2 gallon pre-charged water accumulator
- 77" interior height
- 110 v air compressor
- 2701b. LPG tank
- Air leveling system
- Antenna warning
- Automatic air step
- Computer screen systems monitor
- Conveniently located dump hose & valves
- Doorbell
- Dual Hadley® air horns
- Exterior 110v outlet
- Glove box
- Large bus type belly storage
- Large interior storage
- Map lights for pilot & co-pilot
- Pilot & co-pilot ducted fan system
- Remote searchlight
- Roof mounted rack and ladder
- Safe
- Storage compartment lights
- Telephone jack

1991 Grand Villa U225

Models

MODEL NO		WHEEL BASE	RETAIL
Grand Villa 3600		228"	\$172,500
Model number denotes approx- length			
CODE	DESCRIPTION		
SB	SIDE BATH, TWIN BEDS		

CODE	DESCRIPTION
SBI	SIDE BATH, ISLAND BED
SBID	SIDE BATH, ISLAND BED, DINETTE

Features

AUTOMOTIVE

- (2)-200 amp. hour batteries
- Velvet Ride Torsilastic® Suspension
- 100 gallon fuel tank
- 160 amp alternator
- 160 amp battery isolator
- 2" square receiver hitch
- 235/80 R 22.5 TXZU4 Michelin® tires
- Air brakes
- Air hose for tire service
- Allison MT 643 transmission
- Cummins 6BTA5.9 230 H.P.
- Cruise control
- Dry air cleaner
- Dual electric wipers & washers
- Engine compartment light
- Engine coolant heater - 110v
- Foretravel chassis 22,500 GVWR
- Full instrumentation
- Halogen headlights
- Heavy duty radiator; bolted construction
- One piece Alcoa® aluminum wheels
- Padded automotive-type dash with swing-up top for easy service
- Padded sun visors
- Power steering
- Racor® fuel filler
- Radiator water recovery system
- Stainless steel bumpers
- Transmission oil cooler

LIVABILITY

- 1 1/2" block Styrofoam® insulation
- Built in 13" color TV over dash
- 60x80 queen-size bed - SBI
- 36x76 Twinbeds-SB
- 4 burner cooktop with gas oven
- 40 channel CB radio
- 6-way electric driver seat base
- All wood drawers on full extension ball bearing glides

- Automatic closet lights
- Built-in vacuum cleaner
- Carpeted overhead cabinets
- Cedar lined wardrobe closet
- Corian® countertops in kitchen & bath
- Cori3nS table w/chairs on SBID
- Curtains and sheers
- Deadbolt lock
- Deluxe carpet & pad
- Digital alarm clock in bedroom
- Digital clock
- Dometic® AES ref/freezer
- Double stainless steel sink
- Electronic AM/FM/cassette with seek & scan
- Exterior cable TV hookup
- Eye level microwave/convection oven
- Fiberglass underskin
- Floor level night lights
- Fluorescent lighting throughout
- Full screen door
- Generator switch in bedroom & cockpit
- Ice maker
- Large bath/shower & tub combination
- Lighted vanity with mirror
- Motor-aid water heater with electronic ignition
- One piece fiberglass roof and sidewalls
- Porch & entry lights with touch switch
- Power ceiling vent in bath area
- Real wood paneling
- Recliner & swivel chair
- Reclining pilot & co-pilot seats
- Slide-out pantry on SBI
- Sofa bed
- Thermostatically controlled fresh air ventilator
- Trash compactor except on dinette model
- TV antenna with booster
- Wall mount clock
- Wardrobe dressing mirrors
- Water pump switch in bath & kitchen
- Water purifier

ELECTRICAL

- 110 volt automatic changeover
- 110 voltmeter A polarity meter
- 50 Amp. shoreline
- 6.5 K.W. generator/L-P. fuel
- 75 Amp. converter-charger

- Master battery disconnect switch
- Trailer wiring

SAFETY

- Back-up lights
- Docking lights
- Emergency exit side windows
- Emergency flashers
- Entry door hand rail
- Fire extinguisher
- Halogen fog lights
- LP gas leak detector
- Large outside mirrors with angle vision, and turn signals
- Park lights
- Retractable seat belts
- Self-canceling directional signal lights
- Smoke detector
- Steel cage with aluminum roof frame
- Tinted safety glass
- Warning triangle reflector kit

HEATING/COOLING

- 17,250 BTU auto/AC
- 35,000 BTU auto heat/def.
- (2)-13^00 BTU roof AC with heat strips
- (2)-Ducted furnaces with electronic ignition (16,000 and 35.000 BTU)

CONVENIENCE

- 85 gal. gray water capacity
- 40 gal. black water capacity
- 1741b. LPG tank
- 77" interior height
- 88 gallon water capacity
- 2 gallon pre-charged water accumulator
- HWH leveling system
- Electronic system monitor
- Conveniently located dump hose & valves
- Doorbell
- Dual Hadley air horns
- Exterior 110 v outlet
- Glove box
- Large bus type belly storage
- Large interior storage
- Map lights for pilot & co-pilot
- Pilot & co-pilot ducted fan .-system

- Remote searchlight
- Roof mounted rack and ladder
- Safe
- Storage compartment lights
- Telephone jack

1991 OREG Grand Villa 3400, 3600

Models

MODEL NO	WHEEL BASE	RETAIL
Grand Villa 3400	204"	\$145,000
Grand Villa 3800	228"	\$148,500
OSHKOSH Rear Engine Gas		
Model number denotes approx length		
CODE	DESCRIPTION	
SB	SIDE BATH, TWIN BEDS	
SBI	SIDE BATH, ISLAND BED	
SBID	SIDE BATH, ISLAND BED, DINETTE	

Features

AUTOMOTIVE

- 100 gallon fuel tank
- 2" square receiver hitch
- 200 Amp. hour battery - coach
- 9R 22.5 Michelin ® tires (lubeless)
- Battery isolator
- Cruise control
- Dry air cleaner
- Dual electric wipers & washers
- Engine compartment light
- Ford 460 V8 engine
- Ford C-6 automatic transmission
- Full instrumentation
- Halogen headlights
- Heavy duty alternator
- Heavy duty radiator
- One piece Alcoa ® aluminum wheels
- Oshkosh V-814 18,000 GVWR chassis
- Padded automotive-type dash with swing-up top for easy service
- Padded sun visors
- Power disc brakes

- Power steering
- Radiator water recovery system
- Stainless steel bumpers
- Transmission oil cooler

LIVABILITY

- 1 1/2" block Styrofoam insulation
- 36×76 Twin beds-SB
- 4-burner cooktop with gas oven below
- 40 channel CB radio
- 60×80 queen-size bed - SBI
- All wood drawers on full extension ball bearing glides
- Automatic closet lights
- Built-in 13" color TV over dash
- Built-in breakfast bar with bench 3600 series except SBID
- Built-in vacuum cleaner
- Carpeted overhead cabinets
- Cedar lined double wardrobe closet
- Corian ® countertops in kitchen & bath
- Corian ® table w/chairs on SBID
- Curtains and sheers
- Deadbolt lock
- Deluxe carpet & pad
- Digital alarm clock in bedroom
- Digital clock
- Dometic AES ref/freezer
- Double stainless steel sink
- Electronic AM/FM/cassette w/seek & scan
- Exterior cable TV hookup
- Eye level microwave/convection oven
- Fiberglass underskin
- Floor level night lights
- Fluorescent lighting throughout
- Pull screen door
- Generator switch in bedroom & cockpit
- Ice maker
- Large bath/shower & tub combination
- Lavatory drawer - SB, SBI
- Lighted vanity with mirror
- Motor-aid water heater with electronic ignition
- One piece fiberglass roof & sidewalk
- Porch & entry lights w/touch switch
- Power ceiling vent in bath area
- Real wood paneling
- Recliner & swivel chair
- Reclining pilot & co-pilot seats
- Slide-out pantry

- Slide-out console table & drawer
- Sofa bed
- Thermostatically controlled fresh air ventilator
- Trash compactor - 3600 series except SBID
- TV antenna with 2 jacks
- Wall mounted clock
- Wardrobe dressing mirrors
- Water pump switch in bath & kitchen
- Water purifier

ELECTRICAL

- 110 volt automatic changeover
- 110 voltmeter & polarity meter
- 50 Amp. shoreline
- 7.0 K.W. generator
- 75 Amp. converter-charger
- Master battery disconnect switch
- Trailer wiring

SAFETY

- Back-up beeper
- Back-up lights
- Emergency exit side windows
- Emergency flashers
- Entry door hand rail
- Fire extinguisher
- Halogen fog lights
- Impact switch for emergency fuel pump shut down
- large outside mirrors with wide angle vision, turn signals
- LP gas leak detector
- Park lights
- Retractable seat bells
- Self-canceling directional signal lights
- Smoke detector
- Steel cage with aluminum roof frame
- Steel chassis
- Tinted safety glass
- Warning triangle reflector kit

HEATING/COOLING

- 17,250 BTU auto AC
- 35.000 BTU auto heat/def.
- (2)-13,500 BTU roof AC with heat strips
- (2) Ducted furnaces with electronic ignition (16.000 & 35.000 BTU)

CONVENIENCE

- 100 lb. LPG tank
- 38 and 44 gallon waste tanks (3400)
- 60 and 75 gallon waste tanks (3600)
- 77" interior height
- 88 gallon water capacity
- 2 gallon pre-charged water accumulator
- 90 3/8" interior width
- Antenna warning
- Battery boost switch
- Conveniently located dump hose & valves
- Dual electric trumpet horns
- Electronic systems monitor
- Exterior 110v outlet
- Glove box
- Large exterior storage
- Large interior storage
- LPG access door
- Map lights for pilot & co-pilot
- Pilot & co-pilot ducted fan system
- Remote searchlight
- Roof mounted rack and ladder
- Telephone jack

Options

Advanced Electronics Package	\$5221
Computer screen systems monitor	\$925
Closed circuit back-up camera	\$1675
1500 watt inverter system	\$2600
Audit 1150 Climatic Screen	\$475
Note: Computer screen required if rear camera is ordered	
Awning Package I	\$1665
Window awnings covering four windows	\$824
Patio awning	\$876
Two matching chairs	\$110
Awning Package II	\$1854
Window awnings covering five windows	\$1030
Patio awning	\$876
Two matching chairs	\$110
Awning Package III	\$2044
Window awnings covering six windows	\$1236
Patio awning	\$876
Two matching chairs	\$110

Sound Option	\$975
Sony Compact Disc Player/Changer	\$975
Convenience Package	\$3852
Roof pod	\$410
Hadley air horns	\$390
LP connections for Bar-B-Que	\$94
Docking lights (2 Sets)	\$275
Solar battery charger	\$550
Fire resistant safe	\$383
TV/VCR (bedroom)	\$1575
AM/FM/Cassette (bedroom)	\$510
Deluxe Kitchen Package	\$478
High rise faucet	\$120
Instant hot water dispenser	\$175
Blender	\$225
Luxury Package	\$1092
Parquet Flooring (kitchen only)	\$1032
Sealand china toilet	\$120
Personalized entrance door lighted assist handle	\$35
Power Package	\$4327
HWH automatic jacks	\$3693
Power remote and heated mirrors	\$275
Power D&P seats	\$660
Cellular antenna	\$75
Winterizing Package	\$630
Heat Tape water lines	\$510
Heat blanket under each tank (110v)	\$175

1991 ORED Grand Villa 3400, 3600

Models

MODEL NO	WHEEL BASE	RETAIL
Grand Villa 3400	204"	\$153,500
Grand Villa 3800	228"	\$159,500
OSHKOSH Rear Engine Diesel		
Model number denotes approx length		
CODE	DESCRIPTION	
SB	SIDE BATH, TWIN BEDS	
SBI	SIDE BATH, ISLAND BED	
SBID	SIDE BATH, ISLAND BED, DINETTE	

Features

AUTOMOTIVE

- 100 gallon fuel tank
- (2)- 200 Amp. hour batteries
- 2" square receiver hitch
- 9R225 Michelin ® tires (tubeless)
- Allison AT545 transmission
- Battery isolator
- Cruise control
- Detroit 8.2T V8 engine (210 h.p.)
- Dry air cleaner
- Dual electric wipers & washers
- Engine compartment light
- Full instrumentation
- Halogen headlights
- Heavy duty alternator
- Heavy duty radiator
- One piece Alcoa® aluminum wheels
- Oshkosh V-815 20,500 GVWR chassis
- Padded automotive-type dash with swing-up top for easy service
- Padded sun visors
- Power disc brakes
- Power steering
- Stainless steel bumpers
- Transmission oil cooler

LIVABILITY

- 1 1/2" block Styrofoam® insulation
- 36×76 Twin beds-SB
- 4-burner cooktop with gas oven below
- 40 channel CB radio
- 60×80 queen-size bed -SBI
- All wood drawers on full extension ball bearing glides
- Automatic closet lights
- Built-in 13" color TV over dash
- Built-in breakfast bar with bench 3600 series except SBID
- Built-in vacuum cleaner
- Carpeted overhead cabinets
- Cedar lined double wardrobe closet
- Corian® countertops in kitchen & bath
- Corian® table w/chairs on SBID
- Curtains and sheers
- Deadbolt lock
- Deluxe carpet & pad

- Digital alarm clock in bedroom
- Digital clock
- Dometic AES ref/freezer
- Double stainless steel sink
- Electronic AM/FM/cassette with seek & scan
- Exterior cable TV hookup
- Eye level microwave/convection oven
- Fiberglass underskin
- Floor level night lights
- Fluorescent lighting throughout
- Full screen door
- Generator switch in bedroom & cockpit
- Ice maker
- large bath/shower & tub combination
- Lavatory drawer - SB, SBI
- Lighted vanity with mirror
- Motor-aid water heater with electronic ignition
- One piece fiberglass roof & sidewalls
- Porch & entry lights with touch switch
- Power ceiling vent in bath area
- Real wood paneling
- Recliner & swivel chair
- Reclining pilot & co-pilot seats
- Slide out pantry
- Slide out console table & drawer
- Sofa bed
- Thermostatically controlled fresh air ventilator
- Trash compactor - 3600 series except SBID
- TV antenna with 2 jacks
- Wall mounted clock
- Wardrobe dressing mirrors
- Water pump switch in bath, kitchen
- Water purifier

ELECTRICAL

- 110 volt automatic changeover
- 110 volt meter & polarity meter
- 50 Amp. shoreline
- 6.5 K.W. generator/LP fuel
- 75 Amp. convertor-charger
- Master battery disconnect switch
- Trailer wiring

SAFETY

- Back-up beeper
- Back-up lights

- Emergency exit side windows
- Emergency flashers
- Entry door hand rail
- Fire extinguisher
- Halogen Tog lights
- large outside mirrors with wide angle vision, turn signals
- LP gas leak detector
- Park lights
- Retractable seat belts
- Self-canceling directional signal lights
- Smoke detector
- Steel cage with aluminum roof frame
- Steel chassis
- Tinted safety glass
- Warning triangle reflector kit

HEATING/COOLING

- (2) Ducted furnaces with electronic ignition (16,000 & 35,000 BTU)
- 17,250 BTU auto AC
- 35,000 BTU auto heat/def.
- (2)-13,500 BTU roof AC with heat strips

CONVENIENCE

- 194 lb. LPG tank
- 38 and 44 gallon waste tanks (3400)
- 60 and 75 gallon waste tanks (3600)
- 77" interior height
- 88 gallon water capacity
- 2 gallon pre-charged water accumulator
- Antenna warning
- Battery boost switch
- Conveniently located dump hose & valves
- Dual electric trumpet horns
- Electronic systems monitor
- Exterior 110v outlet
- Glove box
- Large exterior storage
- Large interior storage
- LPG access door
- Map lights for pilot & co-pilot
- Pilot & co-pilot ducted fan system
- Remote searchlight
- Roof mounted rack and ladder
- Telephone jack

Options

Advanced Electronics Package	\$5221
Computer screen systems monitor	\$925
Closed circuit back-up camera	\$1675
1500 watt inverter system	\$2600
Audit 1150 Climatic Screen	\$475
Note: Computer screen required if rear camera is ordered	
Awning Package I	\$1665
Window awnings covering four windows	\$824
Patio awning	\$876
Two matching chairs	\$110
Awning Package II	\$1854
Window awnings covering five windows	\$1030
Patio awning	\$876
Two matching chairs	\$110
Awning Package III	\$2044
Window awnings covering six windows	\$1236
Patio awning	\$876
Two matching chairs	\$110
Sound Option	\$975
Sony Compact Disc Player/Changer	\$975
Convenience Package	\$3852
Roof pod	\$410
Hadley air horns	\$390
LP connections for Bar-B-Que	\$94
Docking lights (2 Sets)	\$275
Solar battery charger	\$550
Fire resistant safe	\$383
TV/VCR (bedroom)	\$1575
AM/FM/Cassette (bedroom)	\$510
Deluxe Kitchen Package	\$478
High rise faucet	\$120
Instant hot water dispenser	\$175
Blender	\$225
Luxury Package	\$1092
Parquet Flooring (kitchen only)	\$1032
Sealand china toilet	\$120
Personalized entrance door lighted assist handle	\$35
Power Package	\$4327
HWH automatic jacks	\$3693
Power remote and heated mirrors	\$275

Power Package		\$4327
	Power D&P seats	\$660
	Cellular antenna	\$75
Winterizing Package		\$630
	Heat Tape water lines	\$510
	Heat blanket under each tank (110v)	\$175

From:

<https://wiki.foreforums.com/> - **ForeForums Foretravel Motorcoach Wiki**

Permanent link:

https://wiki.foreforums.com/doku.php?id=through_the_years:1991

Last update: **2021/03/10 12:31**

