

RAMCO Engineering

Instructions for Repairing Flat Glass

Tools and Materials Required

Putty Knife, Straight Screwdriver, Wire Crimpers, Wire Cutters, Silicone, Glass Cleaner, Clean Cloth

Instructions

Use Instructions For **Before 2005** Or **2005 and Newer** To Remove Old Flat Glass

(Models Before 2005) **Flat Glass Siliconed Directly To The Motor**

Step 1: Removing The Old Flat Glass (Diagrams 1)

A: Heat up putty knife and tip glass to one side. Place the warm putty knife between the glass and the motor to break the silicone seal. Be careful not to break the flat glass or the motor.

B: After removing the flat glass, clean all of the old silicone off of the outer ring of the motor making sure there is no debris.

(2005 and Newer Models) **Flat Glass With Snap Ring Assembly**

C: Remove old snap ring from mirror assembly by using a straight screw driver to unlock 3 of the 4 locking tabs from the motor.

D: If your flat glass is **heated** or has **Muth LED**, you will need to cut the heat wires/disconnect the LED connector away from the glass. *Note: For the heat, be sure to leave as much wire as possible to attach the new glass to the heat. Refer to diagram #4 to view the heat and Muth LED wires.*

Step 6: Installing New Flat Glass/Snap Ring (Diagrams 4,5,6)

B: Next, if the assembly has heat, reconnect the heat wires using 2 18-22 gage pink butt connectors and wire crimpers.

C: Place the snap ring on the motor by pressing ring firmly, locking the ring to the motor.

D: Clean the back of the new flat glass thoroughly making certain there is no debris or residue which could impede the adhesion of the snap ring to the glass. *Note: Please make sure the glass is dry before proceeding to "E".*

E: Pull protective cover from double faced tape located on the snap ring. At this time, apply a small dab of silicone to the center of the snap ring.

F: Take the flat glass and center it on top of the snap ring in the mirror head.

G: Once new flat glass is centered, rub the glass directly over the motor to ensure a good adhesion. Ramco recommends letting the tape cure to the glass for 24 hours or more before use.

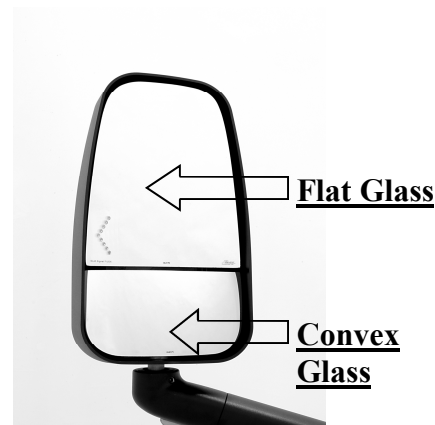
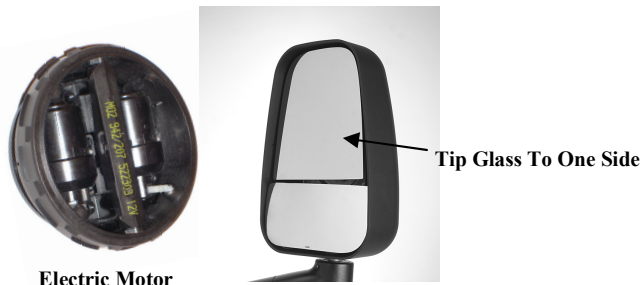

Diagram 1



Electric Motor

Diagram 2

Diagram 3

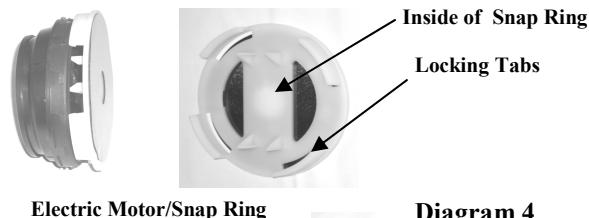

Electric Motor/Snap Ring

Diagram 4

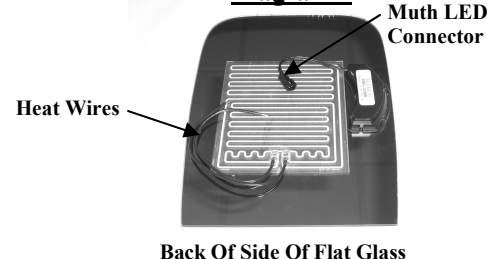

Back Of Side Of Flat Glass

Diagram 5

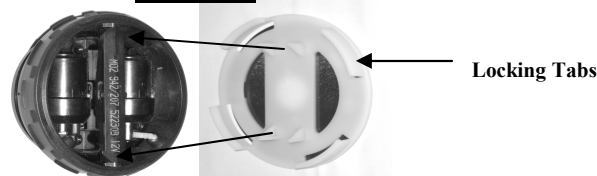

Locking Snap Ring To Motor

Diagram 6

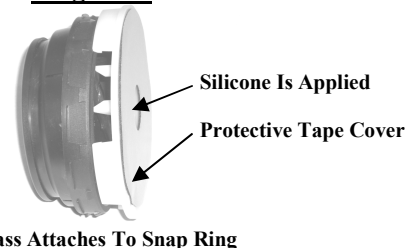

Glass Attaches To Snap Ring

For Further Assistance Please Call Customer Service at *Ramco Engineering*

Phone: (800)321-4819 or (574)266-1455 / Address: 52965 Frederic Drive, Elkhart, IN 46514