



FORETRAVEL

MOTORCOACH



FORETRAVEL

MOTORCOACH

*Forty-five Years In The Making
Two Years In Designing
Now It's Here*



*Forty-five Years In The Making
Two Years In Designing
Now It's Here*





IH-45



IH-45



IH-45 Features

Professionally Designed Coachwork
Re-engineered Travelride™ Chassis
Re-designed Dash and Driver Controls
Longer Slideroom Capability
Multi-plex Controlled Lighting
Multi-plex Chassis Electrical System
Flat Floors (Including Engine Cover)
Anti-road Noise Floor Construction





IH-45 Features

Professionally Designed Coachwork

Re-engineered Travelride™ Chassis

Re-designed Dash and Driver Controls

Longer Slideroom Capability

Multi-plex Controlled Lighting

Multi-plex Chassis Electrical System

Flat Floors (Including Engine Cover)

Anti-road Noise Floor Construction













IH-45 Specifications

Overall Height (to top of AC) 15' 2"

Interior Height 7' 5"

Storage Height 2' 6 1/2"

Entry Width 2' 8"

Front Slideroom Height 6' 6"

GVWR 52,000 lbs

Wet Weight ±48,000 lbs

Hitch Towing Capacity 18,000 lbs

Hitch Tongue Capacity 2,700 lbs





IH-45 Specifications

Overall Height (to top of AC) 13' 2"

Interior Height 7' 3"

Storage Height 2' 6 1/2"

Entry Width 2' 8"

Front Slideroom Height 6' 6"

GVWR 52,000 lbs

Wet Weight ±48,000 lbs

Hitch Towing Capacity 18,000 lbs

Hitch Tongue Capacity 2,700 lbs





Phoenix





Phoenix













Nimbus





Nimbus



POPULAR CUSTOM DESIGNED FLOORPLANS

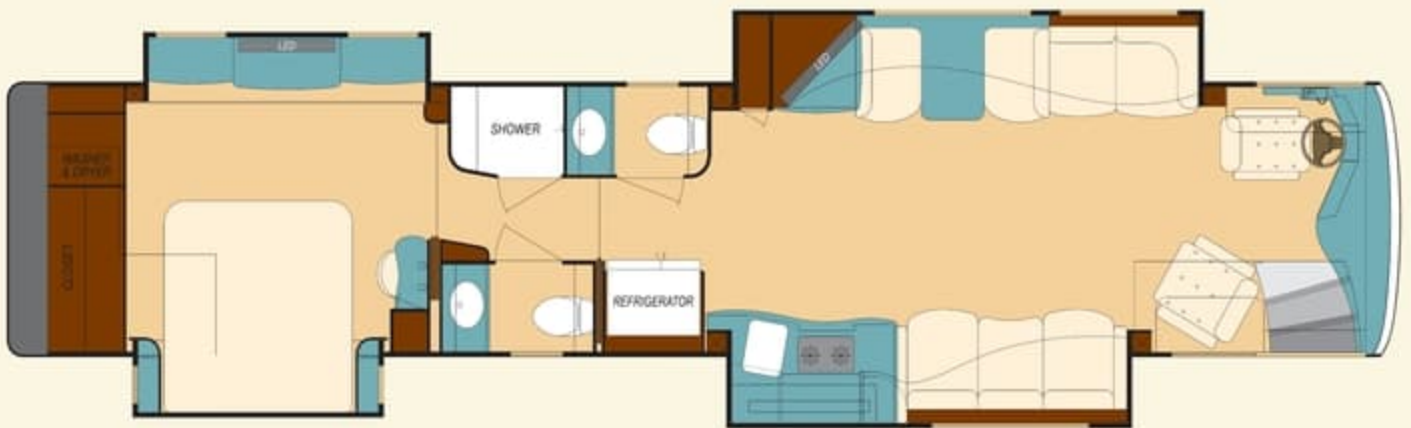
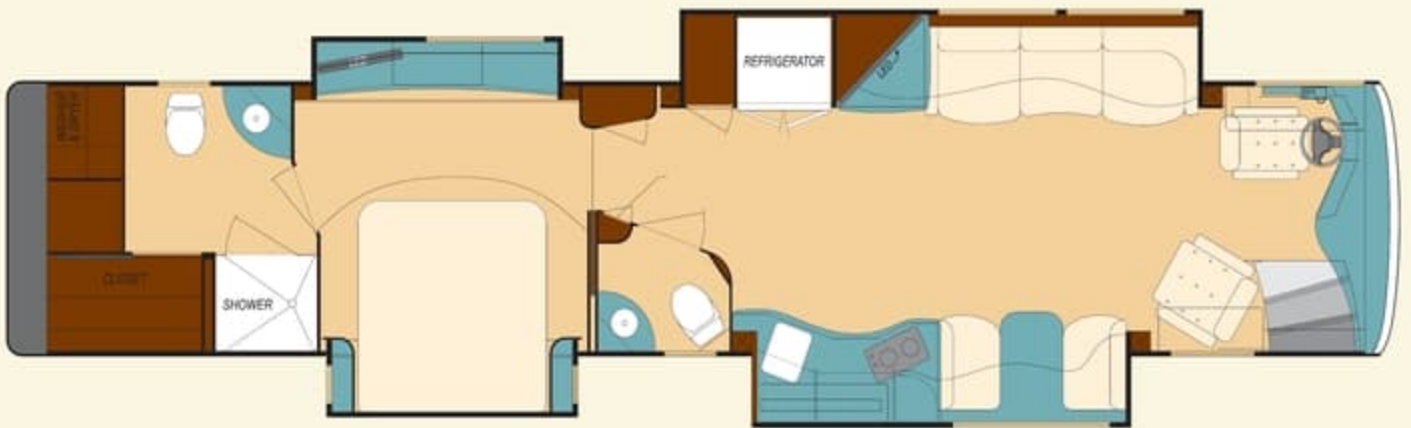

POPULAR CUSTOM DESIGNED FLOORPLANS

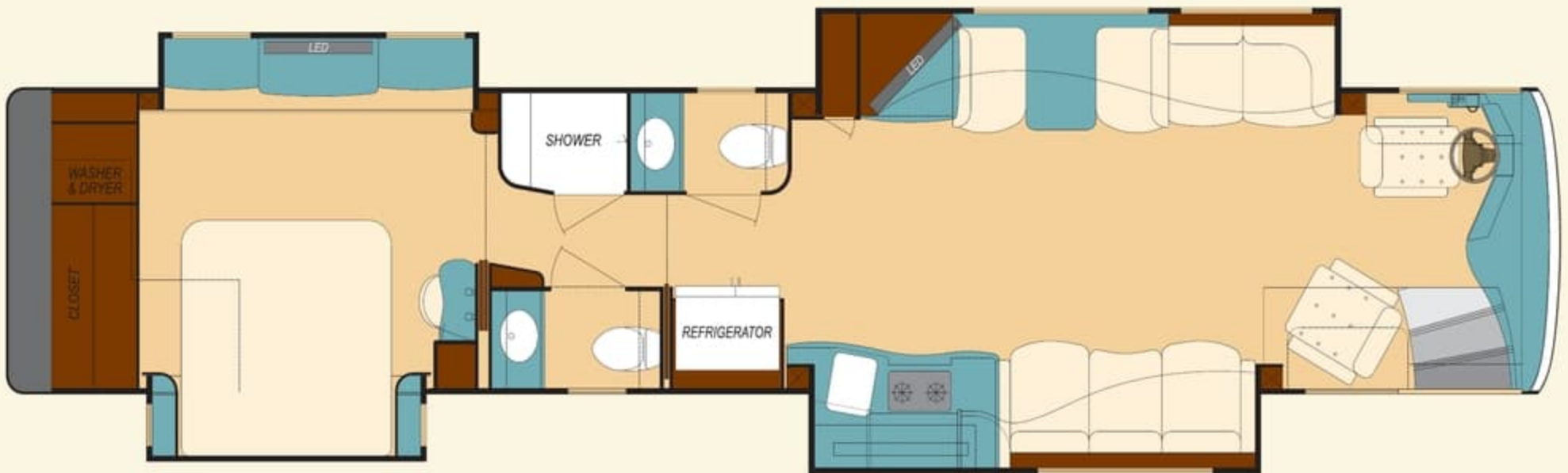
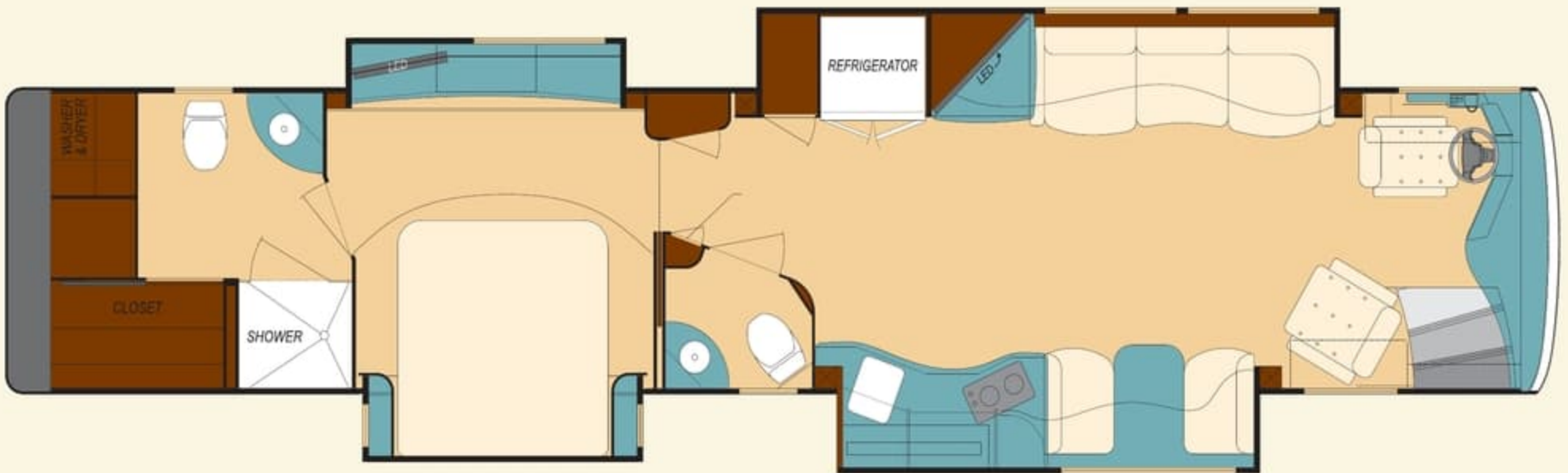

FORETRAVEL'S EXCLUSIVE TRAVELRIDE CHASSIS

IH-45

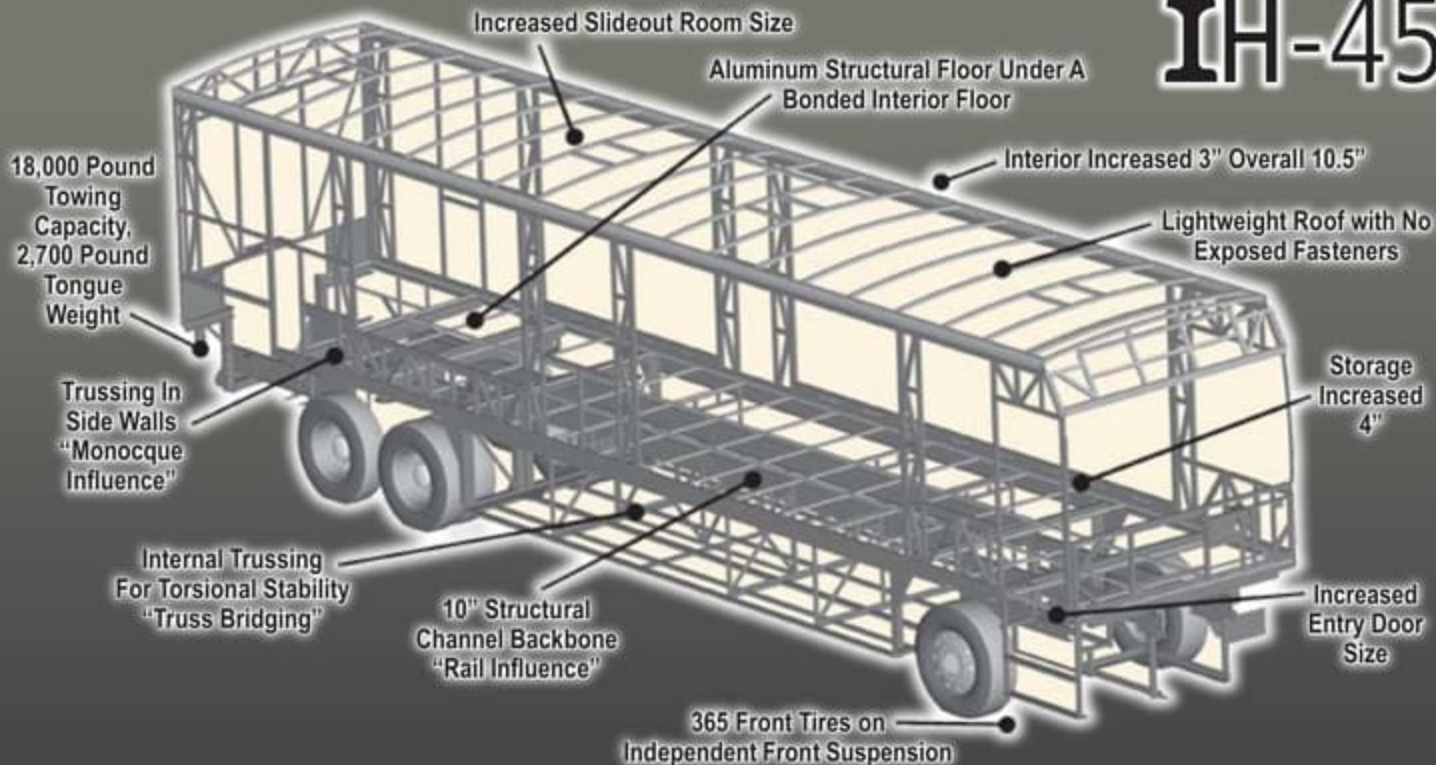

Phoenix / Nimbus 40'



**FORETRAVEL
MOTORCOACH**

FORETRAVEL'S EXCLUSIVE TRAVELRIDE CHASSIS

IH-45

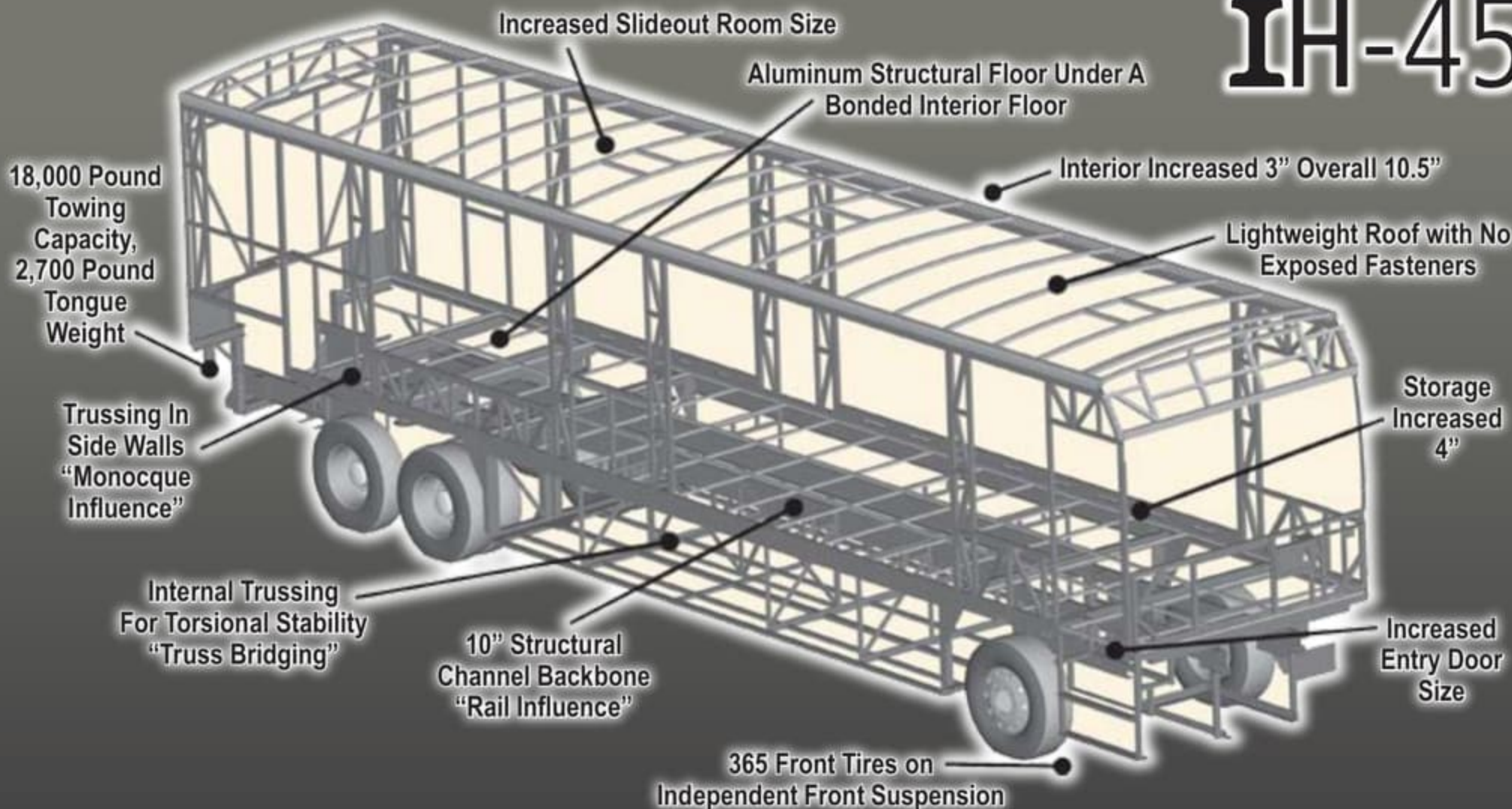

Phenix / Nimbus 40'

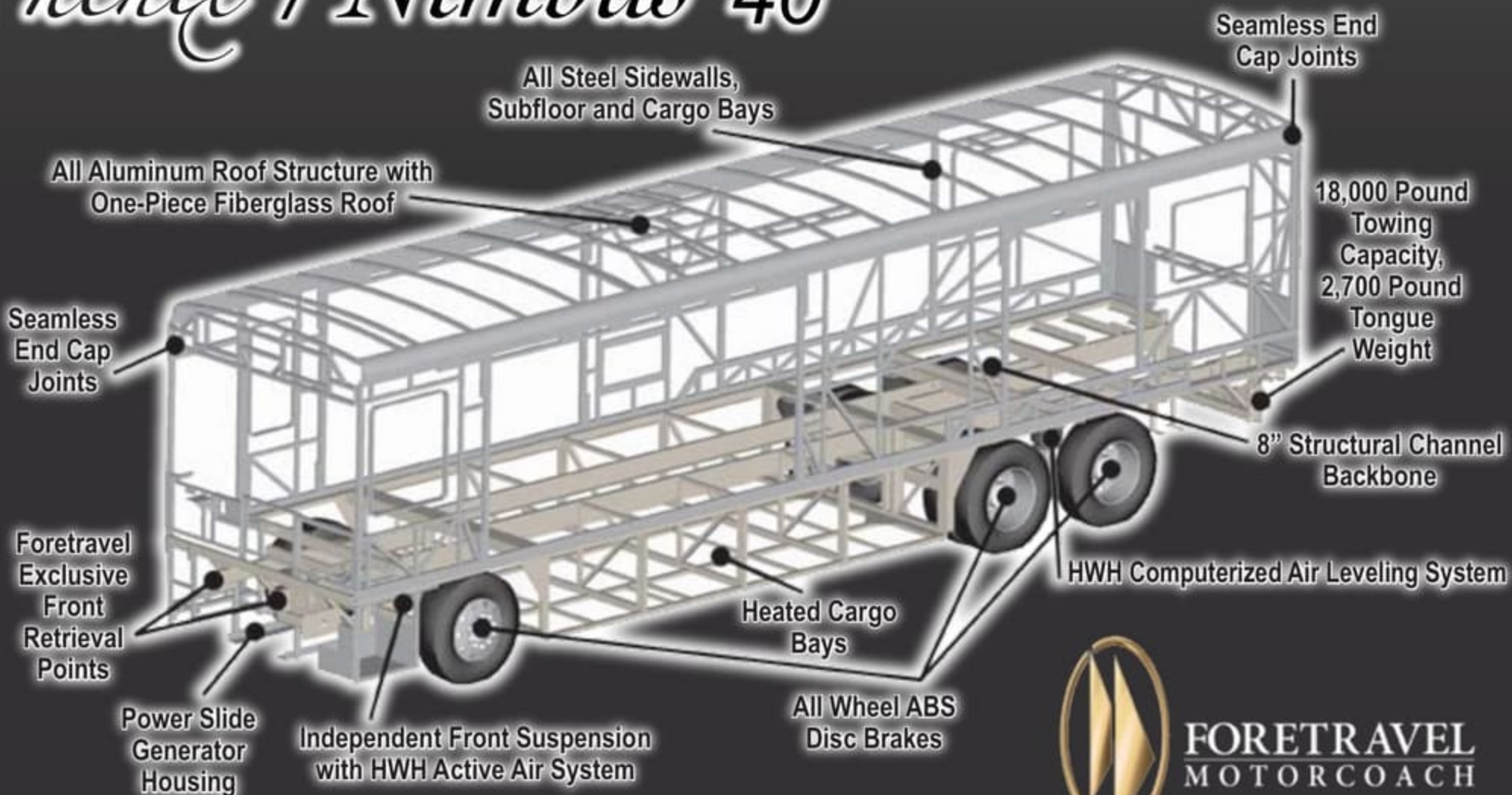

FORETRAVEL
MOTORCOACH

Chassis Features

ABS anti-lock braking system w/automatic slack adjusters	•	•	•
Air disc brakes on all wheels	•	•	•
Air hose for tire service	•	•	•
Air quick connect in storage bay	•	•	•
Alcoa aluminum wheels w/ Dura-Bright protection	•	•	•
Allison 6 speed transmission MH 3000R			• (30-30)
Allison 6 speed transmission MH 4000R	•	•	• (40-40-40)
Allison transmission retarder	•	•	•
Alternator - 160-amp			• (30-30)
Alternator - 200-amp			• (40-40-40)
Alternator - 320-amp	•	•	
Automatic traction control (ATC)	•	•	•
Auxiliary 12v air compressor	•	•	•
Chassis - TravelRide by Foretravel	•	•	•
all air ride with:			
4 outboard-mounted air bags (drive axle)	•	•	•
2 air bags (IFS front axle)	•	•	•
2 air bags (lifting tag axle)	•	•	•
Engine - Cummins ISL 425 HP			•
Engine - Cummins ISX 500 HP			•
Engine - Cummins ISX 600 HP, - 650 HP	•	•	
Fuel filter/water separator	•	•	•
Fuel system w/air & water purge	•	•	•
Front axle - straight beam			★
Front axle - IFS (independent front suspension)	•	•	•
Front tow retrieval points	•	•	•
HWH - computerized air leveling system	•	•	•
HWH - active air system	•	★	★
Rear axle ratio: 4.30:1	•	•	•
Rear axle ratio: 4.78:1			• (30-30)
Receiver hitch - 18,000 lb. rated	•	•	•
Remote battery jumper terminals	•	•	•
Tag axle, lifting	•	•	• (40-40-40)
Michelin Tires: 295/80R22.5			•
Michelin Tires: 315/80R22.5			•
Michelin Tires: 365/70R22.5 Front 315/80R22.5 Rear	•		

Exterior Features

Awning, Girard - electric door	★	★	★
Awning, Girard roof-mounted, electric patio	2	2	1
Awning, Girard shells	•	•	•
Awnings, Girard electric window	★	★	★
Awnings, Zip Dee manual window	★	★	★
Cargo tray, sliding	2	2	1
Carpeted storage bays	•	•	•
Consolidated components bay	•	•	•
Docking lights, (4) with switch in dash & bedroom	•	•	•
Dual halogen headlamps	•	•	•
Dual-pane tinted & insulated windows	•	•	•
Easy view one-piece windshield	•	•	•
Electric dump valves	•	•	•
Electric entry step			•
Electric entry step (Executive)	•	•	
Electric utility reels - water & power	•	•	•
Fiberglass roof & sub floor (one-piece)	•	•	•
Flush kit	•	•	•
Fog lights	•	•	•
Freezer, 100lb in storage bay	★	★	★
Fuel fill - on both sides of coach	•	•	•
Gray water bypass for holding tank	•	•	•
Heated/remote triple head chrome mirrors w/LED turn signals	•	•	•
Lighted entry door w/ assist handle, keypad & doorbell	•	•	•
LP connection	★	★	•
Fresh water plumbing supply manifold	•	•	•
Marker lights, LED	•	•	•

• Standard ★ Options



	IH	Phenix	Nimbus
Chassis Features			
ABS anti-lock braking system w/automatic slack adjusters	•	•	•
Air disc brakes on all wheels	•	•	•
Air hose for tire service	•	•	•
Air quick connect in storage bay	•	•	•
Alcoa aluminum wheels w/ Dura-Bright protection	•	•	•
Allison 6 speed transmission MH 3000R			• (36-38)
Allison 6 speed transmission MH 4000R	•	•	• (40-42-45)
Allison transmission retarder	•	•	•
Alternator - 160-amp			• (36-38)
Alternator - 200-amp			• (40-42-45)
Alternator - 320-amp	•	•	
Automatic traction control (ATC)	•	•	•
Auxiliary 12v air compressor	•	•	•
Chassis - TravelRide by Foretravel	•	•	•
all air ride with:			
4 outboard-mounted air bags (drive axle)	•	•	•
2 air bags (IFS front axle)	•	•	•
2 air bags (lifting tag axle)	•	•	•
Engine - Cummins ISL 425 HP			•
Engine - Cummins ISX 500 HP			•
Engine - Cummins ISX 600 HP, - 650 HP	•	•	
Fuel filter/water separator	•	•	•
Fuel system w/air & water purge	•	•	•
Front axle - straight beam			★
Front axle - IFS (independent front suspension)	•	•	•
Front tow retrieval points	•	•	•
HWH - computerized air leveling system	•	•	•
HWH - active air system	•	★	★
Rear axle ratio: 4.30:1	•	•	•
Rear axle ratio: 4.78:1			• (36-38)
Receiver hitch - 18,000 lb. rated	•	•	•
Remote battery jumper terminals	•	•	•
Tag axle, lifting	•	•	• (40-42-45)
Michelin Tires: 295/80R22.5			•
Michelin Tires: 315/80R22.5		•	
Michelin Tires: 365/70R22.5 Front 315/80R22.5 Rear	•		

Exterior Features			
Awning, Girard - electric door	★	★	★
Awning, Girard roof-mounted, electric patio	2	2	1
Awning, Girard shells	•	•	★
Awnings, Girard electric window	★	★	★
Awnings, Zip Dee manual window	★	★	★
Cargo tray, sliding	2	2	1
Carpeted storage bays	•	•	•
Consolidated components bay	•	•	•
Docking lights, (4) with switch in dash & bedroom	•	•	•
Dual halogen headlamps	•	•	•
Dual-pane tinted & insulated windows	•	•	•
Easy view one-piece windshield	•	•	•
Electric dump valves	•	•	•
Electric entry step			•
Electric entry step (Executive)	•	•	
Electric utility reels - water & power	•	•	•
Fiberglass roof & sub floor (one-piece)	•	•	•
Flush kit	•	•	•
Fog lights	•	•	•
Freezer, 100lb in storage bay	★	★	★
Fuel fill - on both sides of coach	•	•	•
Gray water bypass for holding tank	•	•	•
Heated/remote triple head chrome mirrors w/LED turn signals	•	•	•
Lighted entry door w/ assist handle, keypad & doorbell	•	•	•
LP connection	★	★	•
Fresh water plumbing supply manifold	•	•	•
Marker lights, LED	•	•	•

• Standard ★ Options



	IH	Phenix	Nimbus
Paint protection below windshield	•	•	•
Painted exterior, full body paint w/ clear coat finish	•	•	•
Parallel storage doors	•	•	•
Porch light	•	•	•
Remote storage door locks	•	•	•
Roof AC drains	•	•	•
Stainless steel lined utility bay	•	•	•
Storage bay lights	•	•	•
Trailer wiring	•	•	•
TV antenna - electric with booster	•	•	•
TV outlet and 12v outlet in storage bay	•	•	•
Utility Station:			
Fresh water connection, phone connection, water fill switch, hot & cold water faucet, 120v receptacle & soap dispenser	•	•	•
50 amp shoreline connection, water pump switch, cable TV	•	•	•
Xenon low beam headlights	•	•	★



Dash & Cockpit Features

12 volt accessory receptacle	•	•	•
Battery boost switch	•	•	•
Camera, motorized back-up with control at dash	•	•	•
Cameras, mirror mount w/ color back-up monitor	•	•	•
CB at dash, hand held	•	•	•
Compass & outdoor temperature	•	•	•
Co-pilot seat, Villa leather 6 way power w/ footrest	•	•	•
Co-pilot seat, Villa residential 6 way power w/footrest & headrest	•	•	•
Dash AC controls for co-pilot	•	•	•
Gauges, backlit analogue	•	•	•
Generator auto start/stop	•	•	•
GPS/AM/FM/CD in dash (w/ xm sat. radio)	•	•	•
Monitor, passenger satellite/GPS	•	•	★
Map lights, pilot & copilot	•	•	•
MP3 input at dash	•	•	•
Pedals, throttle & brake power adjust	•	•	•
Pilot seat, Villa leather 6-way power	•	•	•
Pilot seat, Knuedler air ride	•	★	★
Silverleaf digital glass dash	•	★	★
Silverleaf VMS 440 (eng./trans. monitor)	•	•	★
Steering wheel, power tilt & telescoping	•	•	•
Steering wheel, wood grain Smart Wheel	•	•	•
Transmission gear selector, touch-pad	•	•	•
Windshield / privacy shade & sunblock, electric	•	•	•



Appliances • Electronics

Lighting • Audio-Video

Alarm Clock, built in bedroom	•	•	•
Battery charger, solar	★	★	★
Component audio & digital video cables	•	•	•
Cook top, 2-burner electric	•	•	★
Cook top, 2-burner LP w/electronic ignition (recessed)	★	★	•
Home theater speaker system in LR	•	•	•
DVD - Blue-ray™ - high def	•	•	★
DVD Player	•	•	•
Interior LED Lighting	•	★	★
Inverter/power monitor panel in living room area	•	•	•
LED Lighting, accent under counters & window trim	•	•	★
Lighting, floor lights	•	•	•
Lighting, Halogen reading lamps in bedroom	•	•	•
Microwave	•	•	•
Refrigerator, 120v electric w/ice & water in door	•	•	★
Refrigerator, Dometic side-by-side 12 cu. ft	★ (14cu ft.)	★ (14cu ft.)	•
Satellite radio, XM, SIRIUS	★	★	★
Satellite system, in motion w/HD receiver	•	•	•
Satellite system, in motion w/ HD DVR receiver	•	•	★
Satellite system, 2nd HD receiver	•	•	★

• Standard ★ Options



	IH	Phenix	Nimbus
Paint protection below windshield	•	•	•
Painted exterior, full body paint w/ clear coat finish	•	•	•
Parallel storage doors	•	•	•
Porch light	•	•	•
Remote storage door locks	•	•	•
Roof AC drains	•	•	•
Stainless steel lined utility bay	•	•	•
Storage bay lights	•	•	•
Trailer wiring	•	•	•
TV antenna - electric with booster	•	•	•
TV outlet and 12v outlet in storage bay	•	•	•
Utility Station:			
Fresh water connection, phone connection, water fill switch, hot & cold water faucet, 120v receptacle & soap dispenser	•	•	•
50 amp shoreline connection, water pump switch, cable TV	•	•	•
Xenon low beam headlights	•	•	★



Dash & Cockpit Features

12 volt accessory receptacle	•	•	•
Battery boost switch	•	•	•
Camera, motorized back-up with control at dash	•	•	•
Cameras, mirror mount w/ color back-up monitor	•	•	•
CB at dash, hand held	•	•	•
Compass & outdoor temperature	•	•	•
Co-pilot seat, Villa leather 6 way power w/ footrest	•	•	•
Co-pilot seat, Villa residential 6 way power w/footrest & headrest	•	•	•
Dash AC controls for co-pilot	•	•	•
Gauges, backlit analogue	•	•	•
Generator auto start/stop	•	•	•
GPS/AM/FM/CD in dash (w/ xm sat. radio)	•	•	•
Monitor, passenger satellite/GPS	•	•	★
Map lights, pilot & copilot	•	•	•
MP3 input at dash	•	•	•
Pedals, throttle & brake power adjust	•	•	•
Pilot seat, Villa leather 6-way power	•	•	•
Pilot seat, Knoedler air ride	•	★	★
Silverleaf digital glass dash	•	★	★
Silverleaf VMS 440 (eng./trans. monitor)	•	•	★
Steering wheel, power tilt & telescoping	•	•	•
Steering wheel, wood grain Smart Wheel	•	•	•
Transmission gear selector, touch-pad	•	•	•
Windshield / privacy shade & sunblock, electric	•	•	•

Appliances • Electronics

Lighting • Audio-Video

Alarm Clock, built in bedroom	•	•	•
Battery charger, solar	★	★	★
Component audio & digital video cables	•	•	•
Cook top, 2-burner electric	•	•	★
Cook top, 2-burner LP w/electronic ignition (recessed)	★	★	•
Home theater speaker system in LR	•	•	•
DVD - Blue-ray™ - high def	•	•	★
DVD Player	•	•	•
Interior LED Lighting	•	★	★
Inverter/power monitor panel in living room area	•	•	•
LED Lighting, accent under counters & window trim	•	•	★
Lighting, floor lights	•	•	•
Lighting, Halogen reading lamps in bedroom	•	•	•
Microwave	•	•	•
Refrigerator, 120v electric w/ice & water in door	•	•	★
Refrigerator, Dometic side-by-side 12 cu. ft	★ (14cu ft.)	★ (14cu ft.)	•
Satellite radio, XM, SIRIUS	★	★	★
Satellite system, in motion w/HD receiver	•	•	•
Satellite system, in motion w/ HD DVR receiver	•	•	★
Satellite system, 2nd HD receiver	•	•	★

• Standard ★ Options



	IH	Phenix	Nimbus
Patio Entertainment Center	★	★	★
Stationary Satellite w/ HD receiver	★	★	★
Siverleaf Total Coach monitor	•	•	•
Tire Pressure Sensors, Remote	•	•	•
TV antenna - electric with booster	•	•	•
Washer/dryer connections	•	•	•

Interior Livability Features

Powered step-well cover with two switch locations	•	•	•
China toilet	•	•	•
Color-coordinated throw pillows (sofa & bed)	•	•	•
Designer window treatment w/ electric day/night shades	•	•	•
Electric exhaust fan in bath & toilet room w/auto rain sensor	•	•	•
Filter, drinking water & ice maker water	•	•	•
Floor Heat, electric (with approved flooring)	•	★	★
Kitchen pantry	•	•	•
Lighting, multiplex system with dimmers	•	•	•
Queen bed (60" x 77") (66" x 77" floorplan dependent)	•	•	•
King bed (72" x 77") ^(w/ -) Slumber Ease System	★	★	★
Slide-out rooms, flush w/ sidewalls when retracted	•	•	•
Slide-out rooms, pneumatic sealed	•	•	•
Natural Quartz countertops (kitchen & bath)	•	•	•
Natural Quartz desktop (floorplan dependent)	•	•	•
Natural Quartz dinette table	•	•	•
Natural Quartz nightstand tops	•	•	•
Stainless steel kitchen sink w/covers	•	•	•
Telephone jack in living area & bedroom	•	•	•
Tile floor (LR,kit, bath, D & P area)	•	•	• (H-42)
Vacuum, built in	•	•	•
Washer dryer combination	★	★	★
Washer dryer, stacked	★ (FD)	★ (FD)	★ (FD)
Wood, handcrafted cherry, walnut or maple cabinetry	•	•	•
Wood, Bubinga	★	★	•
Wood, African Mahogany	★	★	★

Safety Features

All coaches built to RVIA specifications	•	•	•
Carbon monoxide detector	•	•	•
Daytime running lights	•	•	•
Fire extinguishers (2)	•	•	•
GFI protected circuits	•	•	•
High-mounted additional brake lights	•	•	•
Lighted entry-door assist handle	•	•	•
LP leak detector	• (w/ LP)	• (w/ LP)	•
Electronic Safe	•	•	•
Security system	•	•	•
Smoke detector	•	•	•

Heating • Cooling • Electrical

10kw diesel generator in quiet box			• (D6-36)
12.5kw diesel generator in quiet box			• (H-42)
12 volt battery disconnect	•	•	•
2800 w inverter/charger			•
Onan Hybrid 12/18 Gen	•	•	★
50 amp shoreline connection	•	•	•
Air conditioning & heating with hidden returns	•	•	•
Air conditioning, ducted with 2 roof airs			• (D6-36)
Air conditioning, ducted with 3 roof airs	• (H-42)	• (H-42)	• (H-42)
Air-conditioning, ducted with 4 roof airs	• (H)	• (H)	• (H)
Auto temp.start for generator	•	•	•
Electrical surge-suppression system	•	•	•
Heat pumps on roof AC's	•	•	•
Hydronic heating	•	•	•
Low-battery generator auto-start	•	•	•

• Standard ★ Options



	IH	Phenix	Nimbus
Patio Entertainment Center	★	★	★
Stationary Satellite w/ HD receiver	★	★	★
Silverleaf Total Coach monitor	•	•	•
Tire Pressure Sensors, Remote	•	•	•
TV antenna - electric with booster	•	•	•
Washer/dryer connections	•	•	•

Interior Livability Features

Powered step-well cover with two switch locations	•	•	•
China toilet	•	•	•
Color-coordinated throw pillows (sofa & bed)	•	•	•
Designer window treatment w/ electric day/night shades	•	•	•
Electric exhaust fan in bath & toilet room w/auto rain sensor	•	•	•
Filter, drinking water & ice maker water	•	•	•
Floor Heat, electric (with approved flooring)	•	★	★
Kitchen pantry	•	•	•
Lighting, multiplex system with dimmers	•	•	•
Queen bed (60" x 77") (66" x 77" floorplan dependent)	•	•	•
King bed (72" x 77") (w/ w/o) Slumber Ease System	★	★	★
Slide-out rooms, flush w/ sidewalls when retracted	•	•	•
Slide-out rooms, pneumatic sealed	•	•	•
Natural Quartz countertops (kitchen & bath)	•	•	•
Natural Quartz desktop (floorplan dependent)	•	•	•
Natural Quartz dinette table	•	•	•
Natural Quartz nightstand tops	•	•	•
Stainless steel kitchen sink w/covers	•	•	•
Telephone jack in living area & bedroom	•	•	•
Tile floor (LR,kit, bath, D & P area)	•	•	• (40-42)
Vacuum, built in	•	•	•
Washer dryer combination	★	★	★
Washer dryer, stacked	★ (FD)	★ (FD)	★ (FD)
Wood, handcrafted cherry, walnut or maple cabinetry	•	•	•
Wood, Bubinga	★	★	•
Wood, African Mahogany	★	★	★

Safety Features

All coaches built to RVIA specifications	•	•	•
Carbon monoxide detector	•	•	•
Daytime running lights	•	•	•
Fire extinguishers (2)	•	•	•
GFI protected circuits	•	•	•
High-mounted additional brake lights	•	•	•
Lighted entry-door assist handle	•	•	•
LP leak detector	• (w/ LP)	• (w/ LP)	•
Electronic Safe	•	•	•
Security system	•	•	•
Smoke detector	•	•	•

Heating • Cooling • Electrical

10kw diesel generator in quiet box	•	•	• (36-38)
12.5kw diesel generator in quiet box	•	•	• (40-42)
12 volt battery disconnect	•	•	•
2800 w inverter/charger	•	•	•
Onan Hybrid 12/18 Gen	•	•	★
50 amp shoreline connection	•	•	•
Air conditioning & heating with hidden returns	•	•	•
Air conditioning, ducted with 2 roof airs	•	•	• (36-38)
Air conditioning, ducted with 3 roof airs	• (40-42)	• (40-42)	• (40-42)
Air-conditioning, ducted with 4 roof airs	• (45)	• (45)	• (45)
Auto temp.start for generator	•	•	•
Electrical surge-suppression system	•	•	•
Heat pumps on roof AC's	•	•	•
Hydronic heating	•	•	•
Low-battery generator auto-start	•	•	•

• Standard ★ Options





Capacities and Measurements • Warranty

Capacities and Measurements	IH	Phenix	Nimbus
Available Lengths	40,42,45	40,42,45	34,36,38, 40 wo/ tag 40,42,45 w/ tag
Exterior Height (to top of AC)	13'2"	12'3"	12'3"
Exterior Width	102"	102"	102"
Fresh Water Capacity	135 gal	135 gal	135 gal - 95 wo/ tag
Holding Tank(s)	145 gal	145 gal	145 gal
LP Capacity			17 gal
Fuel Capacity	200 gal	200 gal	150(120 gal wo/ tag)

Warranty	IH	Phenix	Nimbus
Coach	24 / 24000	18 / 24000	15 / 21000
Structure	5yr / 100000 mi	5yr / 100000 mi	5yr / 100000 mi
Engine	5yr / 100000 mi	5yr / 100000 mi	5yr / 100000 mi
Transmission w/Trans Syn TEX-295	5yr / 200000 mi	5yr / 200000 mi	5yr / 200000 mi

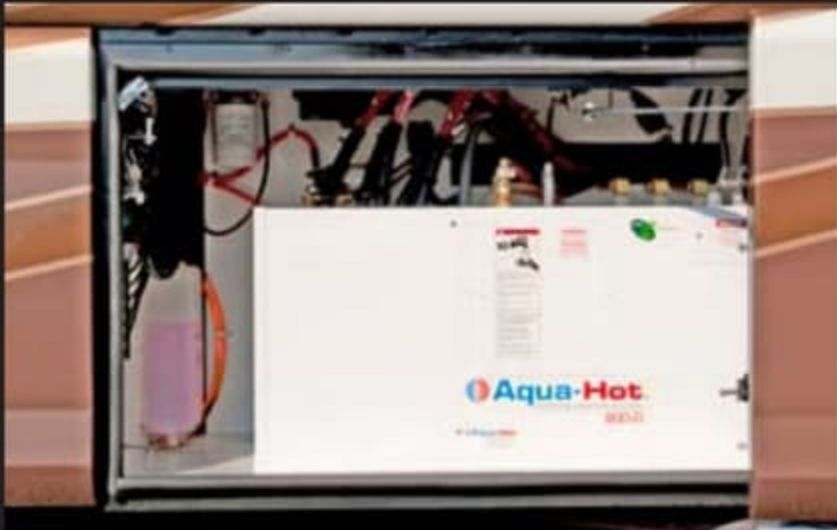

Capacities and Measurements • Warranty

Capacities and Measurements	IH	Phenix	Nimbus
Available Lengths	40,42,45	40,42,45	34,36,38, 40 wo/ tag 40,42,45 w/ tag
Exterior Height (to top of AC)	13'2"	12'3"	12'3"
Exterior Width	102"	102"	102"
Fresh Water Capacity	135 gal	135 gal	135 gal - 95 wo/ tag
Holding Tank(s)	145 gal	145 gal	145 gal
LP Capacity			17 gal
Fuel Capacity	200 gal	200 gal	150(120 gal wo/ tag)

Warranty	IH	Phenix	Nimbus
Coach	24 / 24000	18 / 24000	15 / 21000
Structure	5yr / 100000 mi	5yr / 100000 mi	5yr / 100000 mi
Engine	5yr / 100000 mi	5yr / 100000 mi	5yr / 100000 mi
Transmission w/Trans Syn TEX-295	5yr / 200000 mi	5yr / 200000 mi	5yr / 200000 mi

Special Needs Coach



Hospitality Coach



Mobile Command Center



Special Needs Coach



Hospitality Coach



Mobile Command Center



What began as a high school project for his son motivated C. M. Fore to create a business in 1967, evolved into a premier manufacturer of motorhomes based in Nacogdoches, Texas. Mr. Fore embarked on a personal mission to bring innovation, quality, specialization and customization to a budding recreational vehicle market. His ideas for innovation included letting individuals take the comforts of their home with them as they traveled, designing and building his own unique chassis, and introducing the revolutionary diesel pusher.

Foretravel has long provided unsurpassed ride & handling and unexcelled fit & finish. The ride and handling begins with its own engineered Travelride™ chassis and ends with the fit & finish of its handcrafted natural wood cabinetry and mastercrafted exterior paint and graphics. Mr. Fore's vision of creating a culture of innovation has served Foretravel since 1967. That same innovation can also be found throughout the motorcoach, including the electrical systems, air-bladder sealed slide-rooms, and parallel storage doors. And, the same emphasis on quality has long applied to durability, longevity and safety of its vehicles.

For more than 4 decades Foretravel has taken specialization and customization far beyond the industry standard. Our custom process often begins with a blank sheet of paper and takes final shape when the customer's ideas mesh with the experience of our design team. The signature coach of your dreams awaits you at Foretravel.

*We are
Proud
of Our Past,
Present & Future*



What began as a high school project for his son motivated C. M. Fore to create a business in 1967, evolved into a premier manufacturer of motorhomes based in Nacogdoches, Texas. Mr. Fore embarked on a personal mission to bring innovation, quality, specialization and customization to a budding recreational vehicle market. His ideas for innovation included letting individuals take the comforts of their home with them as they traveled, designing and building his own unique chassis, and introducing the revolutionary diesel pusher.

Foretravel has long provided unsurpassed ride & handling and unexcelled fit & finish. The ride and handling begins with its own engineered Travelride™ chassis and ends with the fit & finish of its handcrafted natural wood cabinetry and mastercrafted exterior paint and graphics. Mr. Fore's vision of creating a culture of innovation has served Foretravel since 1967. That same innovation can also be found throughout the motorcoach, including the electrical systems, air-bladder sealed slide-rooms, and parallel storage doors. And, the same emphasis on quality has long applied to durability, longevity and safety of its vehicles.

For more than 4 decades Foretravel has taken specialization and customization far beyond the industry standard. Our custom process often begins with a blank sheet of paper and takes final shape when the customer's ideas mesh with the experience of our design team. The signature coach of your dreams awaits you at Foretravel.

*We are
Proud
of Our Past,
Present & Future*



Custom Handcrafted Quality Since 1967

IH-45



Phoenix

Nimbus



Custom Handcrafted Quality Since 1967

IH-45



Phoenix

Nimbus

